

WEST-MEMPHIS METRO SWEEPING
QUANTITIES

Section	Route	Section	Location	Beginning Log Mile	Ending Log Mile	Description	Miles
1	40	52	Exit 275 - I-55 (EB & WB)	274.50	276.66	Main Lane & Ramp shoulders	2.16
2	40	52	I-55 - Mound City Rd. (EB & WB)	276.66	281.27	Main Lane & Ramp shoulders	4.61
3	40	52	Mound City - TN State Line (EB & WB)	281.27	284.69	Main Lane & Ramp shoulders	3.42
Total I-40, Sec. 52							10.19
4	55	11	TN State Line - I-40 (NB & SB)	0.00	4.65	Main Lane & Ramp shoulders	4.65
5	55	11	I-40 - Hwy. 64 (NB & SB)	6.87	10.67	Main Lane & Ramp shoulders	3.80
Total I-55, Sec. 11							8.45
6	118	4	I-40 Overpass	3.15	3.52	Main Lane & Ramp shoulders	0.37
Total Hwy. 118, Sec. 4							0.37
Total							19.01

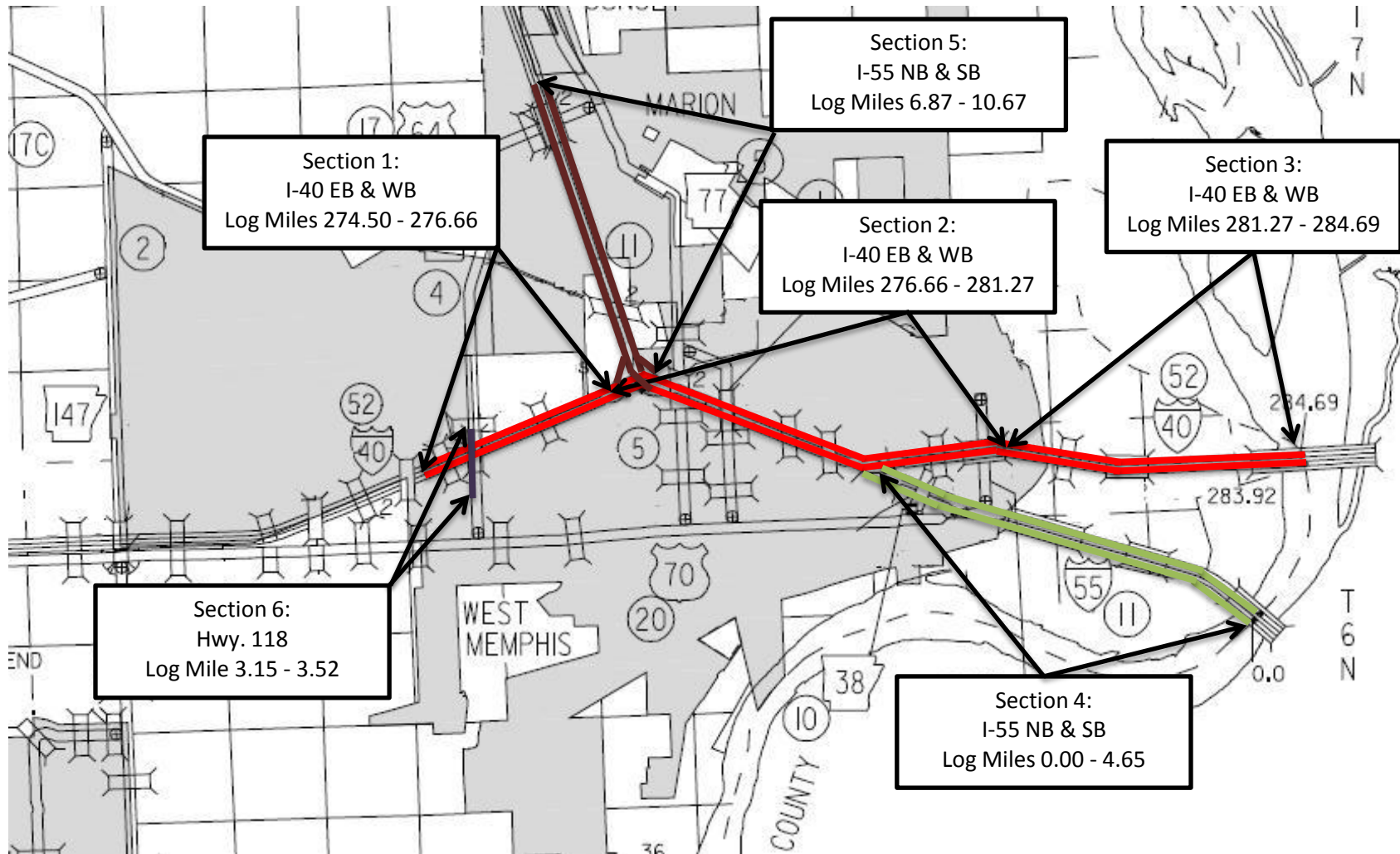

WEST - MEMPHIS METRO SWEEPING
LOCATION MAP

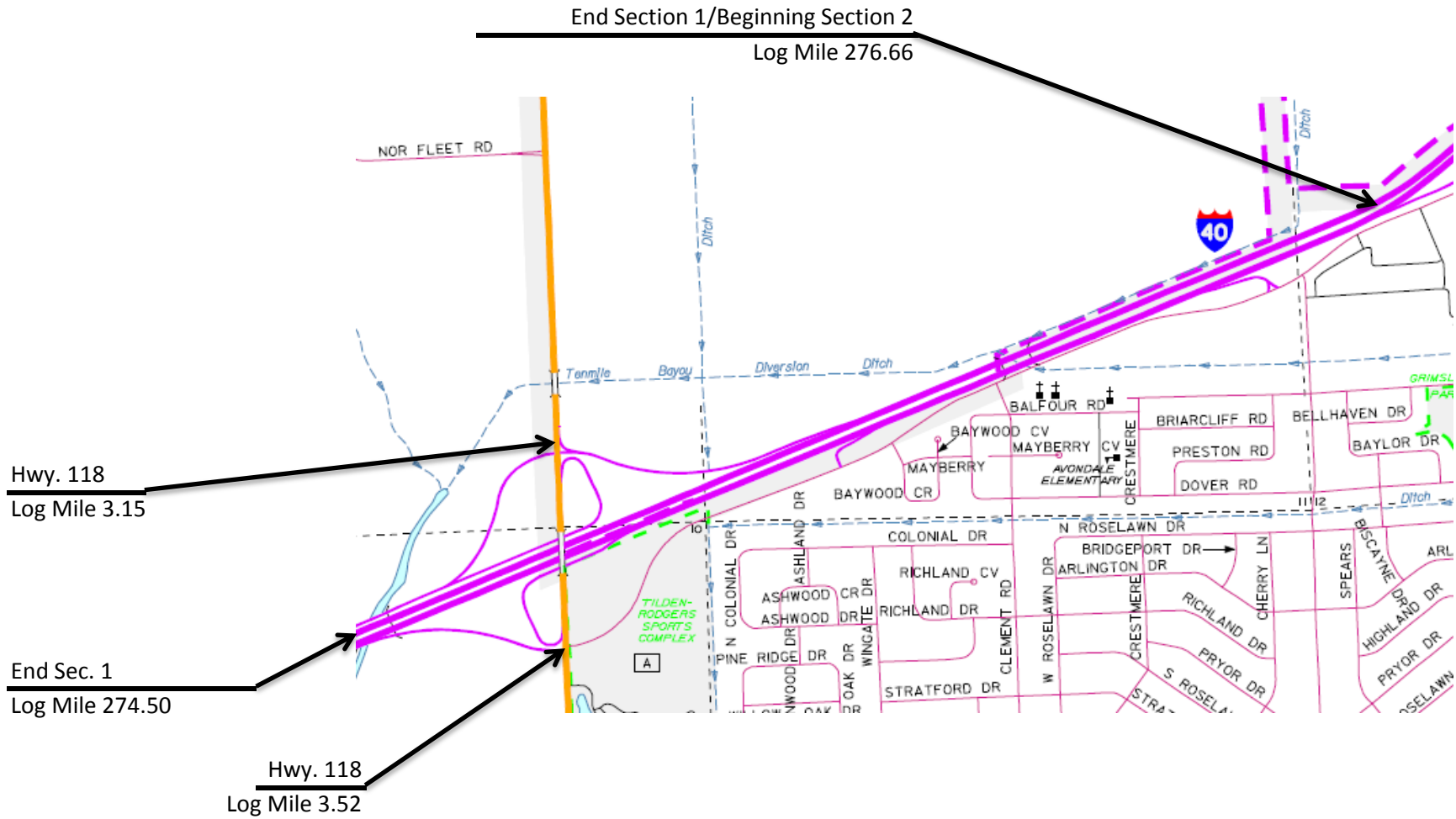

WEST - MEMPHIS METRO SWEEPING
 WESTERN I-40/ HWY. 118 INTERCHANGE

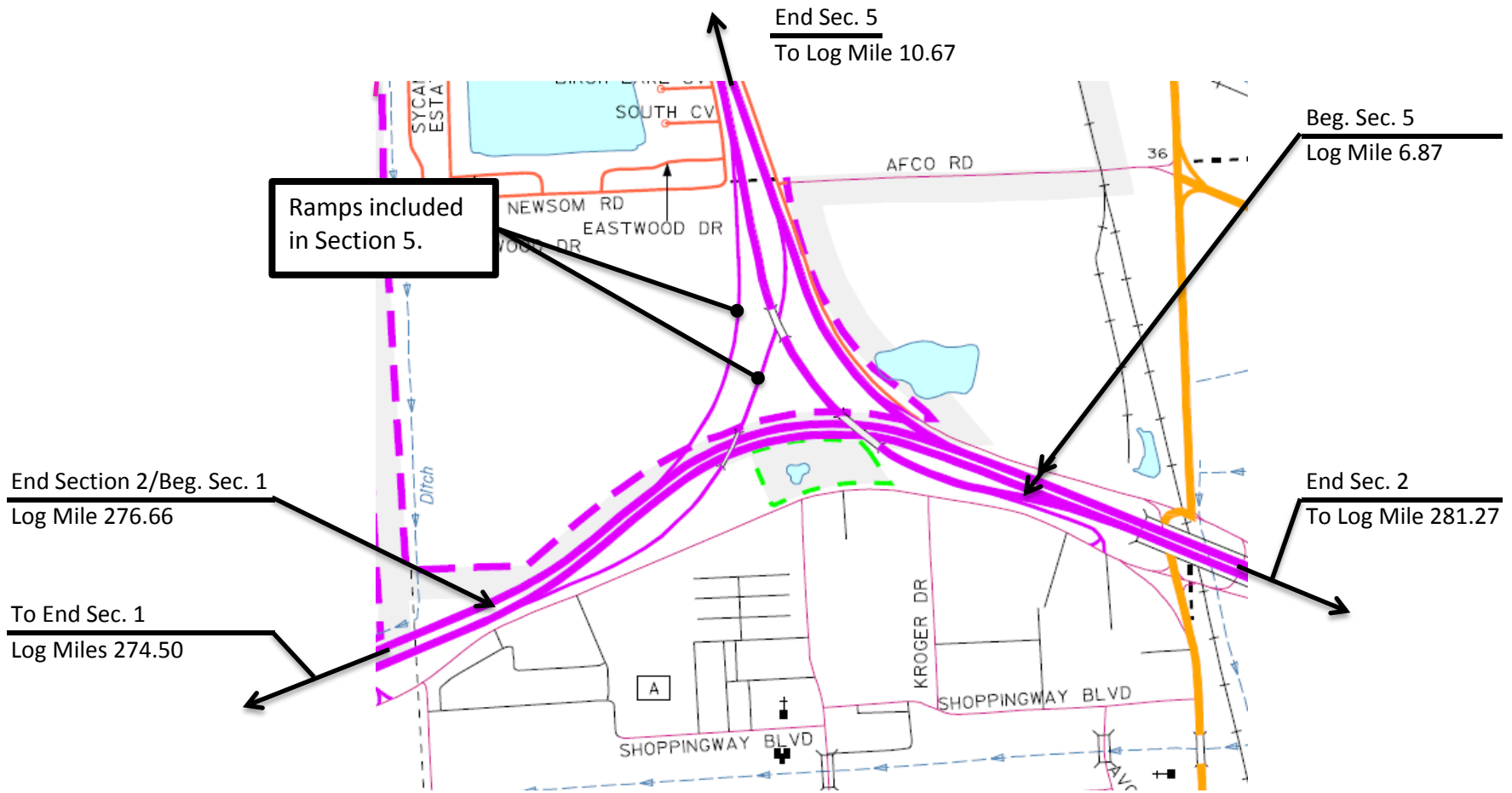

WEST - MEMPHIS METRO SWEEPING
 WESTERN I-40/I-55 INTERCHANGE

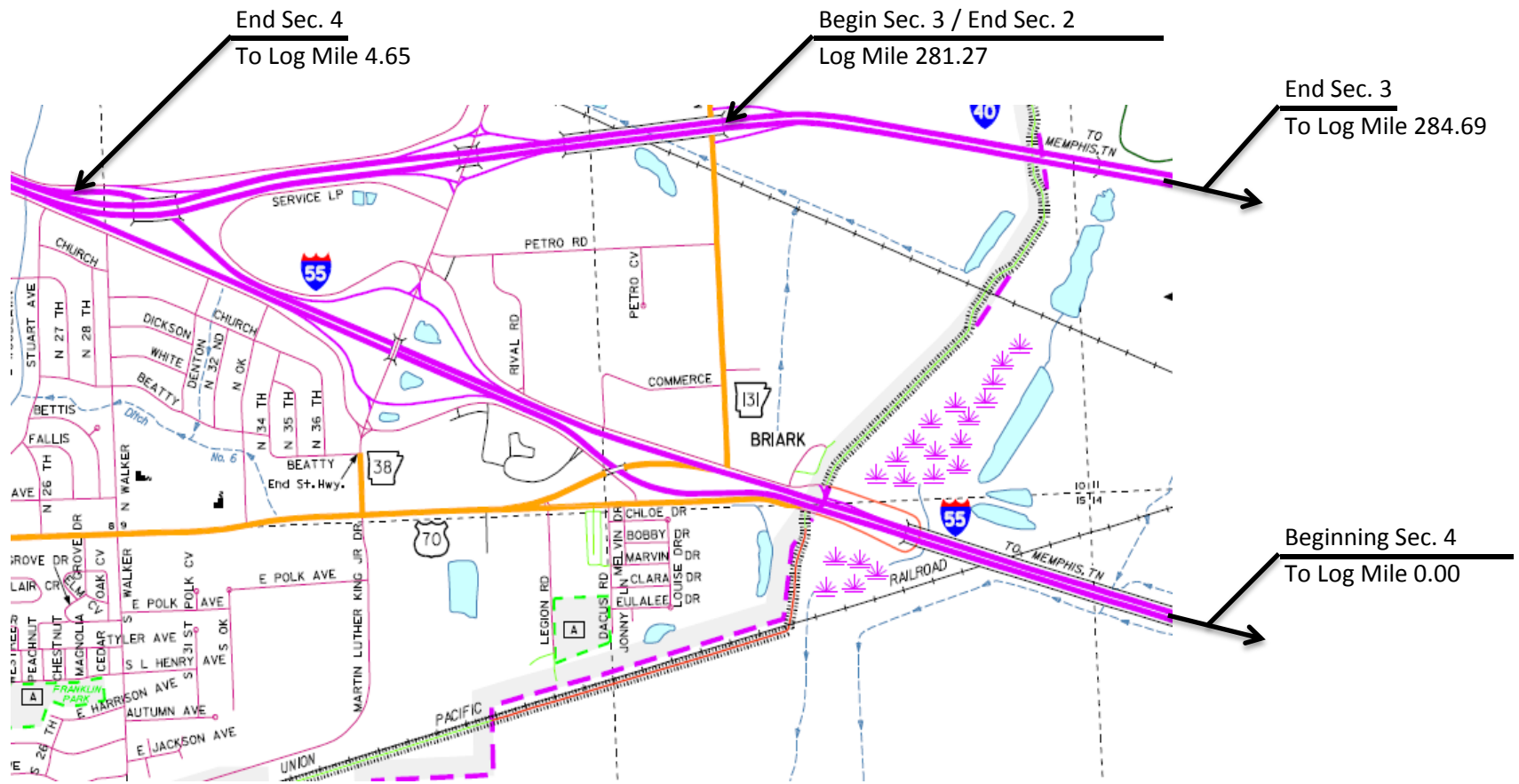

WEST - MEMPHIS METRO SWEEPING
 EASTERN I-40/I-55 INTERCHANGE

End Sec. 5
Log Mile 10.67

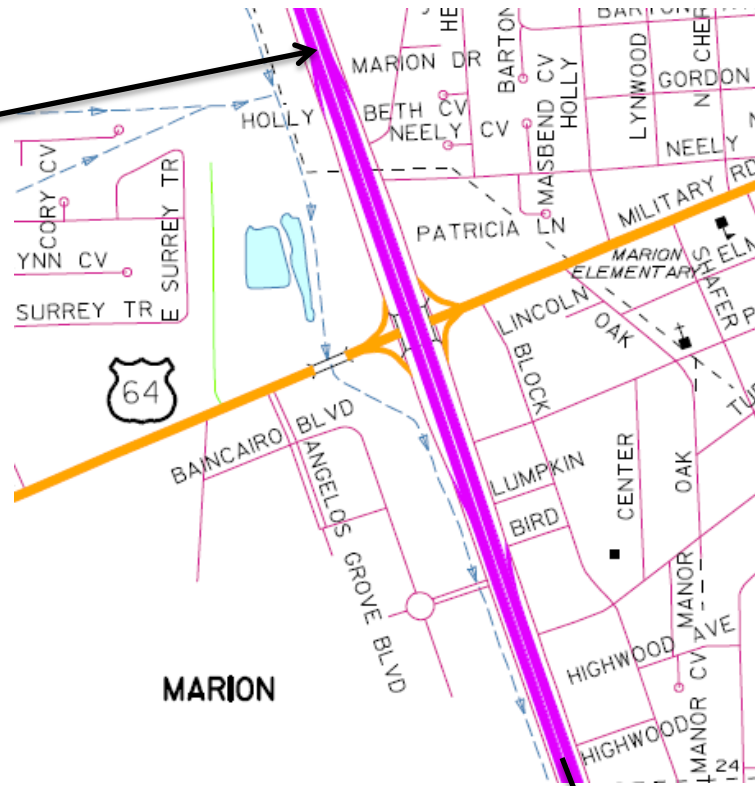

Beginning Section 5
To Log Mile 6.87

WEST - MEMPHIS METRO SWEEPING
I-55 / HWY. 64 INTERCHANGE