

**ARKANSAS STATE HIGHWAY COMMISSION  
ARDOT - EQUIPMENT AND PROCUREMENT DIVISION  
BID INVITATION**

Bid Number: M-19-013P

**BID OPENING LOCATION:**  
ARDOT Equipment and Procurement Division  
11302 West Baseline Road  
Little Rock, AR 72209

**MAIL TO:**  
ARDOT Equipment and Procurement Division  
P.O. Box 2261  
Little Rock, AR 72203

**DELIVER TO:**  
ARDOT Equipment and Procurement Division  
11302 West Baseline Road  
Little Rock, AR 72209

Bid Opening Date: September 11, 2018 Time: 11:00 a.m.

Sealed bids for furnishing the commodities and/or services described below, subject to the Standard Bid Conditions of this Bid Invitation will be received at the above-noted mail and delivery locations until the above-noted bid opening date and time, and then publicly opened at the above-noted bid opening location. **Bids must be submitted on this form, with attachments when appropriate, or bids will be rejected. Late bids and unsigned bids will not be considered.**

In compliance with this Bid Invitation and subject to all the Conditions thereof, the undersigned offers and agrees to furnish any and all items upon which prices are quoted, at the price set opposite each item.

Company Name: \_\_\_\_\_

Name (Type or Print): \_\_\_\_\_

Address: \_\_\_\_\_

Title: \_\_\_\_\_

Phone: \_\_\_\_\_ Fax: \_\_\_\_\_

City: \_\_\_\_\_ State: \_\_\_\_\_ Zip: \_\_\_\_\_

E-mail Address: \_\_\_\_\_

Federal Tax ID or Social Security No.: \_\_\_\_\_

**Signature:** \_\_\_\_\_

Signature must be legible, original (not photocopied) and in ink. Unsigned bids will be rejected.

Item No.	Description	Quantity	Unit	Unit Price	Amount
----------	-------------	----------	------	------------	--------

1. Equipment Storage Building – 50’ x 210’ with open sides. Building shall include all labor, materials and installation of metal structure, roof materials, metal trim, gutters with downspouts, electrical wiring, lights, switches and receptacles. Structure to be located at the Arkansas Department of Transportation, District 2 Headquarters, 4900 Hwy. 65 South, Pine Bluff, AR 71601.

LUMP SUM \_\_\_\_\_

To meet the requirements of Arkansas Department of Transportation Specifications attached to and made a part of this bid.

CONTACT PERSON: Tim Kelly (870-534-8203)

**All bidders should complete and return the Eligible Bidder Certification (Attachment A), Disclosure Form (see Page 2 of Standard Bid Conditions – Item 18), Restriction of Boycott of Israel Certification and Illegal Immigrant Certification (see Page 2 of Standard Bid Conditions – Item 17) issued with this bid. These forms are kept on file and remain current for one year from date of submission. Forms do not need to be submitted again, during that time, unless there is a status change.**

Bid price shall include all labor, materials, and equipment necessary to perform the work as specified, and shall further include all licenses, fees, permits, royalties, and all taxes. Bid price shall represent full compensation for completion of the work. This provision supersedes Condition 5 on Page 1 of Standard Bid Conditions. Payment will be made in accordance with Arkansas Department of Transportation Standard Specifications for Highway Construction, Edition of 2014, and applicable Special Provisions.

Subsections 105.04, 108.07, 109.01 and 109.02 of the Arkansas Department of Transportation Standard Specifications for Highway Construction, Edition of 2014, will be in effect. (Specifications are accessible on our web site at [www.ardot.gov](http://www.ardot.gov).)

**Bid Bond** in the amount of \$1,000.00 required of all bidders at time of bid opening or bid will be rejected. **Personal and company checks are not acceptable as Bid Bonds.** See Condition 4 on page 1 of Standard Bid Conditions.

**Performance Bond** only (no checks of any kind allowed) in the amount of 100% of total bid price will be required of successful bidder prior to providing goods/services. See Condition 4 on page 1 of Standard Bid Conditions.

The successful bidder will be required to begin within 15 days after notice to begin and complete within 60 working days after project has begun.

Arkansas Contractor’s License No. \_\_\_\_\_.

Current Arkansas Contractor’s License Number must be listed or bid will be rejected (A.C.A. ¶17-25-101 *et seq.*).

Bids and Specifications are available on-line by going to the ARDOT Web Site – [www.ardot.gov](http://www.ardot.gov) and clicking on “Commodities and Services Bids/Contracts Information”. Tabulations will also be available at this site after award of bid/contract. If you have any questions, call this office at 501-569-2667.

## ARDOT - STANDARD BID CONDITIONS

1. **GENERAL:** Any special terms and conditions included in the invitation for bid override these standard terms and conditions. The standard terms and conditions and any special terms and conditions become part of any contract entered into if any or all parts of the bid are accepted by the Arkansas Department of Transportation (ARDOT).
2. **ACCEPTANCE AND REJECTION:** ARDOT reserves the right to reject any or all bids, to accept bids in whole or in part (unless otherwise indicated by bidder), to waive any informalities in bids received, to accept bids on materials or equipment with variations from specifications where efficiency of operation will not be impaired, and to award bids to best serve the interest of the State.
3. **PRICES:** Unless otherwise stated in the Bid Invitation, the following will apply: (1) unit prices shall be bid, (2) prices should be stated in units of quantity specified (feet, each, lbs., etc.), (3) prices must be F.O.B. destination specified in bid, (4) prices must be firm and not subject to escalation, (5) bid must be firm for acceptance for 30 days from bid opening date. In case of errors in extension, unit prices shall govern. Discounts from bid price will not be considered in making awards.
4. **BID BONDS AND PERFORMANCE BONDS:** If required, a **Bid Bond** in the form of a cashier's check, certified check, or surety bond issued by a surety company, in an amount stated in the Bid Invitation, must accompany bid. **Personal and company checks are not acceptable as Bid Bonds.** Failure to submit a Bid Bond as required will cause a bid to be rejected. The Bid Bond will be forfeited as liquidated damages if the successful bidder fails to provide a required Performance Bond within the period stipulated by ARDOT or fails to honor their bid. When a bidder claims and can show clear and convincing evidence that a material mistake was made in the bid and was not the bid intended, the bidder may be permitted to withdraw their bid prior to award without forfeiture of bid bond. Cashier's checks and certified checks submitted as Bid Bonds will be returned to unsuccessful bidders; surety bonds will be retained. The successful bidder will be required to furnish a **Performance Bond** in an amount stated in the Bid Invitation and in the form of a cashier's check, certified check, or surety bond issued by a surety company, unless otherwise stated in the Bid Invitation, as a guarantee of delivery of goods/services in accordance with the specifications and within the time established in the bid. **Personal and company checks are not acceptable as Performance Bonds.** In some cases, a cashier's check or certified check submitted as a Bid Bond will be held as the Performance Bond of the successful bidder. Cashier's checks or certified checks submitted as Performance Bonds will be refunded shortly after payment has been made to the successful bidder for completion of all terms of the bid; surety bonds will be retained. Surety bonds must be issued by a surety company that is authorized to do business in the State of Arkansas and that is listed on the current United States Department of the Treasury Listing of Approved Sureties. Surety bonds must be executed by a resident or non-resident agent who is licensed by the Arkansas State Insurance Commissioner to represent the surety company executing the bond, and the resident or non-resident agent shall file with the bond the power of attorney of the agent to act on behalf of the bonding company. Certain bids involving labor will require Performance Bonds in the form of surety bonds only (no checks of any kind allowed). These bonds shall not only serve to guarantee the completion of the work, but also to guarantee the excellence of both workmanship and material until the work is finally accepted and the provisions of the Plans, Specifications, and Special Provisions fulfilled. In such cases, the company issuing the surety bond must comply with all stipulations herein and must be named in the U. S. Treasury listing of companies holding Certificates of Authority as acceptable sureties on Federal Bonds and as acceptable reinsuring companies. Any excess between the face amount of the bond and the underwriting limitation of the bonding company shall be protected by reinsurance provided by an acceptable reinsuring company. Annual Bid and Performance Bonds on file with E & P Division must have sufficient unencumbered funds to meet current bonding requirements, or the bid will be rejected, unless the balance is submitted as set forth above, prior to bid opening.
5. **TAXES:** The ARDOT is not exempt from Arkansas State Sales and Use Taxes, or local option city/county sales taxes, when applicable, and bidders are responsible to the State Revenue Department for such taxes. These taxes should not be included in bid prices, but where required by law, will be paid by the ARDOT as an addition thereto, and should be added to the billing to the ARDOT. The ARDOT is exempt from Federal Excise Taxes on all commodities except motor fuels; and excise taxes should not be included in bid prices except for motor fuels. Where applicable, tax exemption certificates will be furnished by the ARDOT.
6. **"ALL OR NONE" BIDS:** Bidders who wish to bid "All or None" on two or more items shall so stipulate on the face of bid sheet; otherwise, bid may be awarded on an individual item basis.
7. **SPECIFICATIONS:** Complete specifications should be attached for any substitution or alternate offered, or where amplification is necessary. Bidder's name must be placed on all attachments to the bid.
8. **EXCEPTIONS TO SPECIFICATIONS:** Any exceptions to the bid specifications must be stated in the bid. Any exceptions to manufacturer's published literature must be stated in the bid, or it will be assumed that bidder is bidding exactly as stated in the literature.
9. **BRAND NAME REFERENCES:** All brand name references in bid specifications refer to that commodity or its equivalent, unless otherwise stated in Bid Invitation. Bidder should state brand or trade name of item being bid, if such name exists.
10. **FREIGHT:** All freight charges should be included in bid price. Any change in common carrier rates authorized by the Interstate Commerce Commission will be adjusted if such change occurs after the bid opening date. Receipted common carrier bills that reflect ICC authorized rate changes must be furnished.

11. **SAMPLES, LITERATURE, DEMONSTRATIONS:** Samples and technical literature must be provided free of any charge within 14 days of ARDOT request, and free demonstrations within 30 days, unless ARDOT extends time. Failure to provide as requested within this period may cause bid to be rejected. Samples, literature and demonstrations must be substantially the same as the item(s) being bid, unless otherwise agreed to by ARDOT. Samples that are not destroyed will be returned upon request at bidders expense. Samples from successful bidders may be retained for comparison with items actually furnished.
12. **GUARANTY:** Unless otherwise indicated in Bid Invitation, it is understood and agreed that any item offered or shipped on this bid shall be newly manufactured, latest model and design, and in first class condition; and that all containers shall be new, suitable for storage or shipment and in compliance with all applicable laws relating to construction, packaging, labeling and registration.
13. **BACKORDERS OR DELAY IN DELIVERY:** Backorders or failure to deliver within the time required may constitute default. Vendor must give written notice to the ARDOT, as soon as possible, of the reason for any delay and the expected delivery date. The ARDOT has the right to extend delivery if reasons appear valid. If reason or delivery date is not acceptable, vendor is in default.
14. **DEFAULT:** All commodities furnished will be subject to inspection and acceptance by ARDOT after delivery. Default in promised delivery or failure to meet specifications authorizes the ARDOT to cancel award or any portion of same, to reasonably purchase commodities or services elsewhere and to charge full increase, if any, in cost and handling to defaulting vendor. Applicable bonds may be forfeited.
15. **ETHICS:** *"It shall be a breach of ethical standards for a person to be retained, or to retain a person, to solicit or secure a State contract upon an agreement of understanding for a commission, percentage, brokerage, or contingent fee, except for retention of bona fide employees or bona fide established commercial selling agencies maintained by the contractor for the purpose of securing business."* (Arkansas Code, Annotated, Section 19-11-708).
16. **NOTICE OF NONDISCRIMINATION:** The Arkansas State Highway Commission, through ARDOT, complies with all civil rights provisions of federal statutes and related authorities that prohibit discrimination in programs and activities receiving federal financial assistance. Therefore, ARDOT does not discriminate on the basis of race, sex, color, age, national origin, religion (not applicable as a protected group under the Federal Motor Carrier Safety Administration Title VI Program), disability, Limited English Proficiency (LEP), or low-income status in the admission, access to and treatment in the ARDOT's programs and activities, as well as the ARDOT's hiring or employment practices. Complaints of alleged discrimination and inquiries regarding the ARDOT's nondiscrimination policies may be directed to Joanna P. McFadden Section Head – EEO/DBE (ADA/504/Title VI Coordinator), P. O. Box 2261, Little Rock, AR 72203, (501)569-2298, (Voice/TTY 711), or the following email address: [joanna.mcfadden@ardot.gov](mailto:joanna.mcfadden@ardot.gov). Free language assistance for Limited English Proficient individuals is available upon request. This notice is available from the ADA/504/Title VI Coordinator in large print, on audiotape and in Braille.
17. **PROHIBITION OF EMPLOYMENT OF ILLEGAL IMMIGRANTS:** Pursuant to Arkansas Code Annotated 19-11-105, all bidders must certify prior to award of a contract that they **do not** employ or contract with any illegal immigrant(s) in its contract with the state.
18. **DISCLOSURE:** Failure to make any disclosure required by Governor's Executive Order 98-04, or any violation of any rule, regulation, or policy adopted pursuant to that order, **shall** be a material breach of the terms of this contract. Any contractor, whether an individual or entity, who fails to make the required disclosure or who violates any rule, regulation, or policy **shall** be subject to all legal remedies available to the agency.

ATTACHMENT A

**ELIGIBLE BIDDER CERTIFICATION**

The Bidder represents and warrants for itself, its employees and its subcontractors and certifies they:

1. Are not presently debarred, suspended, proposed for debarment, declared ineligible, or voluntarily excluded from covered transactions by any Federal department or agency;
2. Have not within a three-year period preceding this Bid been convicted of or had a civil judgment rendered against them for commission of fraud or a criminal offense in connection with obtaining, attempting to obtain, or performing a public (Federal, State, or local) transaction or contract under a public transaction; violation of Federal or State antitrust statutes or commission of embezzlement, theft, forgery, bribery, falsification or destruction of records, making false statements, or receiving stolen property;
3. Are not presently indicted for or otherwise criminally or civilly charged by a governmental entity (Federal, State, or local) with commission of any of the offenses enumerated in paragraph two (2) of this Certification;
4. Have not within a one-year period preceding this application/Bid had one or more public transactions (Federal, State, or local) terminated for cause or default; and

The Bidder represents, warrants and acknowledges the understanding that restrictions placed on the employment of labor or on the scale of pay for the work on a contract will be the requirements of the Fair Labor Standards Act (Federal Wage-Hour Law) of 1938, 28 USC §201 et seq., and other applicable labor laws.

The person executing this Certification further represents, warrants and affirms the truthfulness and accuracy of the contents of the statements submitted on or with this Certification and understands that the provisions of 31 USC §3801 et seq. are applicable thereto.

\_\_\_\_\_

BIDDER NAME

BY: \_\_\_\_\_

Signature

TITLE: \_\_\_\_\_

## CONTRACT AND GRANT DISCLOSURE AND CERTIFICATION FORM

Failure to complete all of the following information may result in a delay in obtaining a contract, lease, purchase agreement, or grant award with any Arkansas State Agency.

SUBCONTRACTOR:

SUBCONTRACTOR NAME:

Yes  No

IS THIS FOR:

TAXPAYER ID NAME:

Goods?  Services?  Both?

YOUR LAST NAME:

FIRST NAME:

M.I.:

ADDRESS:

CITY:

STATE:

ZIP CODE:

COUNTY:

***AS A CONDITION OF OBTAINING, EXTENDING, AMENDING, OR RENEWING A CONTRACT, LEASE, PURCHASE AGREEMENT, OR GRANT AWARD WITH ANY ARKANSAS STATE AGENCY, THE FOLLOWING INFORMATION MUST BE DISCLOSED:***

### FOR INDIVIDUALS\*

Indicate below if: you, your spouse or the brother, sister, parent, or child of you or your spouse is a current or former: member of the General Assembly, Constitutional Officer, State Board or Commission Member, or State Employee:

Position Held	Mark ( ✓ )		Name of Position of Job Held <small>(senator, representative, name of board/ commission, data entry, etc.)</small>	For How Long?		What is the person(s) name and how are they related to you? <small>(i.e., Jane Q. Public, spouse, John Q. Public, Jr., child, etc.)</small>	
	Current	Former		From MM/YY	To MM/YY	Person's Name(s)	Relation
General Assembly							
Constitutional Officer							
State Board or Commission Member							
State Employee							

None of the above applies

### FOR AN ENTITY (BUSINESS)\*

Indicate below if any of the following persons, current or former, hold any position of control or hold any ownership interest of 10% or greater in the entity: member of the General Assembly, Constitutional Officer, State Board or Commission Member, State Employee, or the spouse, brother, sister, parent, or child of a member of the General Assembly, Constitutional Officer, State Board or Commission Member, or State Employee. Position of control means the power to direct the purchasing policies or influence the management of the entity.

Position Held	Mark ( ✓ )		Name of Position of Job Held <small>(senator, representative, name of board/ commission, data entry, etc.)</small>	For How Long?		What is the person(s) name and what is his/her % of ownership interest and/or what is his/her position of control?		
	Current	Former		From MM/YY	To MM/YY	Person's Name(s)	Ownership Interest (%)	Position of Control
General Assembly								
Constitutional Officer								
State Board or Commission Member								
State Employee								

None of the above applies

## Contract and Grant Disclosure and Certification Form

*Failure to make any disclosure required by Governor's Executive Order 98-04, or any violation of any rule, regulation, or policy adopted pursuant to that Order, shall be a material breach of the terms of this contract. Any contractor, whether an individual or entity, who fails to make the required disclosure or who violates any rule, regulation, or policy shall be subject to all legal remedies available to the agency.*

As an additional condition of obtaining, extending, amending, or renewing a contract with a state agency I agree as follows:

1. Prior to entering into any agreement with any subcontractor, prior or subsequent to the contract date, I will require the subcontractor to complete a **CONTRACT AND GRANT DISCLOSURE AND CERTIFICATION FORM**. Subcontractor shall mean any person or entity with whom I enter an agreement whereby I assign or otherwise delegate to the person or entity, for consideration, all, or any part, of the performance required of me under the terms of my contract with the state agency.
  
2. I will include the following language as a part of any agreement with a subcontractor:

Failure to make any disclosure required by Governor's Executive Order 98-04, or any violation of any rule, regulation, or policy adopted pursuant to that Order, shall be a material breach of the terms of this subcontract. The party who fails to make the required disclosure or who violates any rule, regulation, or policy shall be subject to all legal remedies available to the contractor.
  
3. No later than ten (10) days after entering into any agreement with a subcontractor, whether prior or subsequent to the contract date, I will mail a copy of the **CONTRACT AND GRANT DISCLOSURE AND CERTIFICATION FORM** completed by the subcontractor and a statement containing the dollar amount of the subcontract to the state agency.

Signature _____	Title _____	Date _____
Vendor Contact Person _____	Title _____	Phone No. _____

Agency Use Only				
Agency Number _____	Agency Name _____	Agency Contact Person _____	Contact Phone No. _____	Contract or Grant No. _____

# RESTRICTION OF BOYCOTT OF ISRAEL CERTIFICATION

Pursuant to Arkansas Code Annotated § 25-1-503, a public entity **shall not** enter into a contract valued at \$1,000 or greater with a company unless the contract includes a written certification that the person or company is not currently engaged in, and agrees for the duration of the contract not to engage in, a boycott of Israel.

By signing below, the Contractor agrees and certifies that they do not boycott Israel and will not boycott Israel during the remaining aggregate term of the contract.

If a company does boycott Israel, see Arkansas Code Annotated § 25-1-503.

Bid Number/Contract Number	M-19-013P
Description of product or service	Equipment Storage Building
<b>Contractor name</b>	

Contractor Signature: \_\_\_\_\_  
Signature must be hand written, in ink

Date: \_\_\_\_\_

# ILLEGAL IMMIGRANT CERTIFICATION

Pursuant to Arkansas Code Annotated § 19-11-105, Contractor(s) **shall** certify with OSP that they do not employ or contract with illegal immigrants.

By signing below, the Contractor agrees and certifies that they do not employ illegal immigrants and will not employ illegal immigrants during the remaining aggregate term of the contract.

Bid Number/Contract Number	M-19-013P
AASIS Number	N/A
Description	Equipment Storage Building
<b>Contractor name</b>	

Contractor Signature: \_\_\_\_\_ Date: \_\_\_\_\_  
Signature must be hand written, in ink



**DISTRICT 2 HEADQUARTERS  
EQUIPMENT STORAGE BUILDING  
PINE BLUFF, ARKANSAS  
JEFFERSON COUNTY**

**SECTION 13 34 19 - METAL BUILDING SYSTEMS**

**PART 1 - GENERAL**

**1.1 SECTION REQUIREMENTS**

- A. Submittals: Product Data, Samples, Shop Drawings and structural analysis data signed and sealed by a qualified professional engineer registered in the state where Project is located.
1. Submit letter of design certification, signed and sealed by a qualified professional engineer. Indicate name and location of Project, name of manufacturer, order number, name of contractor, governing building code and standards including year of edition, design loads and load combinations, building use category, and load importance factors.
  2. Upon completion, and prior to final acceptance as-builts for both the electrical work and the building will be prepared and given to the Engineer.
- B. Comply with AISC 360, "Specification for Structural Steel Buildings," and with AISI's "North American Specification for the Design of Cold-Formed Steel Structural Members" for design requirements and allowable stresses.

**PART 2 - PRODUCTS**

**2.1 METAL BUILDINGS**

- A. Metal Building System Description: Rigid clear span with nonexpandable endwalls, primary frame and endwall columns.
1. Eave Height: As indicated on Drawings.
  2. Dimensions and Bay Spacings: As indicated on Drawings.
  3. Roof Slope: 1 inch per 12 inches.
- B. Design Criteria:
1. Applicable Building Code: IBC 12
  2. Roof Live Load (psf): 20
  3. Roof Dead Load (psf): 2.200
  4. Roof Snow Load: 7

**DISTRICT 2 HEADQUARTERS  
EQUIPMENT STORAGE BUILDING  
PINE BLUFF, ARKANSAS  
JEFFERSON COUNTY**

5. Ground Snow Load: 10
6. Snow Importance: 1.00
  
7. Reduction Allowed: Yes
8. Roof Collateral Load (psf): 4
9. Wind Speed (mph): 115
10. Wind Importance: 1.00
11. Building Exposure: B
12. Surface Roughness: B
13. Seismic Zone: C
14. Seismic Importance: 1.00
15. Seismic Coeff.:  $S_s=0.17$   $S_1=0.09$

C. Deflection Criteria:

1. Wall Girt Max.:  $L/90$
2. Roof Pulin L.L.:  $L/180$
3. Rigid Frame Horizontal:  $H/60$
4. Rigid Frame Vertical:  $L/180$

D. Wind Framing:

1. Roof: Diagonal Bracing
2. Endwalls: Rigid Frames
3. Sidewalls: Wind Bents

E. Structural-Framing Materials:

1. W-Shapes: ASTM A 992/A 992M; ASTM A 572/A 572M, Grade 50 or 55; or ASTM A 529/A 529M, Grade 50 or 55.
2. Channels, Angles, M-Shapes, and S-Shapes: ASTM A 36/A 36M; ASTM A 572/A 572M, Grade 50 or 55; or ASTM A 529/A 529M, Grade 50 or 55.
3. Plate and Bar: ASTM A 36/A 36M; ASTM A 572/A 572M, Grade 50 or 55; or ASTM A 529/A 529M, Grade 50 or 55.
4. Steel Pipe: ASTM A 53/A 53M, Type E or S, Grade B.
5. Cold-Formed Hollow Structural Sections: ASTM A 500, Grade B or C, structural tubing.
6. Structural-Steel Sheet: Hot-rolled, ASTM A 1011/A 1011M, Structural Steel (SS), Grades 30 through 55, or High-Strength Low-Alloy Steel (HSLAS), Grades 45 through 70; or cold-rolled, ASTM A 1008/A 1008M, Structural Steel (SS), Grades 25 through 80, or High-Strength Low-Alloy Steel (HSLAS), Grades 45 through 70.
7. Metallic-Coated Steel Sheet: ASTM A 653/A 653M, Structural Steel (SS), Grades 33 through 80, or High-Strength Low-Alloy Steel (HSLAS), Grades 50 through 80; with G60 coating designation; mill phosphatized.

**DISTRICT 2 HEADQUARTERS  
EQUIPMENT STORAGE BUILDING  
PINE BLUFF, ARKANSAS  
JEFFERSON COUNTY**

8. Steel Joists and Joist Girders: Comply with SJI's "Standard Specifications, Load Tables, and Weight Tables for Steel Joists and Joist Girders," with steel-angle top and bottom chord members.
- F. Roof and Wall Panels:
1. Metal Panels: Steel sheet, zinc coated by the hot-dip process, complying with ASTM A 653/A 653M, G90, Structural Steel (SS), and prepainted by the coil-coating process to comply with ASTM A 755/A 755M.
  2. Standing-Seam Roof Panels: Metal panels factory formed to provide 24-inch coverage; with 3-inch-high (including seam), raised trapezoidal major ribs at panel edges, and intermediate stiffening ribs symmetrically spaced between major ribs. Single-folded, mechanically seamed panels. Design panels for mechanical attachment to structure using concealed clips engaging panel edges.
  3. Roof Panel Metal Thickness: 26 Gauge
  4. Lap-Seam Wall Panels: Metal panels factory formed to provide 36-inch coverage, with raised trapezoidal major ribs at 12 inches o.c., and intermediate stiffening ribs symmetrically spaced between major ribs. Design panels for mechanical attachment to structure using exposed fasteners, lapping major ribs at panel edges.
  5. Wall Panel Metal Thickness: 26 Gauge
  6. Metal Panel Finish: Fluoropolymer two-coat system consisting of specially formulated inhibitive primer and fluoropolymer color topcoat containing not less than 70 percent PVDF resin by weight, with a total minimum dry film thickness of 1 mil.
  7. Panel Accessories: Provide clips, flashings, sealants, gaskets, and similar items.
- G. Flashing and Trim: Form from 0.022-inch nominal-thickness, zinc-coated (galvanized) steel sheet prepainted with coil coating. Provide flashing and trim as required to seal against weather and to provide finished appearance. Finish flashing and trim same as adjacent roof or wall panels.
- H. Miscellaneous Materials:
1. Grout: ASTM C 1107, factory-packaged, nonmetallic grout, noncorrosive, and nonstaining.

**DISTRICT 2 HEADQUARTERS  
EQUIPMENT STORAGE BUILDING  
PINE BLUFF, ARKANSAS  
JEFFERSON COUNTY**

**PART 3 - EXECUTION**

**3.1 ERECTION**

- A. Setting Base and Bearing Plates: Clean concrete and masonry of bond-reducing materials and roughen surfaces before setting plates. Clean bottom surface of plates.
1. Set plates for structural members on wedges, shims, or setting nuts.
  2. Tighten anchor rods after supported members have been positioned and plumbed.
  3. Pack grout solidly between bearing surfaces and plates so no voids remain. Neatly finish exposed surfaces; protect grout and allow to cure.
- B. Erect framing true to line, level, plumb, rigid, and secure. Comply with AISC specifications referenced in this Section.
1. Make field connections for primary framing using high-strength bolts installed according to RCSC's "Specification for Structural Joints Using ASTM A 325 or A 490 Bolts," snug tightened or pretensioned.
  2. Fasten secondary framing to primary framing using clips and non-high-strength bolts. Hold rigidly to a straight line by sag rods.
  3. Install purlins, girts and accessories plumb, square, and true to line; securely fasten to supporting construction.
  4. Bracing: Install bracing in roof and sidewalls where indicated on erection drawings.
- C. Roof Panel Installation: Provide roof panels of full length from eave to ridge when possible.
1. Install screws with power tools having controlled torque to compress neoprene washer without damage to washer, screw threads, or panels. Install screws in predrilled holes.
  2. Use aluminum or stainless-steel fasteners for exterior and galvanized fasteners for interior.
  3. Locate panel splices over, but not attached to, structural supports; stagger panel splices.
  4. Standing-Seam Roof Panels: Fasten to purlins with concealed clips at each standing-seam joint. Install clips over top of insulation. Crimp standing seams with manufacturer-approved motorized seamer tool. Rigidly fasten eave end of metal roof panels and allow ridge end free movement due to thermal expansion and contraction.

**DISTRICT 2 HEADQUARTERS  
EQUIPMENT STORAGE BUILDING  
PINE BLUFF, ARKANSAS  
JEFFERSON COUNTY**

- D. Wall Panel Installation: Provide panels full height of building unless otherwise indicated.
1. Arrange and nest side-lap joints so prevailing winds blow over, not into, lapped joints.
  2. When two rows of panels are required, lap panels 4 inches minimum. Locate panel splices over structural supports.
  3. Rigidly fasten base end of metal wall panels and allow eave end free movement due to thermal expansion and contraction. Pre-drill panels.
  4. Apply elastomeric sealant continuously between metal base channel (sill angle) and concrete, and elsewhere as necessary for waterproofing.
  5. Apply a continuous ribbon of sealant tape to weather-side surface of fastenings on lap seams.
  6. Install screws with power tools having controlled torque to compress neoprene washer without damage to washer, screw threads, or panels. Install screws in pre-drilled holes.
  7. Use aluminum or stainless-steel fasteners for exterior and galvanized fasteners for interior.

**END OF SECTION 13 34 19**



# DISTRICT 2 EQUIPMENT STORAGE SHED 50' X 210'

JEFFERSON COUNTY

SPA 2-833

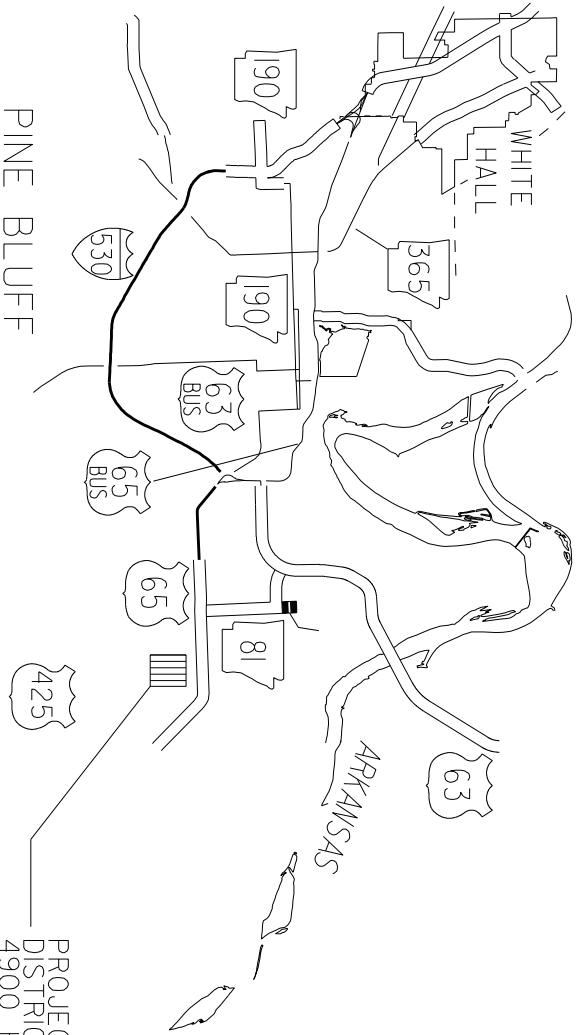

PROJECT LOCATION  
DISTRICT # 2 HEADQUARTERS  
4900 HIGHWAY 65 SOUTH

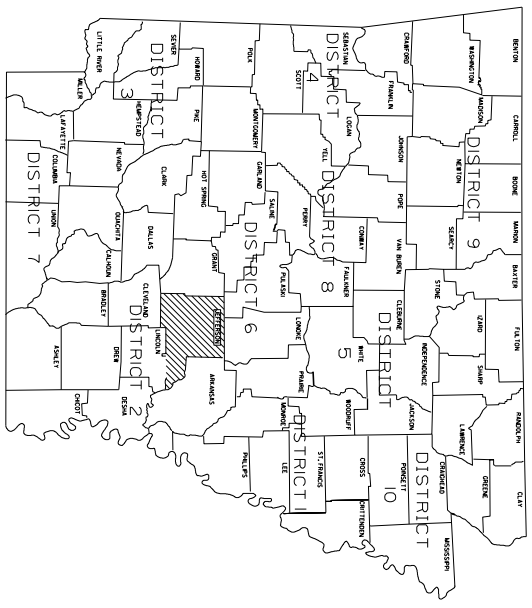

DATE REVISION	DATE REVISION	DATE REVISION	DATE REVISION	DESIGN NO.	STATE	TOWN OR PARISH	SHEET NO.	TOTAL SHEETS
				2-833	ARK.		1	9
<p>② DISTRICT 2 STORAGE SHED 50' X 210'</p>								

# INDEX OF SHEETS

## SHEET NO.

## TITLE

- |      |                                     |
|------|-------------------------------------|
| 1.   | TITLE SHEET                         |
| 2.   | INDEX OF SHEETS                     |
| 3.   | GENERAL NOTES AND PAYMENT SCHEDULE  |
| 4-8. | SPECIAL DETAILS                     |
| 9.   | SUMMARY OF QUANTITIES AND REVISIONS |

SPA NUMBER 2-833  
DISTRICT 2 STORAGE BUILDING  
PINE BLUFF

SHEET 2 OF 9  
INDEX OF SHEETS

## GENERAL NOTES

1. THESE DRAWINGS ARE SET UP AS GENERAL DIMENSIONING DIAGRAMS AND ARE IN NOT INTENDED TO BE ERECTING PLANS. THE WINNING BIDDER WILL SUPPLY THE DEPARTMENT WITH A FULL SET OF WORKING DRAWINGS, STAMPED BY A PROFESSIONAL ENGINEER LICENSED IN THE STATE OF ARKANSAS.
2. ALL CURRENT BUILDING CODES WILL BE FOLLOWED DURING CONSTRUCTION.
3. ALL ELECTRICAL EQUIPMENT INSTALLED ON THE BUILDING WILL BE SPECIFIED FOR OUTSIDE USE.
4. ELECTRICAL / LIGHTING PLANS SHALL BE PREPARED, AND APPROVED BY THE DEPARTMENT PRIOR TO WORK STARTING.
5. POWER WILL BE STUBBED TO THE BUILDING PRIOR TO WORK BEGINNING. THIS POWER WILL BE AVAILABLE BOTH FOR INSTALLING ELECTRICAL EQUIPMENT, BUT ALSO FOR THE CONTRACTORS WORK DURING THE CONSTRUCTION PROCESS.
6. THE BUILDING PAD / ASPHALT MAT WILL BE COMPLETED BY THE DEPARTMENT PRIOR TO WORK BEGINNING ON THE BUILDING. ANY DAMAGE TO THE ASPHALT WILL BE REPAIRED AT NO COST TO THE DEPARTMENT.
7. A FULL SET OF AS BUILT S WILL BE PREPARED FOR THE BUILDING PRIOR TO THE FINAL INSPECTION.

## PAY SCHEDULE FOR THE PROJECT

1. AS MAJOR SHIPMENTS OF MATERIALS (GREATER THAN \$5000.00) ARRIVE AT THE FACILITY, COPIES OF THE INVOICES WILL BE TURNED IN. PAYMENTS WILL BE MADE BASED ON MATERIAL COSTS, SHIPPING COSTS, AND TAXES.
2. EVERY TWO WEEKS THE CONTRACTOR AND DISTRICT PERSONNEL WILL MEET AND DISCUSS THE PROGRESS OF THE BUILDING. PAYMENTS WILL BE MADE BASED ON PERCENTAGE OF PROJECT COMPLETION.
3. TEN PERCENT RETAINAGE WILL BE HELD UNTIL THE FINAL INSPECTION AND PROJECT ACCEPTATION.

SPA NUMBER 2-833  
DISTRICT 2 STORAGE BUILDING  
PINE BLUFF

SHEET 3 OF 9  
GENERAL NOTES / PAYMENT SCHEDULE



- COLORS:
1. THE FOURTEEN CONCRETE PILLARS WILL BE BRIGHT YELLOW, WITH TWO - YELLOW 4" 3M STYLE REFLECTIVE STRIPS FOUR INCHES FROM THE TOP, AND FOUR INCHES ABOVE THE GROUND.
  2. ALL STEEL FRAMING COMPONENTS WILL BE PAINTED DARK BRONZE TO MATCH THE OTHER BUILDINGS ON THE FACILITY

- COLORS:
3. ALL EXTERNAL STEEL SHALL BE HUNTER GREEN INCLUDING GUTTERS, DOWNSPOUTS AND TRIM.
  4. COLOR SAMPLES WILL BE SUPPLIED, AND APPROVED BY THE ENGINEER PRIOR TO USE ON THE BUILDINGS.

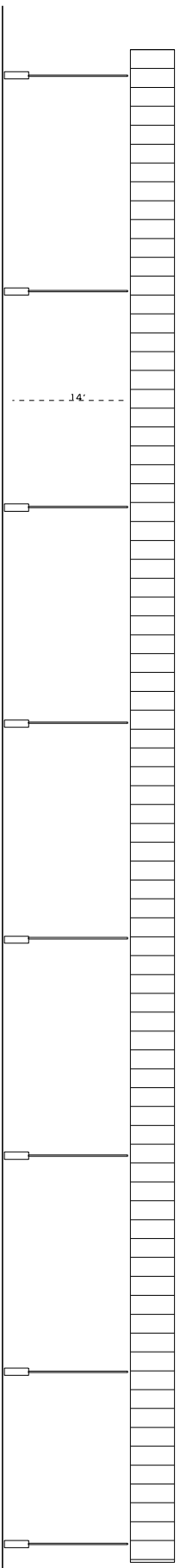

FRONT - BACK VIEW

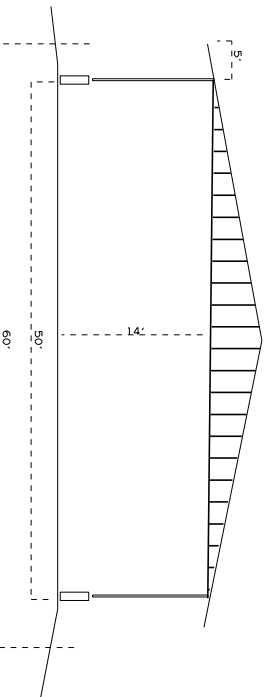

SIDE VIEW

- NOTES:
1. ALL CURRENT STANDARDS AND CODES WILL BE USED FOR THE CONSTRUCTION
  2. BUILDING PLANS WILL BE PREPARED AND STAMPED BY A PROFESSIONAL ENGINEER, LICENSED IN THE STATE OF ARKANSAS
  3. THESE PLANS ARE SHOWN TO INDICATE BASIC DIMENSIONING REQUIREMENTS FOR THE BUILDING. SMALL ADJUSTMENTS CAN BE MADE WHERE NECESSARY TO FACILITATE CONSTRUCTION WITH THE ENGINEERS APPROVAL.
  4. THE BUILDING WILL BE GROUNDED ACCORDING TO CURRENT STANDARDS TO PREVENT STORM DAMAGE FROM OCCURRING
  5. BUILDING WILL BE DESIGNED TO WITHSTAND 115 MPH WINDS, OR CURRENT STANDARDS IF THEY ARE GREATER.
  6. AS BUILT'S WILL BE PREPARED AT THE END OF THE JOB.

SPA NUMBER 2-833  
DISTRICT 2 STORAGE BUILDING  
PINE BLUFF

NOT TO SCALE

SHEET 4 OF 9  
FRONT AND SIDE  
ELEVATIONS

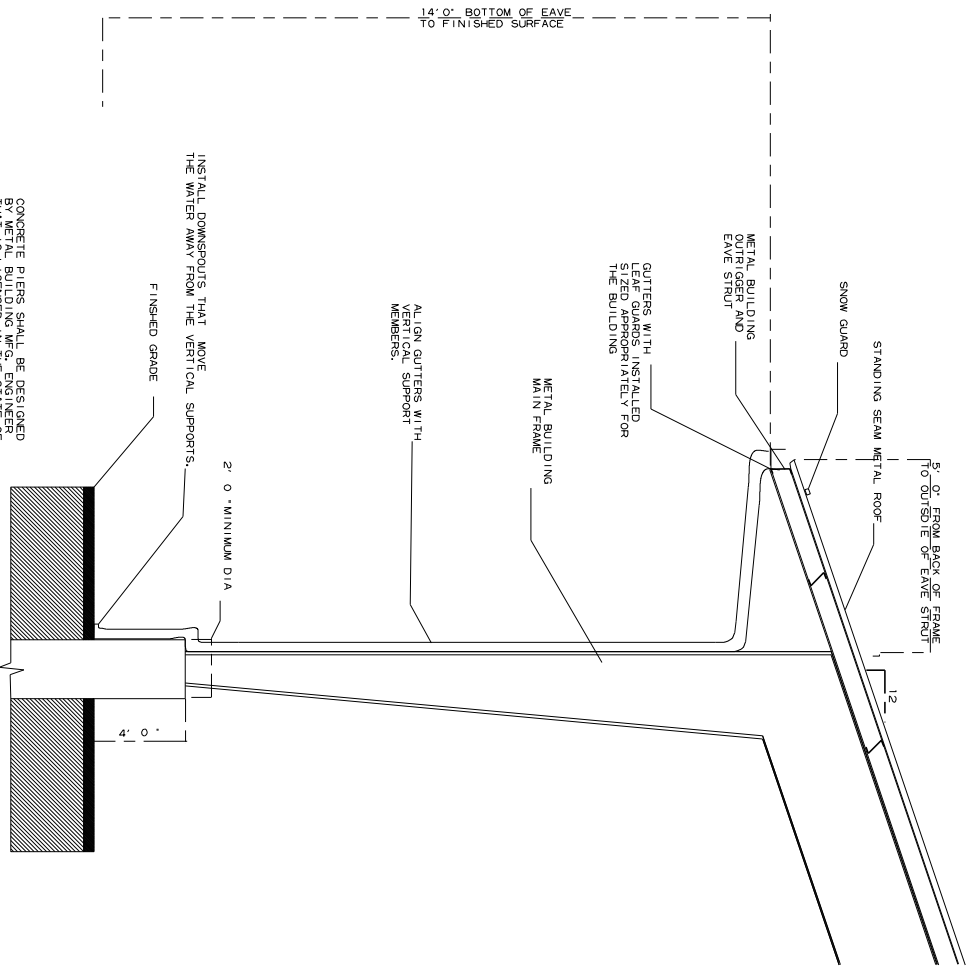

CONCRETE PIERS SHALL BE DESIGNED BY A LICENSED PROFESSIONAL ENGINEER THAT IS LICENSED IN THE STATE OF ARKANSAS, OR THE ALT. SHOWN TO THE RIGHT CAN BE UTILIZED. THE PIER SHALL EXTEND THROUGH THE AGWL AND BEAR A MINIMUM OF 96" BELOW NATURAL SOIL.

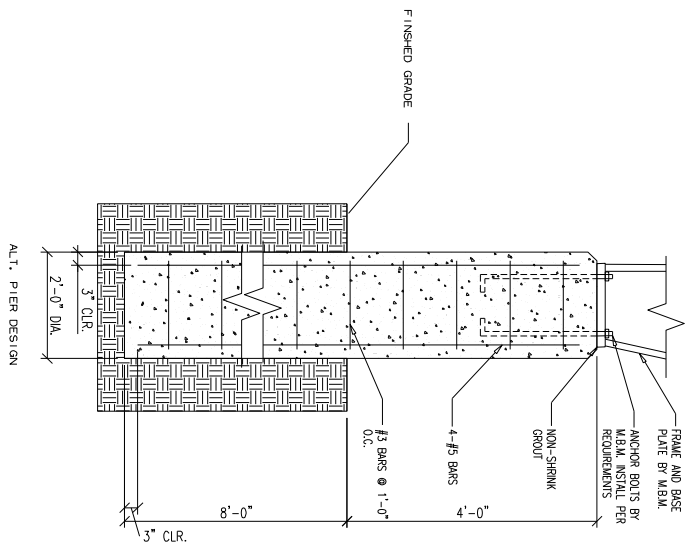

ALT. PIER DESIGN

NOT TO SCALE

SPA NUMBER 2-833  
 DISTRICT 2 STORAGE BUILDING  
 PINE BLUFF

SHEET 5 OF 9  
 WALL SECTION/ PIER DESIGN

A 200 AMP BREAKER BOX WILL BE PROVIDED  
BY THE CONTRACTOR

BUILDING FRONT

EACH BAY WILL HAVE A GFI  
110 VOLT RECEPTACLE. THE  
FIRST, THIRD AND SEVENTH BAY WILL  
HAVE ONE 220 VOLT RECEPTACLE.

EACH BAY WILL HAVE TWO  
17,500 LUMEN LED LIGHTS  
A POWER SWITCH WILL BE  
PROVIDED IN THE FRONT  
LEFT CORNER OF  
EACH BAY

ONE SWITCH WILL BE PROVIDED IN EACH FRONT CORNER  
TO POWER ALL THREE LIGHTS.

IN EACH FRONT CORNER, AND IN  
THE FRONT MIDDLE: ONE 5000  
LUMEN EXTERNAL FACING FLOOD  
LIGHT. THESE LIGHTS NEED TO  
BE ADJUSTABLE BOTH VERTICALLY  
AND HORIZONTALLY.

ARDOT WILL STUB POWER TO  
THIS LOCATION. POWER WILL BE  
AVAILABLE THROUGH THIS POINT FOR  
THE CONTRACTOR'S CONSTRUCTION  
WORK.

THE CONTRACTOR WILL BE RESPONSIBLE FOR INSTALLING  
A TEMPORARY LOOP FOR WORK PURPOSES. ARDOT PERSONNEL  
WILL HELP IN TURNING POWER OFF FOR HOOKUPS.

- NOTES:
1. ALL EQUIPMENT WILL BE SPECIFIED FOR EXTERNAL USE
  2. ALL CURRENT STANDARDS AND CODES WILL BE USED FOR THE CONSTRUCTION
  3. ELECTRICAL PLANS WILL BE PREPARED, AND APPROVED BY THE DEPARTMENT PRIOR TO WORK STARTING.
  4. ELECTRICAL AS BUILTS WILL BE PREPARED AT THE END OF THE JOB.

SPA NUMBER 2-833  
DISTRICT 2 STORAGE BUILDING  
PINE BLUFF

NOT TO SCALE

SHEET 6 OF 9  
POWER AND LIGHT PLAN

WORK TO BE PERFORMED BY ARDOT  
POWER WILL BE STUBBED OUT AT THE BUILDING SITE



SPA NUMBER 2-833  
DISTRICT 2 STORAGE BUILDING  
PINE BLUFF

NOT TO SCALE

SHEET 7 OF 9  
POWER DETAIL

WORK TO BE PERFORMED BY ARDOT  
DISTRICT FORCES

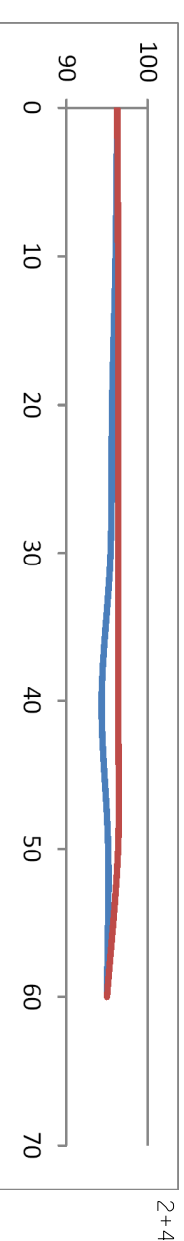
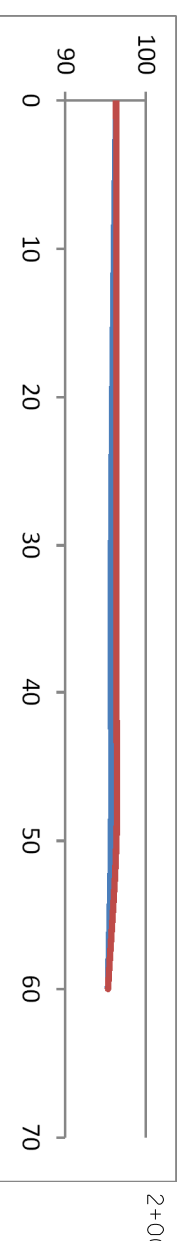
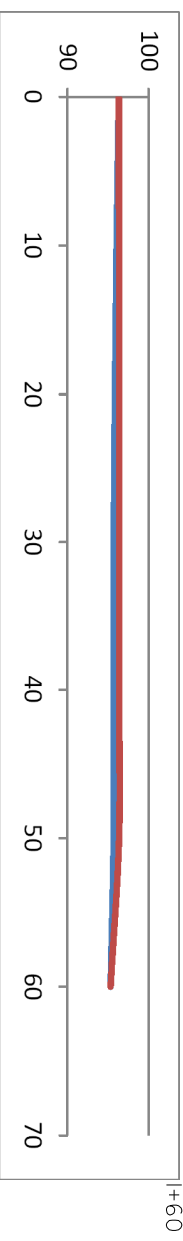
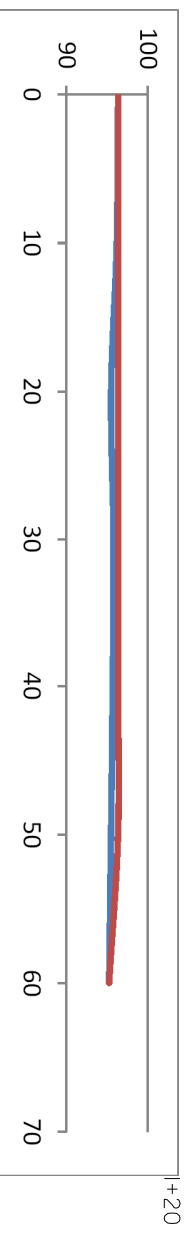
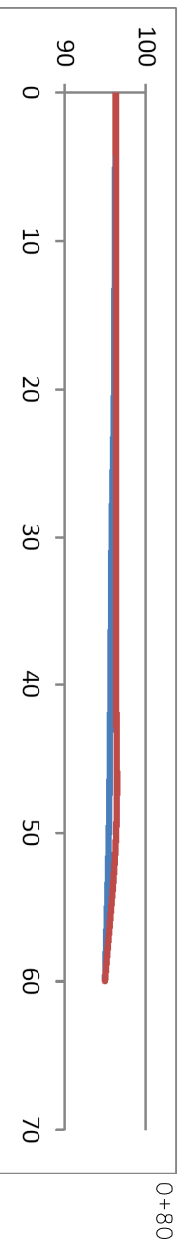
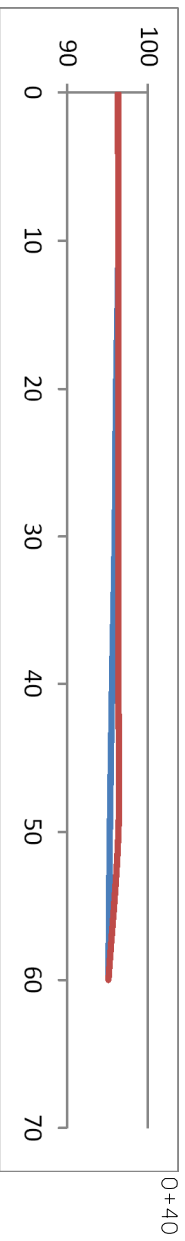
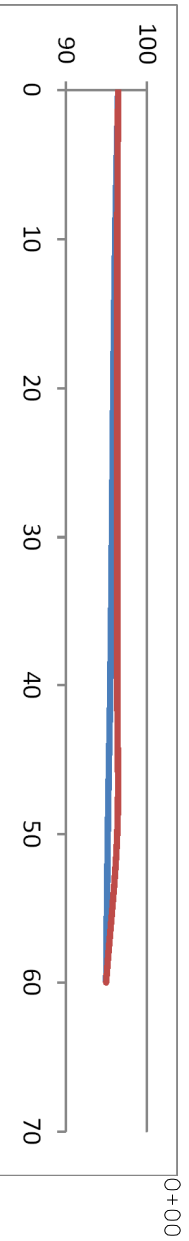

NOT TO SCALE

	0	10	20	30	40	60	AVG
0+00	0	0.26	0.49	0.66	0.86	1.16	0.57
0+40	0	0	0.29	0.46	0.79	1.06	0.43
0+80	0	0.17	0.26	0.56	0.7	0.9	0.43
1+20	0	0.17	0.86	0.56	0.66	0.87	0.52
1+60	0	0.31	0.51	0.66	0.66	0.67	0.47
2+00	0	0.31	0.51	0.66	0.66	0.67	0.47
2+40	0	0.31	0.74	0.93	2.03	1.22	0.87
							0.54

VOLUME = 80' X 240' X 0.54' / 27 = 380 YD<sup>3</sup>  
ASPHALT = (( 80' X 240' / 9 ) X 220 ) / 2000 = 235 TONS

SPA NUMBER 2-833  
DISTRICT 2 STORAGE BUILDING  
PINE BLUFF

**QUANTITIES**

ITEM	QUANTITY	UNIT	PRICE	COST
DISTRICT # 2 STORAGE BUILDING - 50' X 210' - OPEN SIDES	1	L.S.		

**REVISIONS**

ITEM	QUANTITY	UNIT	PRICE	COST

SPA NUMBER 2-833  
 DISTRICT 2 STORAGE BUILDING  
 PINE BLUFF

NOT TO SCALE

SHEET 9 OF 9  
 SUMMARY / COST DETAIL