

ARKANSAS DEPARTMENT OF TRANSPORTATION
EQUIPMENT AND PROCUREMENT OFFICE
LITTLE ROCK, ARKANSAS

August 4, 2020

NOTICE TO BIDDERS

ADDENDUM

Bid Number: M-21-001H

White River TIC Partial Sewer Main Replacement

Opening Date: August 11, 2020

BID INVITATION PLAN SHEET C1.1 TO BE REPLACED WITH AD1.1

Plan sheet AD1.1 details new pressure pipe connection to existing 4" pressure pipe from Tourist Information Center to prevent crossing of fiber optic line during directional bore process.

ALL OTHER SPECIFICATIONS SHALL REMAIN THE SAME.



Danny Keene
Division Head
Equipment and Procurement

**WHITE RIVER TIC PARTIAL
SEWER MAIN REPLACEMENT**

Hazen, Arkansas
Prairie County

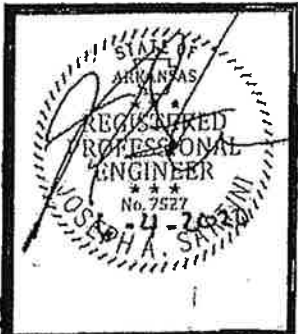

DATE: AUG. 5, 2020
JOB NO: 36-2988
DRAWN BY: KB
REVISIONS:

AD1.1

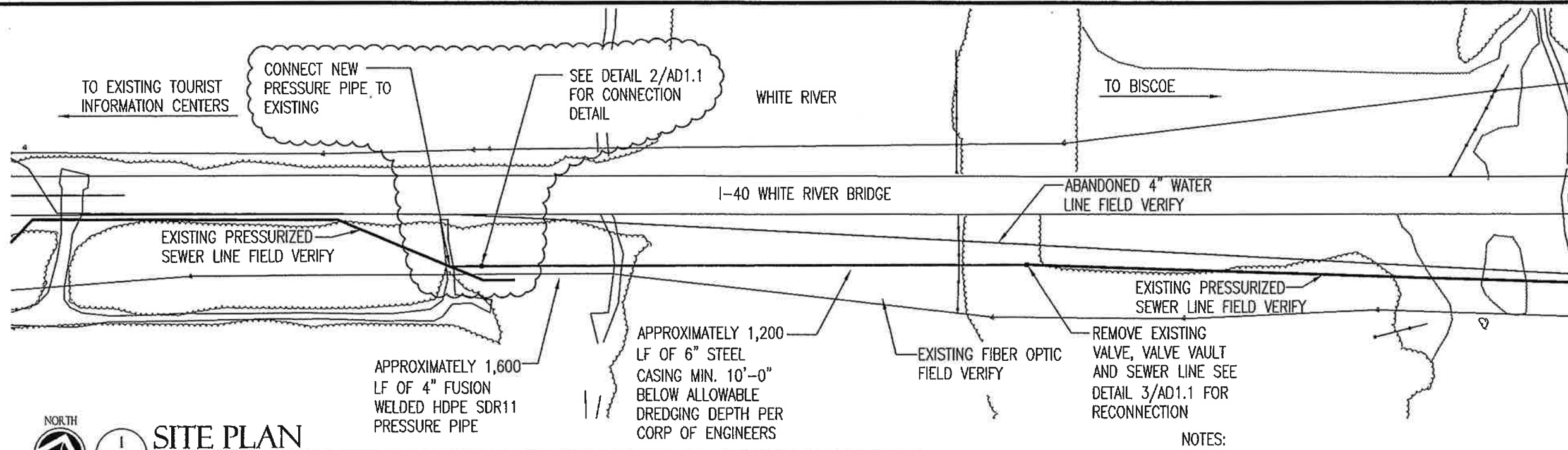

1 SITE PLAN
SCALE: 1" = 200.0'

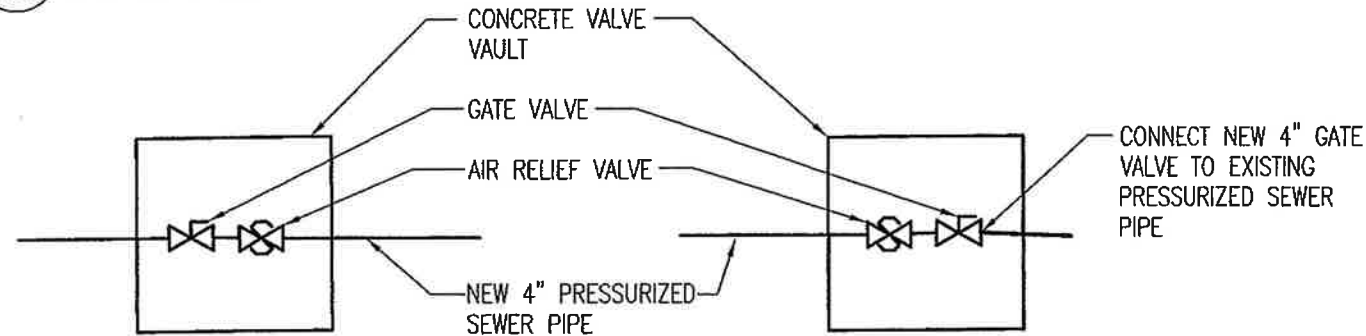

2 WEST TIE IN DETAIL
SCALE: NO SCALE

3 EAST TIE IN DETAIL
SCALE: NO SCALE

TESTING PROCEDURES FOR PRESSURE PIPE:

1. ALL PRESSURE PIPE SHALL BE GIVEN A HYDROSTATIC TEST OF AT LEAST 1.5 TIMES THE SHUTOFF HEAD OF THE CONNECTED PUMPS OR 150 PSI WHICHEVER IS GREATER. LOSS OF WATER PRESSURE DURING TEST SHALL NOT EXCEED 5 PSI IN A 2 HOUR PERIOD.
2. WHERE PRACTICABLE, PIPELINES SHALL BE TESTED BETWEEN LINE VALVES OR PLUGS IN LENGTHS OF NOT MORE THAN 1500 FEET.
3. THE PIPE SHALL BE SLOWLY FILLED WITH WATER AND THE SPECIFIED TEST PRESSURE SHALL BE APPLIED BY MEANS OF A PUMP CONNECTED TO THE PIPE. IF PERMANENT AIR VENTS ARE NOT LOCATED AT ALL HIGH POINTS, THE CONTRACTOR SHALL INSTALL CORPORATION COCKS AT SUCH POINTS SO THE AIR CAN BE EXPELLED AS THE LINE IS FILLED WITH WATER. AFTER ALL THE AIR HAS EXPELLED, THE CORPORATION OF COCKS SHALL BE CLOSED AND THE TEST PRESSURE APPLIED.
4. DURATION OF TEST SHALL NOT EXCEED LESS THAN TWO HOURS.
5. THE TEST PRESSURE SHALL NOT EXCEED THE RATED PRESSURE OF VALVES IN PIPELINE.

6. WHERE LEAKS ARE VISIBLE AT EXPOSED JOINTS AND/OR EVIDENT ON THE SURFACE WHERE JOINTS ARE COVERED, THE CONTRACTOR SHALL REPAIR THE JOINTS, RETIGHTEN THE BOLTS, RELAY THE PIPE, OR REPLACE THE PIPE UNTIL THE LEAK IS ELIMINATED REGARDLESS OF TOTAL LEAKAGE AS SHOWN BY THE HYDROSTATIC TEST. ENCASEMENT DAMAGED FROM REPAIRS MUST ALSO BE PROPERLY REPAIRED OR REPLACE TO THE SATISFACTION OF THE OWNER.
7. ALL PIPE FITTINGS AND OTHER MATERIAL FOUND TO BE DEFECTIVE UNDER TEST SHALL BE REMOVED AND REPLACED AT THE CONTRACTORS EXPENSE.
8. LINES THAT FAIL TO MEET TEST REQUIREMENTS SHALL BE REPAIRED AND RETESTED AS NECESSARY UNTIL TEST REQUIREMENTS ARE COMPLIED WITH.
9. NO PIPE INSTALLATION WILL BE ACCEPTED IF THE LEAKAGE IS GREATER THAN THAT DETERMINED BY THE FORMULA IN WHICH L IS THE ALLOWABLE LEAKAGE, IN GALLONS PER HOUR; S IS THE LENGTH OF PIPELINE TESTED, IN FEET; D IS THE NOMINAL DIAMETER OF THE PIPE, IN INCHES; AND P IS THE AVERAGE TEST PRESSURE DURING THE LEAKAGE TEST, IN POUNDS PER SQUARE INCH GAUGE. ALLOWABLE LEAKAGE FOR 4" PRESSURE PIPE @ 150 PSI IS 0.33 GPH PER 1000 FEET OF PIPE TESTED.

NOTES:

CONCRETE VALVE VAULT SHALL BE 60"x60"x48" WITH STANDARD SEWER RING AND COVER AS MANUFACTURED BY PETERSON CONCRETE TANK COMPANY.

MANHOLE ASSEMBLY SHALL BE HEAVY DUTY CAST IRON MANHOLE PRODUCT NO. 00134801 AS MANUFACTURED BY EAST JORDAN IRON WORKS, INC.

GATE VALVE SHALL BE 4" NRS RESILIENT WEDGE GATE VALVE AS MANUFACTURED MY MUELLER MODEL NO. P-2361-20.

AIR RELIEF VALVE SHALL BE THERMALLY PROTECTED D-040 ST ST 2" AS MANUFACTURED BY ARI.

BORING AND TRENCHING SHALL FOLLOW CORP OF ENGINEERS GUIDELINES AND PERMIT.

CONTRACTOR SHALL EMPLOY A LAND SURVEYOR LICENSED IN THE STATE OF ARKANSAS TO MAP THE BOTTOM OF EXISTING RIVER BED AT BORE LOCATION

CONTRACTOR SHALL PROVIDE AN ACCURATE AS BUILT DRAWING WITH GPS COORDINATES OF VALVE BOXES, STEEL CASING START AND STOPPING LOCATIONS AND ELEVATION PROFILE OF PRESSURIZED SEWER PIPE DEPTH IN RELATION TO EXISTING RIVER BED.