

ARKANSAS STATE HIGHWAY AND TRANSPORTATION DEPARTMENT

INTER OFFICE MEMORANDUM

March 16, 2017

TO: Master Files

FROM: *JF* John Fleming, Division Head, Environmental Division *hfnice*

SUBJECT: AHTD Job Number 061500
FAP Number NHPP-0062(43)
Creek at L.M. 4.65 Str. & Apprs. (S)
Saline County
Tier 2 Categorical Exclusion

The Environmental Division has reviewed the referenced project and it falls within the definition of a Tier 2 Categorical Exclusion under 23 Code of Federal Regulations, Section 771.117, and the AHTD/FHWA Memorandum of Agreement on the processing of Categorical Exclusions. A public hearing will not be offered for this project.

The purpose of this project is to replace a structurally deficient box culvert over an unnamed stream on Highway 5 in Saline County, Arkansas. The total length of the project is approximately 0.26 mile. A project location map is attached.

The existing 14' x 4' x 45' single box culvert will be replaced on existing location with a new 7' x 4' x 106' double box culvert. No detour will be used, and Highway 5 will be closed for a short period during the replacement. The existing approaches consist of two 11-foot wide travel lanes with 4-foot wide paved shoulders. The new approaches will consist of two 12-foot wide travel lanes with 8-foot wide paved shoulders. The existing right of way width is 60 feet, and the new right of way width will be 123 feet. Approximately 0.42 acre of new right of way will be acquired.

Design data for this project is as follows:

Design Year	Average Daily Traffic	Percent Trucks	Design Speed
2017	11,000	3	45 mph
2037	15,000	3	45 mph

Construction of the new box culvert will impact less than 0.1 acre of waters of the United States. Construction should be covered under the terms of a Nationwide Permit 14 for Linear Transportation Crossings as defined in Federal Register 82(4):1860-2008.

No endangered species, environmental justice issues, hazardous waste deposits, prime farmland, relocatees, protected waters, or underground storage tanks are associated with this project. A floodplain permit will not be required. Cultural resource impacts are not anticipated; concurrence from the State Historic Preservation Officer is attached.

Based upon the AHTD's *Policy on Highway Traffic Noise Abatement*, a noise analysis is not required for this project. The project meets the criteria for a Type III project established in 23 CFR 772. Therefore, the project requires no analysis for highway traffic noise impacts. Type III projects do not involve added capacity, construction of new through lanes or auxiliary lanes, changes in the horizontal or vertical alignment of the roadway, or exposure of noise sensitive land uses to a new or existing highway noise source. AHTD acknowledges that a noise analysis is required if changes to the proposed project result in reclassification to a Type I project.

Attachments:

Project Location Map
SHPO Clearance
Environmental Study Checklist
Design Sheet

Approved:



Kevin Thornton
Assistant Chief Engineer-Planning

JF:MP:fc

c: Program Management
Right of Way
Roadway Design
District 6
FHWA
Master File

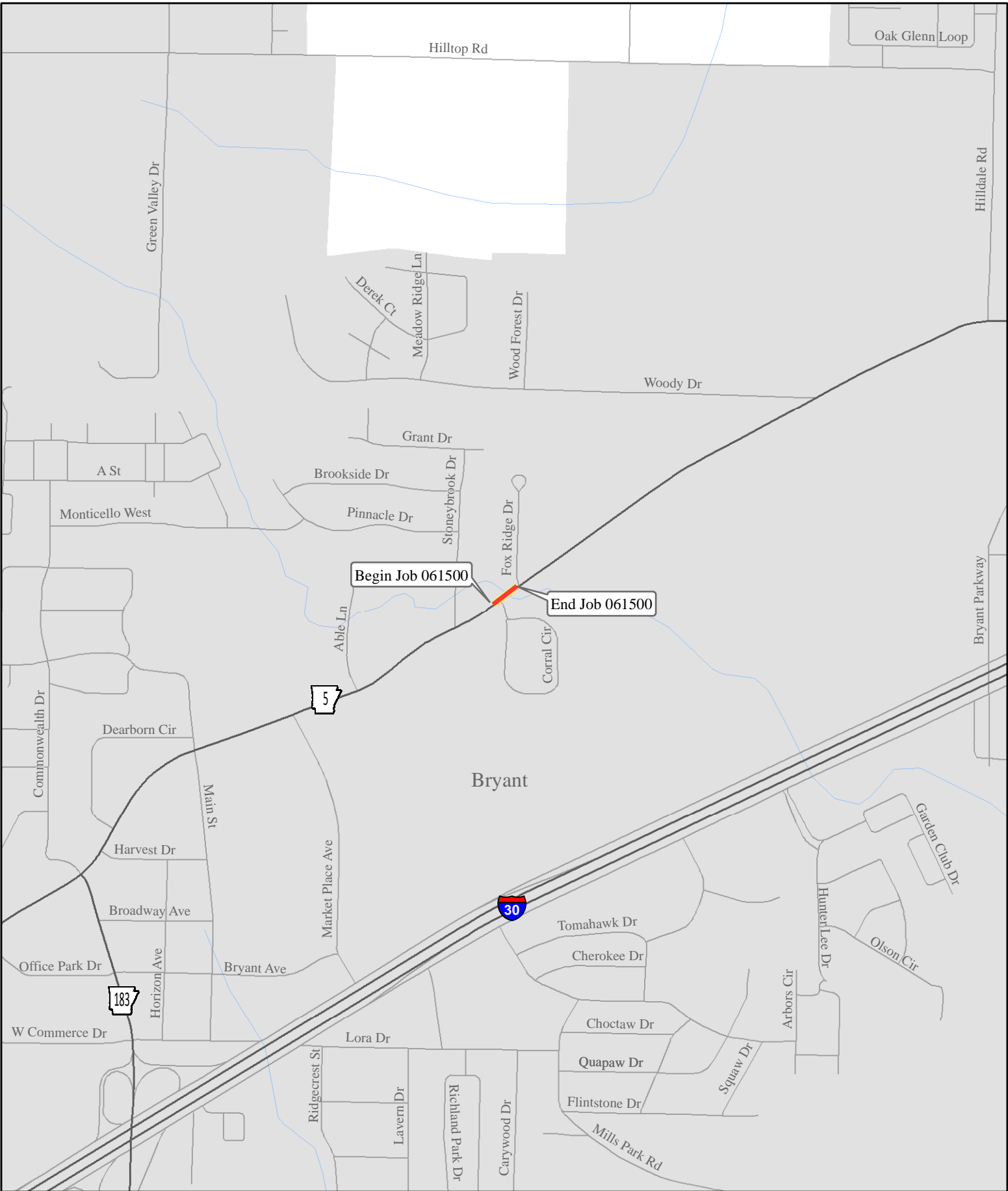

Begin Job 061500

End Job 061500

5

183

Bryant

30

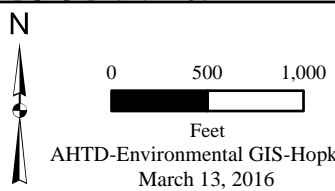

Job 061500
Creek at L.M. 4.65
Str. & Apprs. (Hwy. 5)
Saline County

 Project Location

AHPP

DEC 13 2016

96729.41
FHWA

ARKANSAS STATE HIGHWAY
AND
TRANSPORTATION DEPARTMENT

Scott E. Bennett, P. E.
Director
Telephone (501) 569-2000
Voice/TTY 711



P.O. Box 2261
Little Rock, Arkansas 72203-2261
Telefax (501) 569-2400
www.arkansashighways.com

December 12, 2016

Ms. Frances McSwain
Arkansas Historic Preservation Program
1100 North Street
Little Rock, Arkansas 72201

Re: AHTD Job Number 061500
Creek at L.M. 4.65 Str. & Apprs. (S)
Saline County

Dear Ms. McSwain:

A Project Identification Form for the referenced project is enclosed. Please review for concurrence with the findings of my staff. If you have any questions or require additional information, please contact Scott Smallwood of my staff at 501-569-2038.

Sincerely,

John Fleming
Division Head
Environmental Division

Enclosure
PIF

JF:DW:CSS:ym

RECEIVED
AHTD
DEC 21 2016
ENVIRONMENTAL
DIVISION

Date DEC 15 2016

No known historic properties will be affected by this undertaking. This effect determination could change should new information come to light.

Frances McSwain, Deputy State
Historic Preservation Officer

DEC 15 2016

AHTD ENVIRONMENTAL IMPACTS ASSESSMENT FORM

AHTD Job Number 061500 FAP Number NHPP-0062(43)
 Job Title Creek at L.M. 4.65 Str. & Apprs. (S)

Environmental Impacts	None	Minor	Significant	Comments
Air Quality	X			
Construction Impacts		X		Temporary
Cultural Resources	X			
Economic	X			
Endangered Species	X			
Energy Resources	X			
Environmental Justice/Title VI	X			
Fish and Wildlife	X			
Floodplains	X			
Forest Service Property	X			
Hazardous Materials/Landfills	X			
Land Use Impacts	X			
Migratory Birds	X			
Navigation/Coast Guard	X			
Noise Levels	X			
Prime Farmland	X			
Protected Waters	X			
Public Recreation Lands	X			
Public Water Supply/WHPA	X			
Relocates	X			
Section 4(f)/6(f)	X			
Social	X			
Underground Storage Tanks	X			
Visual Impacts	X			
Stream Impacts		X		NW 14 Sect. 404 Permit
Water Quality		X		Temporary during construction
Wetlands	X			
Wildlife Refuges	X			

Section 401 Water Quality Certification Required? No
 Short-term Activity Authorization Required? No
 Section 404 Permit Required? Yes Type NW14

Remarks: _____

Signature of Evaluator May Pearson Date 3-16-17

ROADWAY DESIGN REQUESTJob Number 061500 FAP No. NHPP-0062(43) County SalineJob Name Creek at L.M. 4.65 Str. & Apprs. (S)Design Engineer Stephen Sichmeller Environmental Staff _____Brief Project Description Replacement of a box culvert.

A. Existing Conditions:

Roadway Width: 22' Shoulder Type/Width: Paved / 4'Number of Lanes and Width: 2 @ 11' Proposed Right-of-Way: 60'Sidewalks? No Location: _____ Width: _____Bike Lanes? No Location: _____ Width: _____

B. Proposed Conditions:

Roadway Width: 24' Shoulder Type/Width: Paved / 8'Number of Lanes and Width: 2 @ 12' Proposed Right-of-Way: 123'Sidewalks? No Location: _____ Width: _____Bike Lanes? No Location: _____ Width: _____

C. Construction Information:

If detour: Where: N/A Length: N/A

D. Design Traffic Data:

2017 ADT: 11000 2037 ADT: 15000 % Trucks: 3
Design Speed: 45 m.p.h.E. Approximate total length of project: 0.026 mile(s)F. Justification for proposed improvements: Box culvert is structurally deficient.G. Total Relocates: 0 Residences: 0 Businesses: 0H. Have you coordinated with any outside agencies (e.g., FHWA, City, County, etc.)? Yes

Agency/Official	Person Contacted	Date
City of Bryant	Mark Grimmatt	2-9-17

ARKANSAS STATE HIGHWAY
AND
TRANSPORTATION DEPARTMENT

Scott E. Bennett, P.E.
Director
Telephone (501) 569-2000
Voice/TTY 711



P.O. Box 2261
Little Rock, Arkansas 72203-2261
Telefax (501) 569-2400
www.arkansashighways.com

April 10, 2017

Ms. M. Elaine Edwards
Chief, Regulatory Division
Little Rock District Corps of Engineers
P.O. Box 867
Little Rock, AR 72203-0867

RE: AHTD Job Number 061500
Creek at L.M. 4.65 Str. & Apprs. (S)
Saline County

Dear Ms. Edwards:

Enclosed are the Categorical Exclusion and supporting materials for construction of the referenced project. The proposed AHTD project will replace an existing single 14' x 4' x 45' box culvert on an unnamed tributary (intermittent) of Crooked Creek with a new double 7' x 4' x 106' box culvert on existing location. During construction approximately 100 feet of the stream will be realigned to accommodate for the new box culvert. Construction of this project will impact less than 0.1 acre of waters of the United States. No wetlands will be impacted.

The proposed project will not impact Federal or State lands, National or State wild or scenic rivers, or Extraordinary Resource/Ecologically Sensitive water bodies. The AHTD must design all projects to comply with FEMA-approved regulatory floodplain ordinances.

Please review this project for concurrence that construction can proceed under terms of a Nationwide Permit 14. If additional information is required, please contact Clint Hutcherson or Josh Seagraves of my staff at 569-2282.

Sincerely,

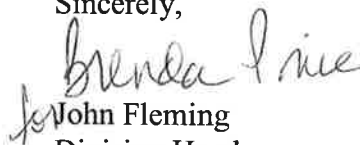
John Fleming
Division Head
Environmental Division

Enclosures

Categorical Exclusion
Supporting Illustrations
Proposed Construction Plans

JF:JS:CH:ym

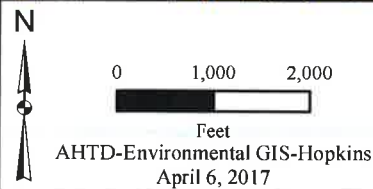
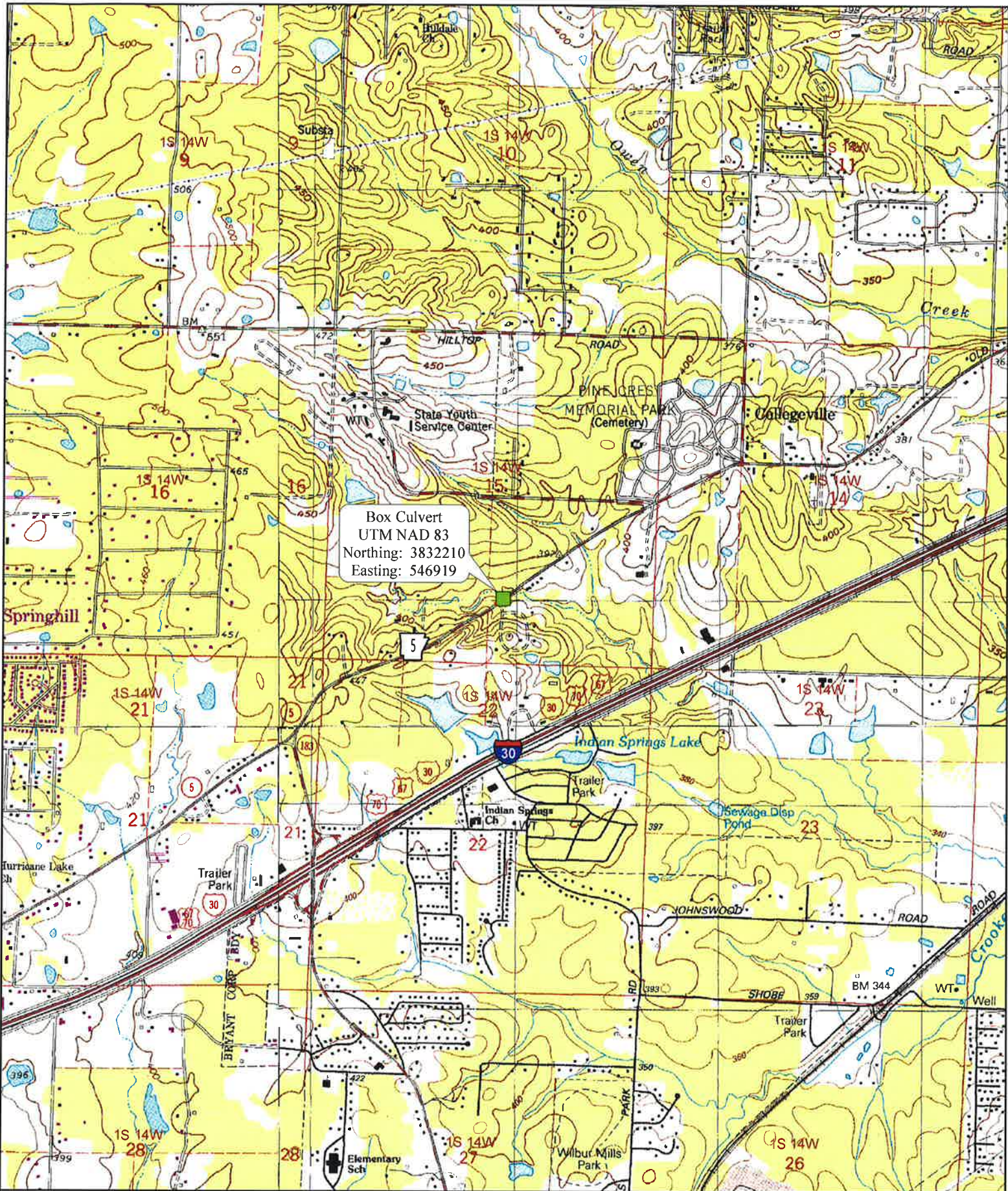

Job 061500
 Creek at L.M. 4.65
 Str. & Apprs. (Hwy. 5)
 Saline County

 Project Location

USGS Topographic Map
 Alexander 1988

ARKANSAS STATE HIGHWAY AND TRANSPORTATION DEPARTMENT
CONSTRUCTION PLANS FOR STATE HIGHWAY

DATE REVISED	DATE PLANNED	DATE REVISED	DATE PLANNED	FED. DIST. NO.	STATE	FED. AID PROJ. NO.	SHEET NO.	TOTAL SHEETS
				6	ARK.			
				JOB NO.		061500		

2 CREEK AT L.M. 4.65 STR. & APPRS. (S)

CREEK AT L.M. 4.65
STR. & APPRS. (S)

SALINE COUNTY
ROUTE 5 SECTION 8

FEDERAL AID PROJ. NHPP-0062(43)

JOB 061500

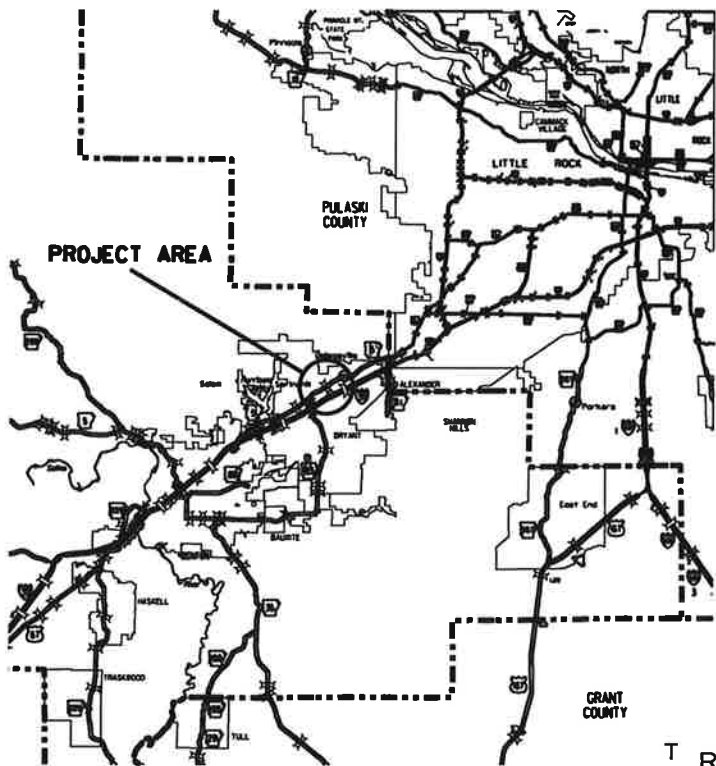

VICINITY MAP



ARK. HWY. DIST. NO. 6

DESIGN TRAFFIC DATA

DESIGN YEAR	2037
2017 ADT	11000
2037 ADT	15000
2037 DHV	1650
DIRECTIONAL DISTRIBUTION	0.60
TRUCKS	3%
DESIGN SPEED	45 MPH

STRUCTURES OVER 20'-0" DATA

- 1 STA. 109+96 CONSTRUCT DBL. 7' x 4' x 106' R.C. BOX ON 45° RT. FWD. SKEW WITH 3:1 WINGS LT. AND RT. Q50 = 649 CFS; D.A. = 2240 ACRES SPAN = 24'-1 3/4"

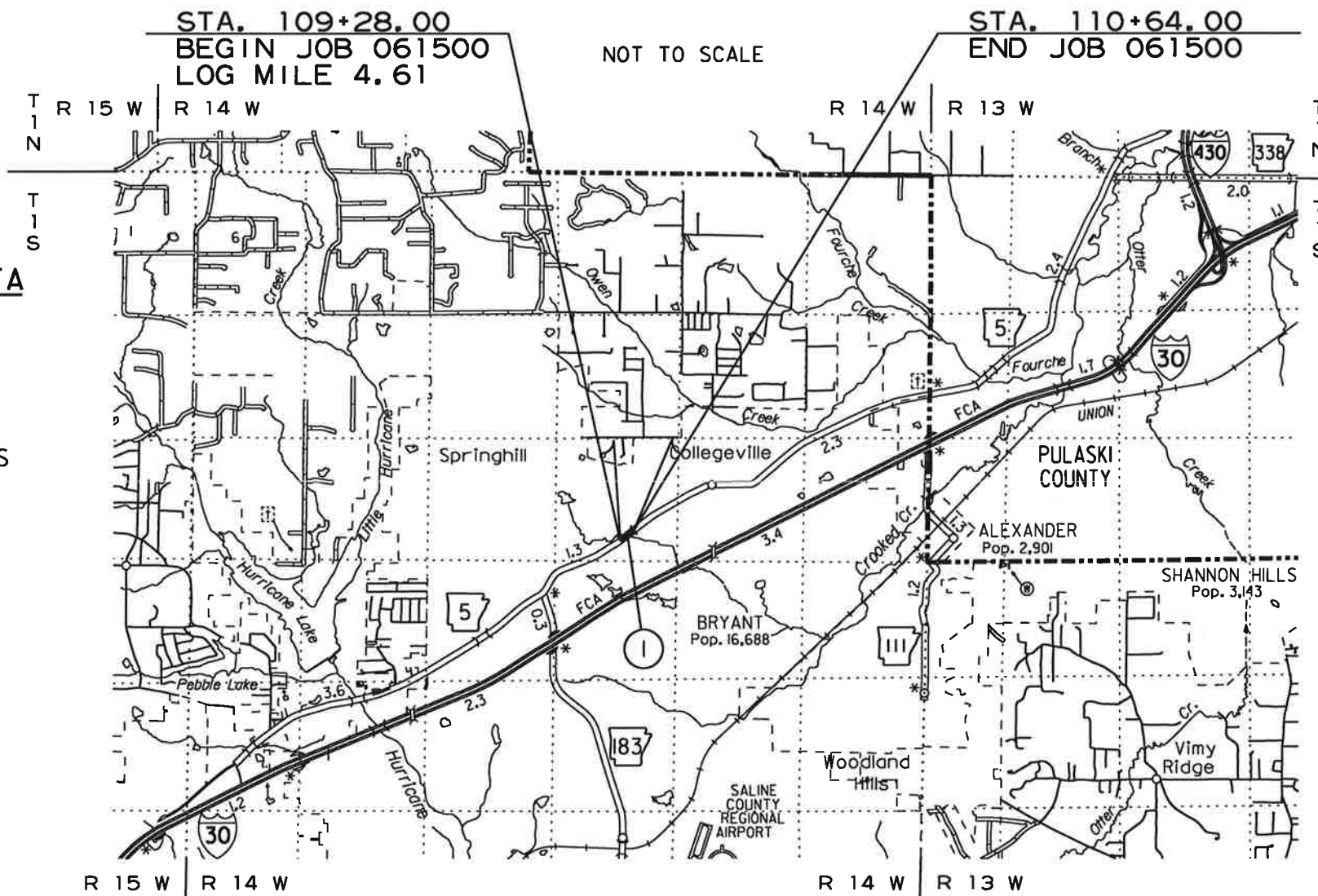

PRELIMINARY
SUBJECT TO REVISION

	BEGIN PROJECT	MID-POINT OF PROJECT	END PROJECT
LATITUDE	N 34°37' 50"	N 34°37' 51"	N 34°37' 51"
LONGITUDE	W 92°29' 18"	W 92°29' 18"	W 92°29' 17"

LENGTH OF PROJECT CALCULATED ALONG C.L.			
GROSS LENGTH OF PROJECT	136.00	FEET OR	0.026 MILES
NET ROADWAY	111.85		0.021 MILES
NET BRIDGES	24.15		0.005 MILES
NET PROJECT	136.00		0.026 MILES

DATE REVISED	DATE FILMED	DATE REVISED	DATE FILMED	FED. DIST. NO.	STATE	FED. AID PROJ. NO.	SHEET NO.	TOTAL SHEETS
				6	ARK.			
JOB NO. 061500								

2 PLAN AND PROFILE SHEETS

PRELIMINARY
SUBJECT TO REVISION

*Less than 0.1 acre
water of U.S.*

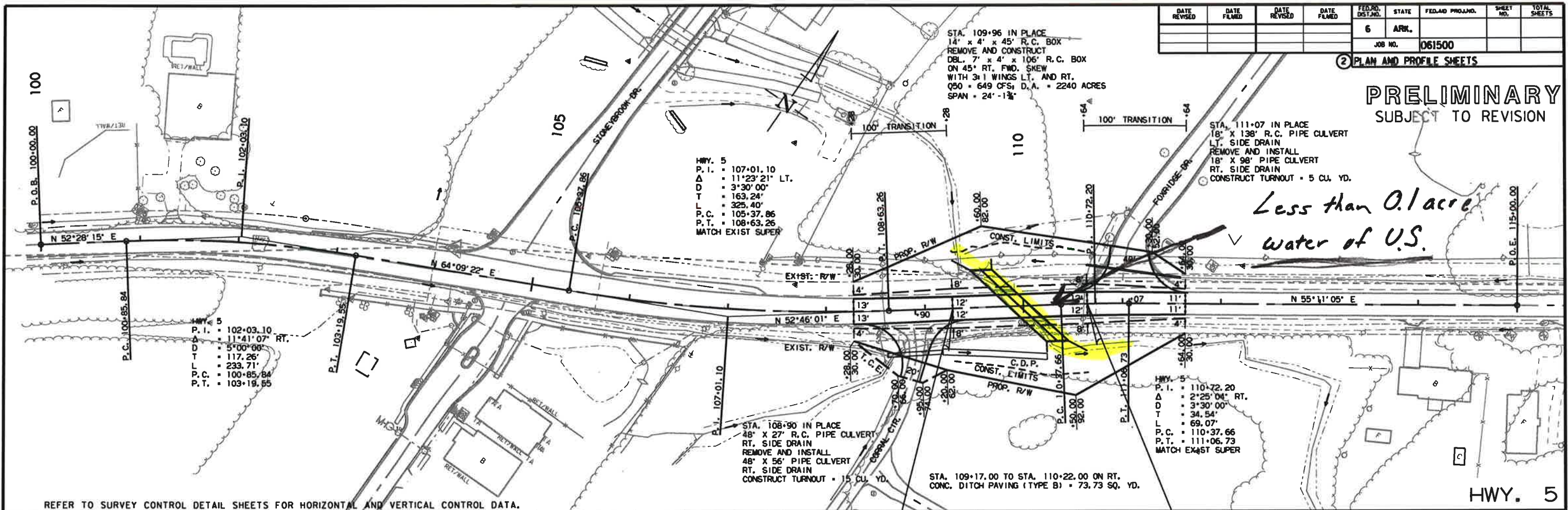

REFER TO SURVEY CONTROL DETAIL SHEETS FOR HORIZONTAL AND VERTICAL CONTROL DATA.

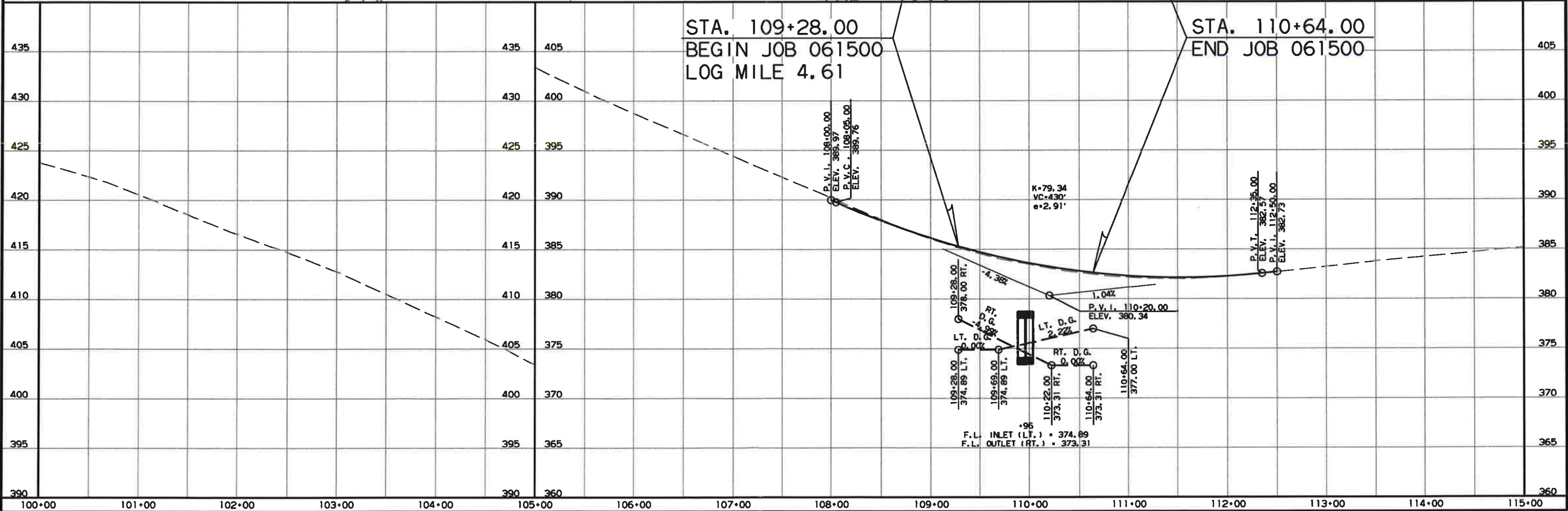

2/16/2017 R061500.DGN

DATE REVISED	DATE FLUED	DATE REVISED	DATE FLUED	FED. DIST. NO.	STATE	FED. AID PROJ. NO.	SHEET NO.	TOTAL SHEETS
				6	ARR.			
				JOB NO.		061500		

② CROSS SECTIONS

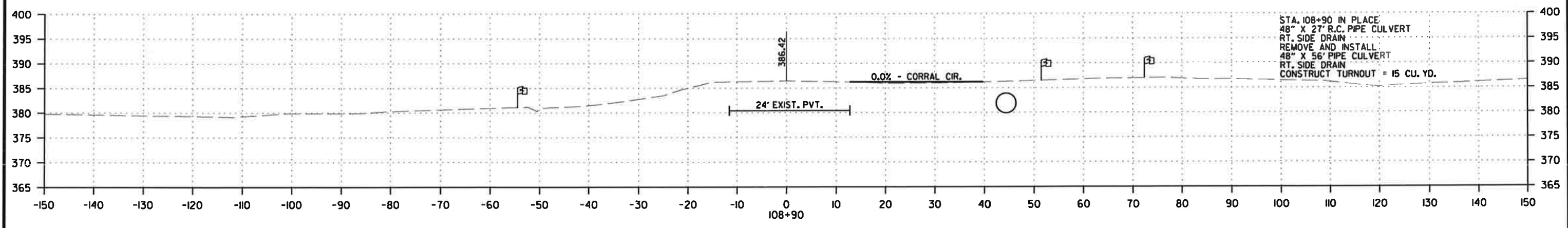
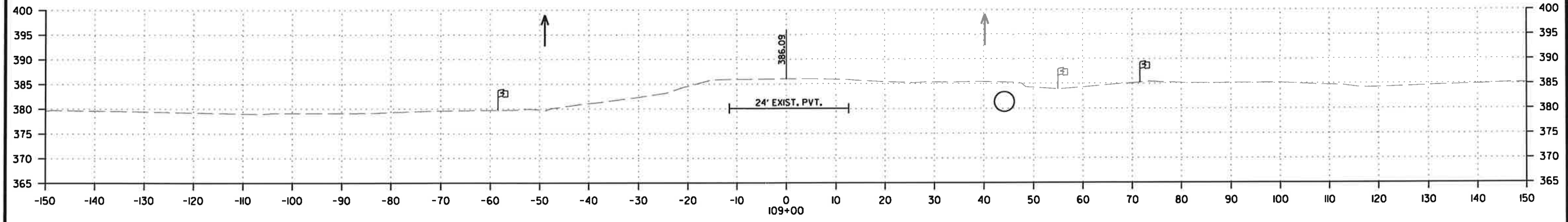

STA. 108+90 IN PLACE
48" X 27" R.C. PIPE CULVERT
RT. SIDE DRAIN
REMOVE AND INSTALL
48" X 56" PIPE CULVERT
RT. SIDE DRAIN
CONSTRUCT TURNOUT = 15 CU. YD.

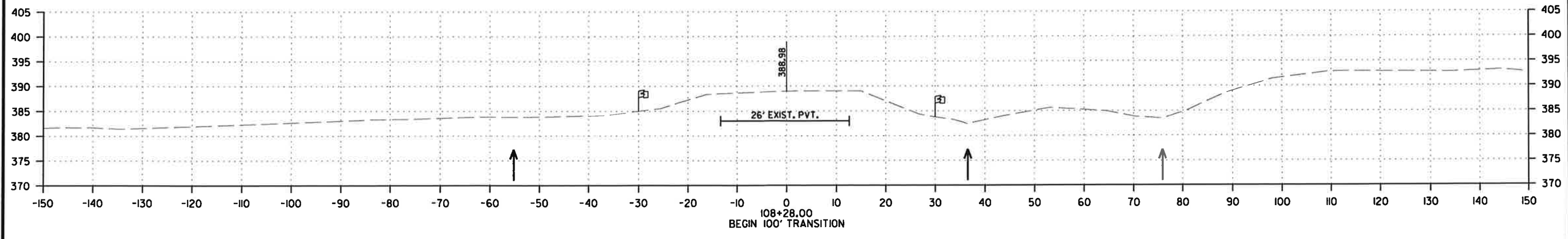

STA. 108+28 TO STA. 109+00

2/16/2017
R061500.DGN

DATE REVISED	DATE FILMED	DATE REVISED	DATE FILMED	FED. DIST. NO.	STATE	FED. AID PROJ. NO.	SHEET NO.	TOTAL SHEETS
				6	ARK.			
						JOB NO.	061500	

2 CROSS SECTIONS

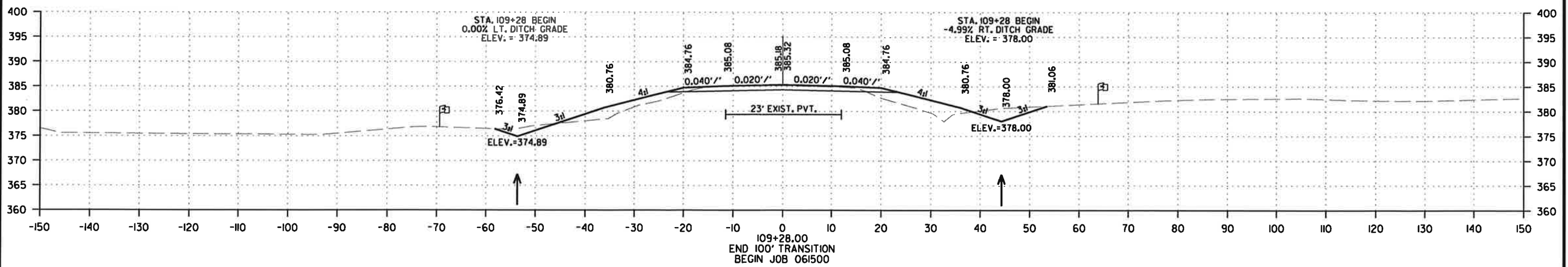
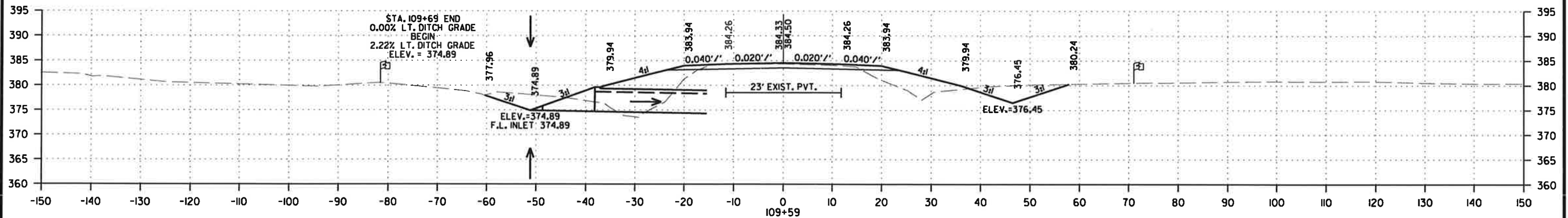
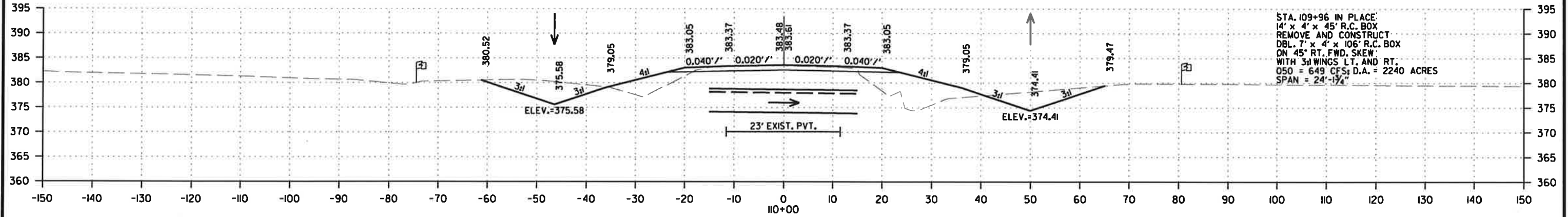

STA. 109+28 TO STA. 110+00

2/16/2017

R061500.DGN

DATE REVISED	DATE FILMED	DATE REVISED	DATE FILMED	FED. DIST. NO.	STATE	FED. AID PROJ. NO.	SHEET NO.	TOTAL SHEETS
				6	ARK.			
						JOB NO.	061500	

② CROSS SECTIONS

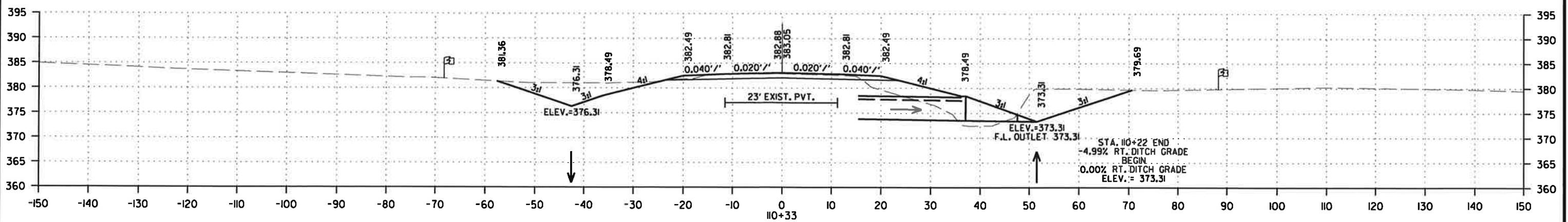
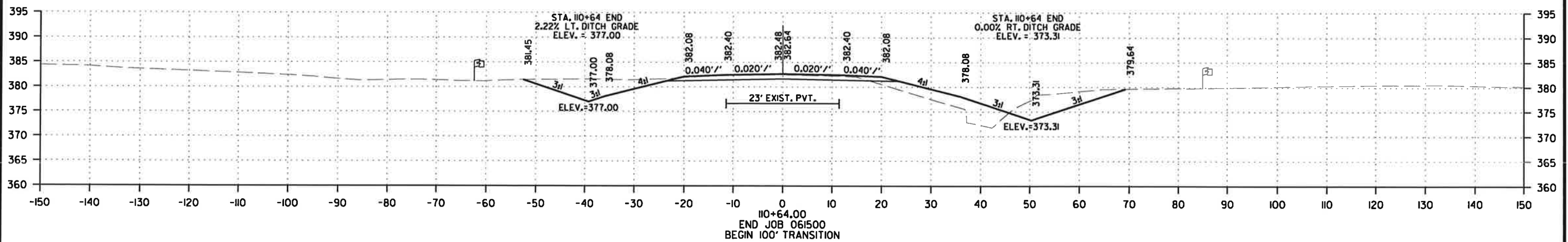
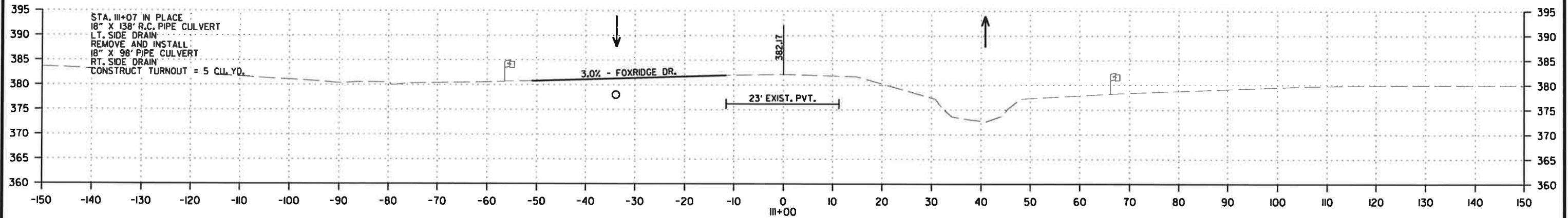

STA. II0+33 TO STA. III+00

2/16/2017
R061500.DGN