

# INDEX

- 1 ST
- 2 ND
- 3 RD
- 4 TH
- 5 TH
- 6 TH
- 7 TH
- 8 TH
- 9 TH
- 10 TH
- 11 TH
- 12 TH
- 13 TH
- 14 TH
- 15 TH
- ACCO DR
- AMBROSE
- ANDERSON
- BARRIER
- CALHOUN
- CHESTER
- CLAIBORNE
- CLAIRE
- COURT HOUSE SQ
- CURRAN
- DRIER RD
- EOFF CONDEN RD
- ERWIN
- FAIRGROUND RD
- GORDON
- HAMILTON
- HICKORY
- MAIN
- MAOMA
- MAPLE
- MARION
- MULBERRY
- NORMAN DR
- OAK
- PIKE
- PIKE
- RIDOUT
- RIDOUT DR
- WALLS
- WHIPOORWILL
- WILLOW
- WILSON

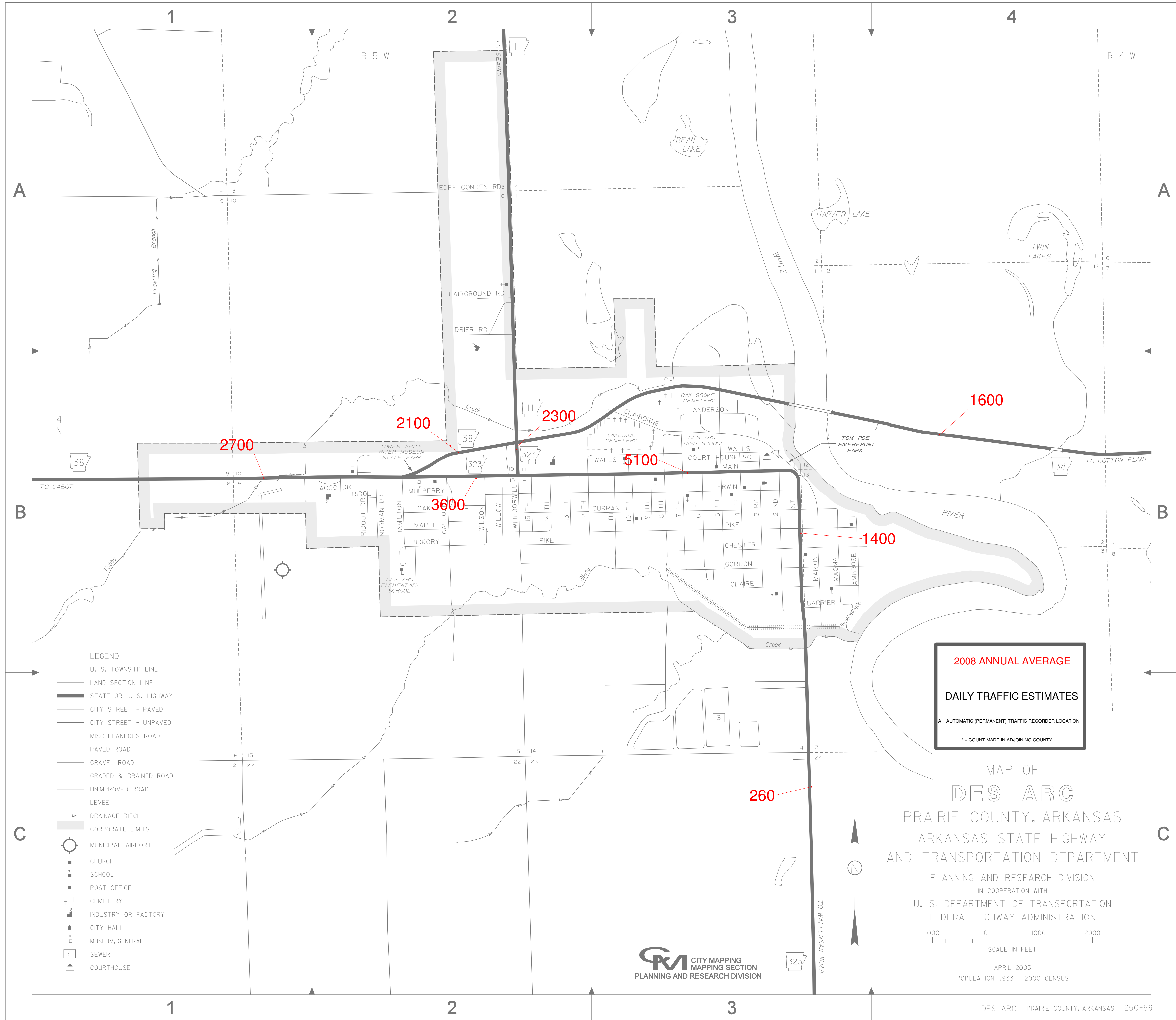

### LEGEND

- U. S. TOWNSHIP LINE
- LAND SECTION LINE
- STATE OR U. S. HIGHWAY
- CITY STREET - PAVED
- CITY STREET - UNPAVED
- MISCELLANEOUS ROAD
- PAVED ROAD
- GRAVEL ROAD
- GRADED & DRAINED ROAD
- UNIMPROVED ROAD
- ⋯ LEVEE
- DRAINAGE DITCH
- CORPORATE LIMITS
- MUNICIPAL AIRPORT
- ⊕ CHURCH
- ⊠ SCHOOL
- ⊠ POST OFFICE
- + CEMETERY
- ⊠ INDUSTRY OR FACTORY
- ⊠ CITY HALL
- ⊠ MUSEUM, GENERAL
- ⊠ SEWER
- ⊠ COURTHOUSE

**2008 ANNUAL AVERAGE**  
**DAILY TRAFFIC ESTIMATES**  
A = AUTOMATIC (PERMANENT) TRAFFIC RECORDER LOCATION  
\* = COUNT MADE IN ADJOINING COUNTY

MAP OF  
**DES ARC**  
 PRAIRIE COUNTY, ARKANSAS  
 ARKANSAS STATE HIGHWAY  
 AND TRANSPORTATION DEPARTMENT  
 PLANNING AND RESEARCH DIVISION  
 IN COOPERATION WITH  
 U. S. DEPARTMENT OF TRANSPORTATION  
 FEDERAL HIGHWAY ADMINISTRATION



APRIL 2003  
 POPULATION 1,933 - 2000 CENSUS

**CM** CITY MAPPING  
 MAPPING SECTION  
 PLANNING AND RESEARCH DIVISION