

INDEX

- 3 RD AVE
- "A"
- AIRPORT RD
- ARNOLD
- ASH
- "B"
- BAILEY
- BEMIS
- BRYANT
- "C"
- CALE RD
- CALE RD
- CEDAR
- CORNELIUS
- DALTON AVE
- DE ANN
- 2 ND N
- 2 ND S
- 3 RD S
- 4 TH N
- 4 TH S
- 5 TH N
- 5 TH S
- 6 TH N
- 6 TH S
- 7 TH N
- 8 TH S
- CHESTNUT
- ELM
- FIRST N
- FIRST S
- HAZEL
- LAUREL
- MAIN
- OLIVE
- PINE
- ROSS
- VINE
- WALNUT
- ELIZABETH
- FAIR GROUNDS RD
- FLEMING AVE
- FRIAR TUCK
- GARLAND
- GE
- GREENLAWN
- GULLEY
- HALE AVE
- HALE DR
- HALE LN
- HALL
- HATLEY AVE
- HAYS
- HIGHMEADOW
- HINDS BLVD
- HOLLY
- JAMES
- JONES
- JOYCE
- KATHRYN
- MANOR RD
- MARR
- MARION RD
- MARTIN
- MILL
- MOCKINGBIRD LN
- MONCRIEF
- MONSON
- MOORE HWY
- MYRTLE
- NOTTINGHAM
- OAK
- OAK GROVE
- OZAN AVE
- PEARL AVE
- PECAN
- POWELL
- RIDGEWOOD RD
- ROLLING HILL
- ROSTON RD
- SCHOOL
- SCOTT
- SECTION LINE AVE
- SHERWOOD DR
- STEWART RD
- VICKS AVE
- W 2 ND
- W 2 ND N
- W 2 ND S
- W 3 RD
- W 3 RD N
- W 3 RD S
- W CHESTNUT
- W ELM
- W FIRST
- W FIRST S
- W HAZEL
- W LAUREL
- W MAIN
- W MAIN
- W OLIVE
- W PINE
- W VINE
- W WALNUT
- WARREN
- WASHINGTON RD
- WEBB
- WHITESIDE
- WILDCAT RD
- WILSON

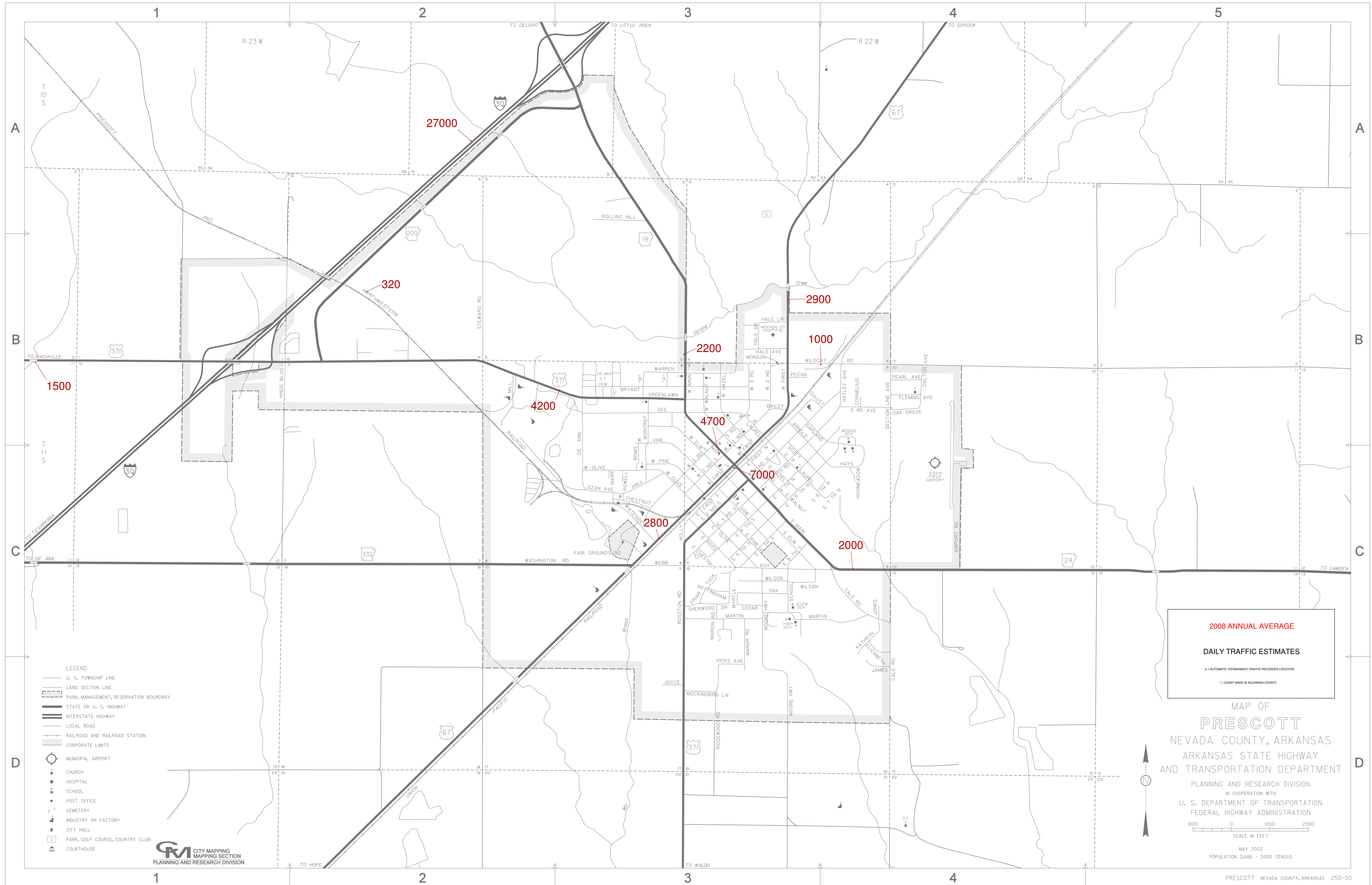

- LEGEND**
- U. S. TOWNSHIP LINE
 - LAND SECTION LINE
 - PARK, MANAGEMENT, RESERVATION BOUNDARY
 - STATE OR U. S. HIGHWAY
 - INTERSTATE HIGHWAY
 - LOCAL ROAD
 - RAILROAD AND RAILROAD STATION
 - CORPORATE LIMITS
 - MUNICIPAL AIRPORT
 - CHURCH
 - HOSPITAL
 - SCHOOL
 - POST OFFICE
 - CEMETERY
 - INDUSTRY OR FACTORY
 - CITY HALL
 - PARK, GOLF COURSE, COUNTRY CLUB
 - COURTHOUSE

2008 ANNUAL AVERAGE
DAILY TRAFFIC ESTIMATES
A - AUTOMATIC (PERMANENT) TRAFFIC RECORDER LOCATION
* - COUNT MADE IN ADJACENT COUNTY

MAP OF
PRESCOTT
NEVADA COUNTY, ARKANSAS
ARKANSAS STATE HIGHWAY
AND TRANSPORTATION DEPARTMENT
PLANNING AND RESEARCH DIVISION
IN COOPERATION WITH
U. S. DEPARTMENT OF TRANSPORTATION
FEDERAL HIGHWAY ADMINISTRATION

SCALE IN FEET
1000 0 1000 2000
MAY 2002
POPULATION 3,686 - 2000 CENSUS

