

INDEX

- ANGELO DR B-3
- ASH A-4
- BARBERS B-3
- BEVERLY B-1
- BURROW RD A-4
- CAIN DR A-3
- CHESTNUT B-2
- CHURCH A-4
- DAVID B-3
- E EIGHTH B-3
- FIFTH B-3
- FOURTH B-3
- MAIN B-3
- SECOND B-2
- SEVENTH A-3
- SIXTH A-3
- THIRD B-2
- E THIRD B-3
- EDMONDS AVE B-3
- EDMONDS AVE B-3
- ELIZABETH B-3
- ELLIS B-3
- ETHEL B-3
- FRONT B-1
- HOLDER RD B-3
- JACKSON A-3
- JEFFERY B-1
- JOHNSON A-3
- KIMBERLY DR A-3
- MAIN B-1
- MICHAEL B-3
- MILL B-3
- MULLEN B-3
- OAK B-3
- OLIVE B-2
- PALM A-4
- PEACOCK B-3
- PINE B-1
- PINE B-1
- PINE B-2
- POLAR B-3
- RAILROAD B-3
- RANEY AVE B-3
- RAYMOND CIR B-4
- REEVES B-3
- REYNOLDS DR B-3
- RIPLEY B-3
- S MAPLE B-3
- SEAMAN B-3
- STEARNS B-3
- TARPLEY B-3
- TAYLOR A-3
- TAYLOR CIR B-3
- THOMPSON B-3
- THOMPSON AVE B-3
- W FOURTH B-3
- W FOURTH B-3
- W MAIN B-3
- W SECOND B-1
- W SECOND B-1
- W THIRD B-1
- W THIRD B-1
- WADE B-3
- WENDY B-1

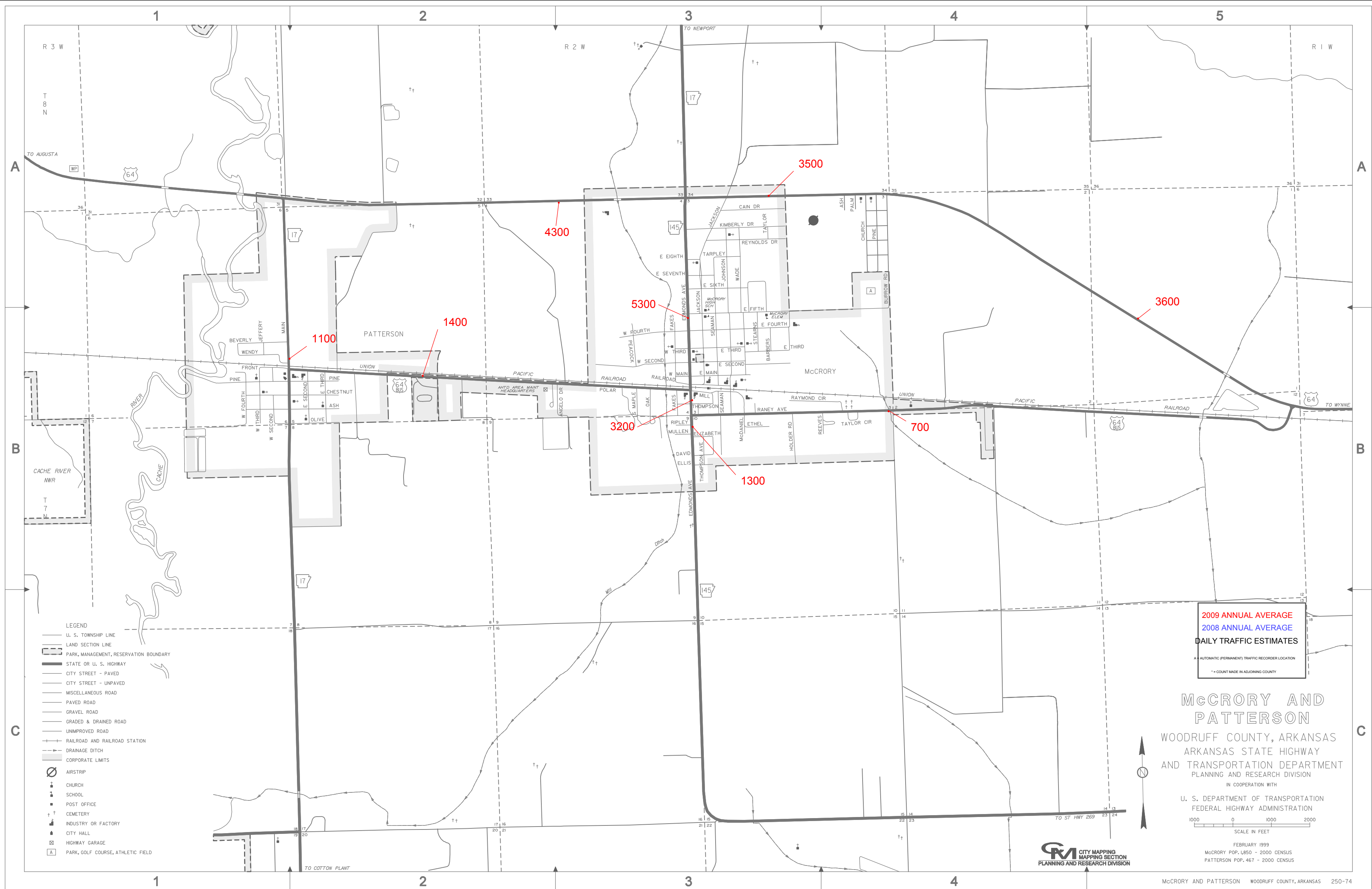

- LEGEND**
- U. S. TOWNSHIP LINE
 - LAND SECTION LINE
 - PARK, MANAGEMENT, RESERVATION BOUNDARY
 - STATE OR U. S. HIGHWAY
 - CITY STREET - PAVED
 - CITY STREET - UNPAVED
 - MISCELLANEOUS ROAD
 - PAVED ROAD
 - GRAVEL ROAD
 - GRADED & DRAINED ROAD
 - UNIMPROVED ROAD
 - RAILROAD AND RAILROAD STATION
 - DRAINAGE DITCH
 - CORPORATE LIMITS
 - AIRSTRIIP
 - CHURCH
 - SCHOOL
 - POST OFFICE
 - CEMETERY
 - INDUSTRY OR FACTORY
 - CITY HALL
 - HIGHWAY GARAGE
 - PARK, GOLF COURSE, ATHLETIC FIELD

2009 ANNUAL AVERAGE
2008 ANNUAL AVERAGE
DAILY TRAFFIC ESTIMATES

A AUTOMATIC PERMANENT TRAFFIC RECORDER LOCATION
 ** COUNTY MADE IN ADJACENT COUNTY

McCRORY AND PATTERSON
 WOODRUFF COUNTY, ARKANSAS
 ARKANSAS STATE HIGHWAY
 AND TRANSPORTATION DEPARTMENT
 PLANNING AND RESEARCH DIVISION

IN COOPERATION WITH
 U. S. DEPARTMENT OF TRANSPORTATION
 FEDERAL HIGHWAY ADMINISTRATION

FEBRUARY 1999
 McCRORY POP. 1,850 - 2000 CENSUS
 PATTERSON POP. 467 - 2000 CENSUS

SCALE IN FEET
 1000 0 1000 2000

