

# INDEX

- APPLE ORCHARD B-2
- ASH B-2
- BERGMAN B-3
- BERGMAN/ZINC RD C-2
- DANIELS RD B-3
- DEGRAW B-2
- FLORENCE B-2
- LEROY LN B-2
- MAIN E B-3
- MAIN W B-2
- MISSOURI AVE A-2
- MISSOURI AVE B-2
- MISSOURI AVE B-3
- NORTHWEST B-2
- OAK B-3
- PACE AVE B-3
- PANTHER DR B-2
- PAULINE LN B-2
- PECAN LN B-2
- SCHOOL VIEW DR B-2
- SORRELL B-2
- SORRELL B-3
- SOUTHWEST C-2
- STEVEN B-2
- VINE B-3
- WASHINGTON B-3
- YORK CEMETERY DR A-1
- YORK DR B-2

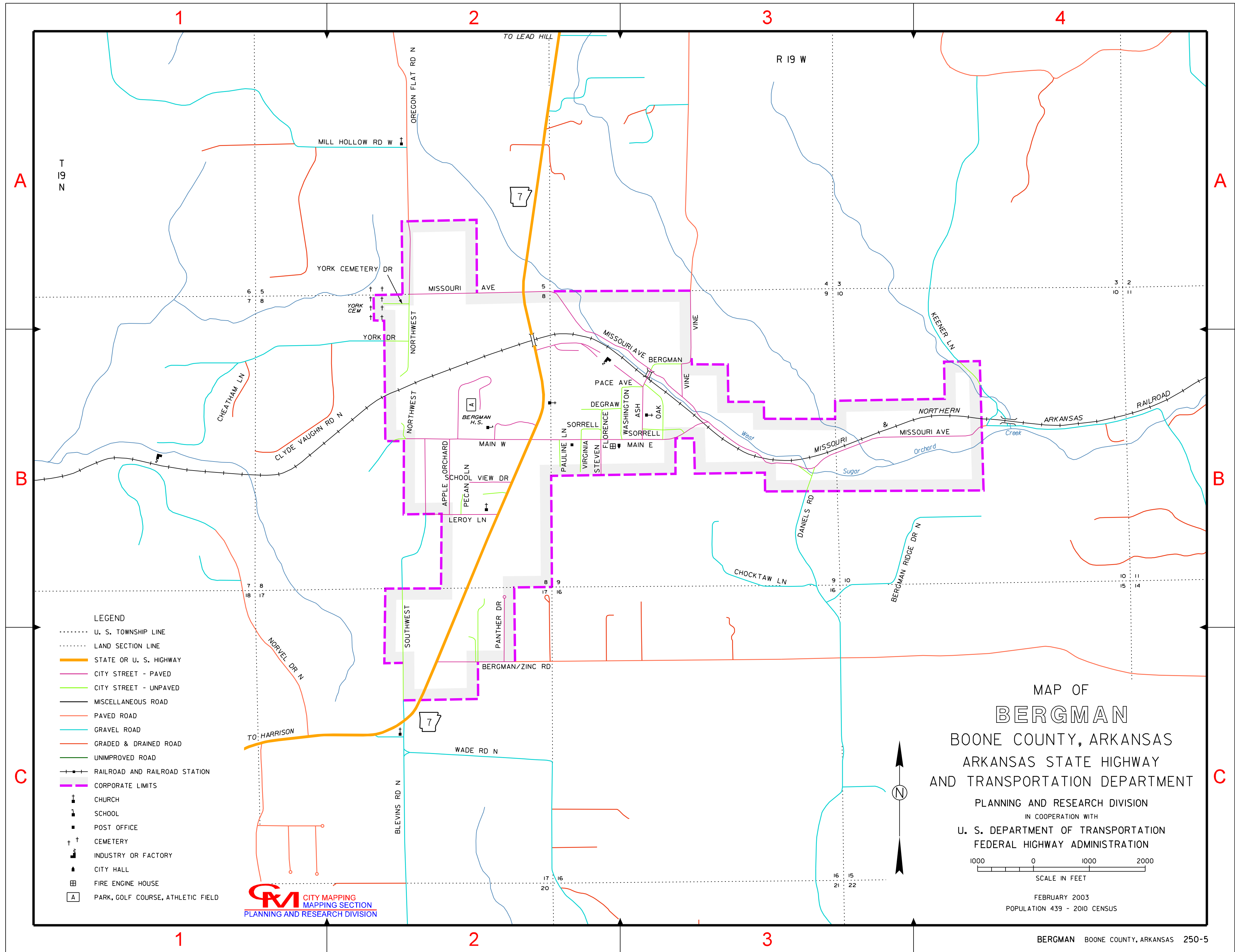

- LEGEND**
- ..... U. S. TOWNSHIP LINE
  - ..... LAND SECTION LINE
  - STATE OR U. S. HIGHWAY
  - CITY STREET - PAVED
  - CITY STREET - UNPAVED
  - MISCELLANEOUS ROAD
  - PAVED ROAD
  - GRAVEL ROAD
  - GRADED & DRAINED ROAD
  - UNIMPROVED ROAD
  - +—+ RAILROAD AND RAILROAD STATION
  - +—+ CORPORATE LIMITS
  - † CHURCH
  - ▩ SCHOOL
  - POST OFFICE
  - †† CEMETERY
  - INDUSTRY OR FACTORY
  - ▲ CITY HALL
  - FIRE ENGINE HOUSE
  - ▭ PARK, GOLF COURSE, ATHLETIC FIELD

**MAP OF**  
**BERGMAN**  
 BOONE COUNTY, ARKANSAS  
 ARKANSAS STATE HIGHWAY  
 AND TRANSPORTATION DEPARTMENT  
 PLANNING AND RESEARCH DIVISION  
 IN COOPERATION WITH  
 U. S. DEPARTMENT OF TRANSPORTATION  
 FEDERAL HIGHWAY ADMINISTRATION

1000 0 1000 2000  
 SCALE IN FEET

FEBRUARY 2003  
 POPULATION 439 - 2010 CENSUS

