

INDEX

ALLEN AVE	B-2
BARRETT	A-2
CHURCH	B-2
COLEMAN AVE	B-2
COURT	A-2
E BURNS AVE	A-2
E ROGERS AVE	A-2
E SAN FRANCISCO AVE	A-2
HOLIGATE	B-2
N GREGG	A-2
N MAIN	A-2
S GREGG	A-2
S MAIN	B-2
W BURNS AVE	A-2
W ROGERS AVE	A-2
W SAN FRANCISCO AVE	A-2
WALTON AVE	B-2

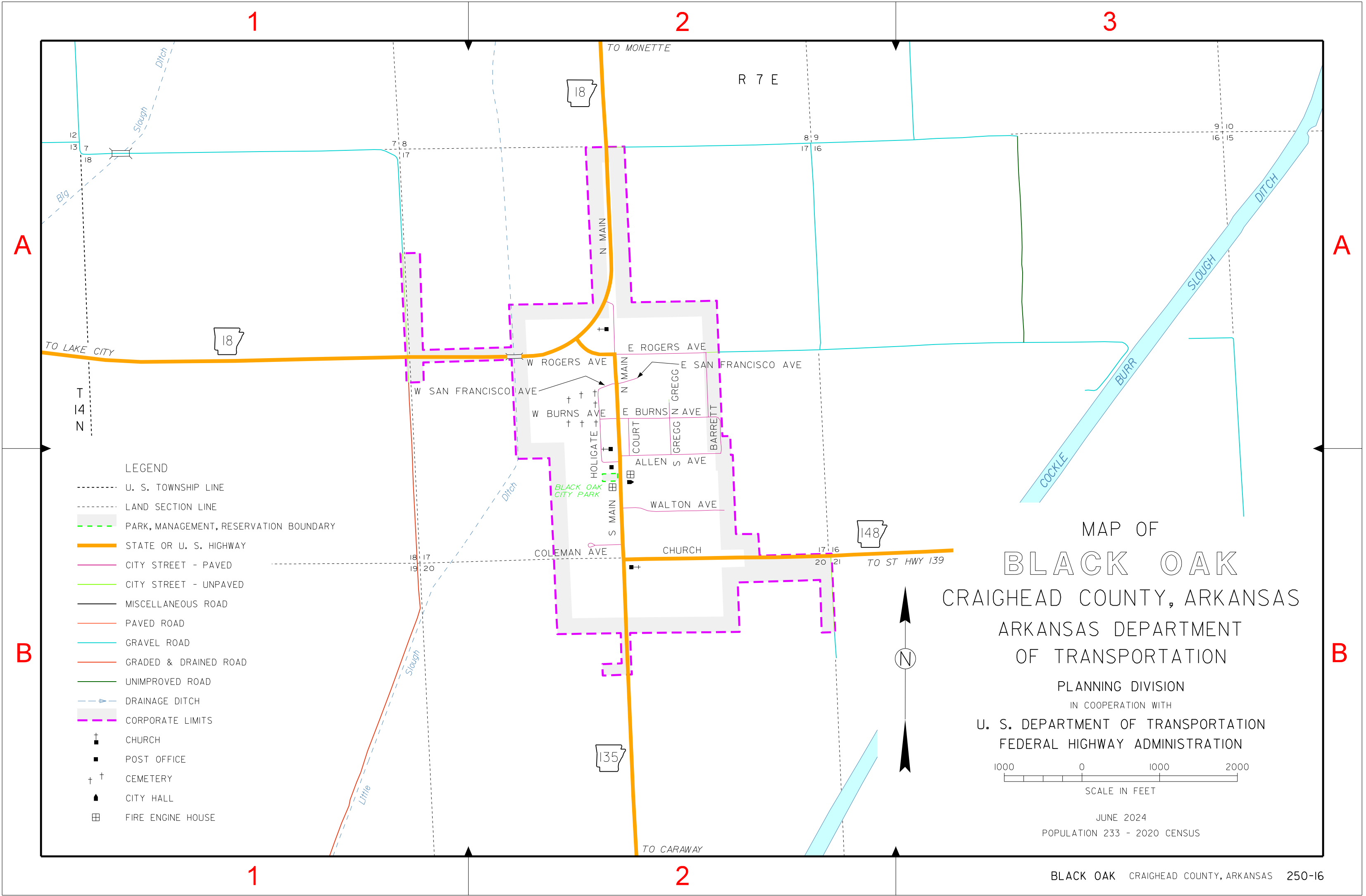

LEGEND

- U. S. TOWNSHIP LINE
- LAND SECTION LINE
- - - - - PARK, MANAGEMENT, RESERVATION BOUNDARY
- STATE OR U. S. HIGHWAY
- CITY STREET - PAVED
- CITY STREET - UNPAVED
- MISCELLANEOUS ROAD
- PAVED ROAD
- GRAVEL ROAD
- GRADED & DRAINED ROAD
- UNIMPROVED ROAD
- >—— DRAINAGE DITCH
- - - - - CORPORATE LIMITS
- † CHURCH
- POST OFFICE
- † † CEMETERY
- ▲ CITY HALL
- ▣ FIRE ENGINE HOUSE

MAP OF
BLACK OAK
 CRAIGHEAD COUNTY, ARKANSAS
 ARKANSAS DEPARTMENT
 OF TRANSPORTATION

PLANNING DIVISION
 IN COOPERATION WITH
 U. S. DEPARTMENT OF TRANSPORTATION
 FEDERAL HIGHWAY ADMINISTRATION



JUNE 2024
 POPULATION 233 - 2020 CENSUS