

INDEX

- ASHER LN
- BOWEN AVE
- CANNON
- CEMETERY RD
- CHICAGO AVE
- COLLIER DR
- DALLAS AVE
- DEAN AVE
- E KENTUCKY
- E STATE
- E TENNESSEE
- JENNINGS DR
- KELLY DR
- LEIGH AVE
- LYNN AVE
- MEMPHIS AVE
- N SAN FRANCISCO AVE
- N NEW YORK AVE
- PAYNE
- REDBUD CR
- S SAN FRANCISCO AVE
- SCHOOL
- ST LOUIS
- TUCKER
- W ILLINOIS
- W STATE
- W TENNESSEE
- WACO AVE

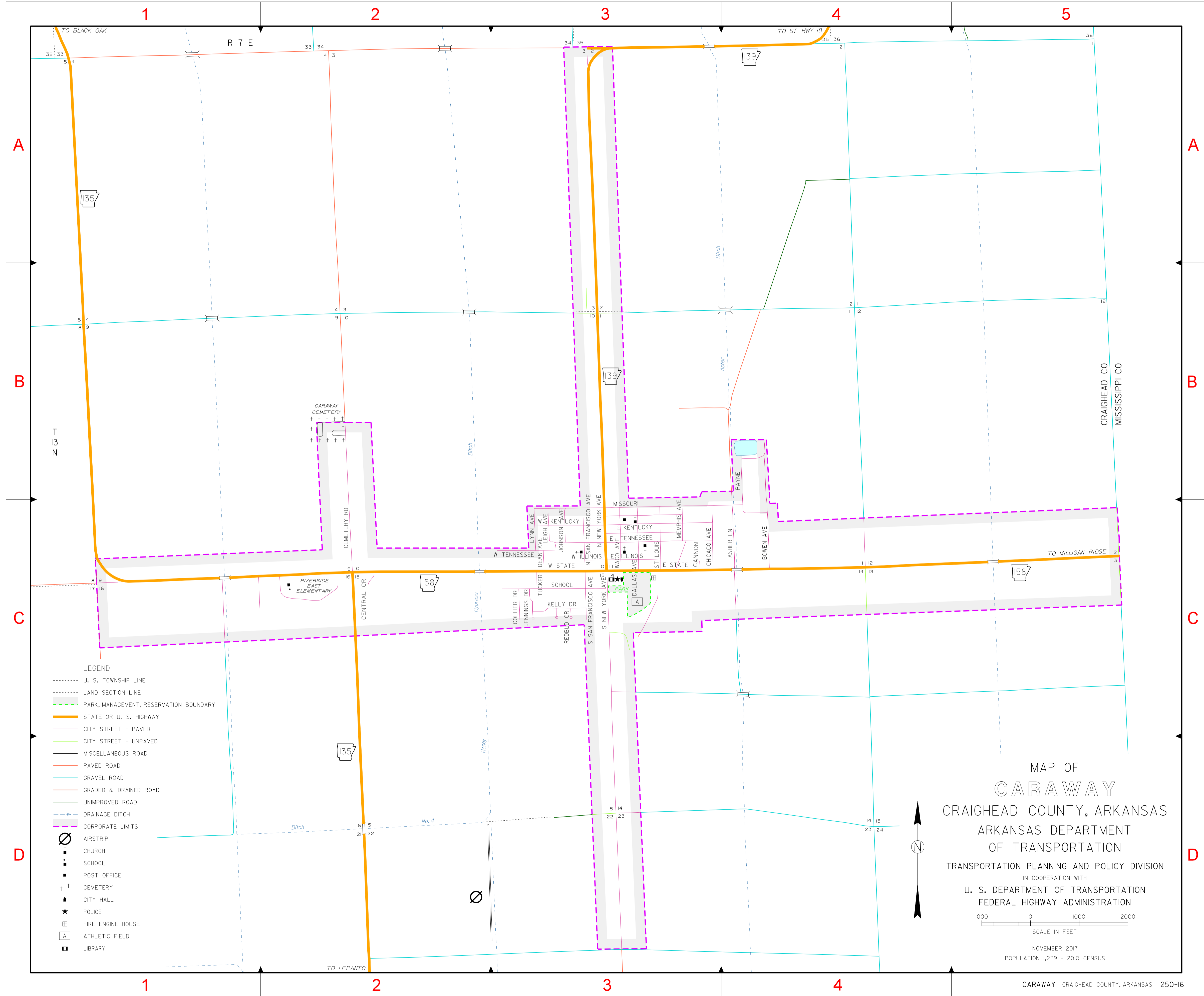

- LEGEND**
- U. S. TOWNSHIP LINE
 - LAND SECTION LINE
 - PARK, MANAGEMENT, RESERVATION BOUNDARY
 - STATE OR U. S. HIGHWAY
 - CITY STREET - PAVED
 - CITY STREET - UNPAVED
 - MISCELLANEOUS ROAD
 - PAVED ROAD
 - GRAVEL ROAD
 - GRADED & DRAINED ROAD
 - UNIMPROVED ROAD
 - DRAINAGE DITCH
 - CORPORATE LIMITS
 - ⊘ AIRSTRIP
 - ⊕ CHURCH
 - ⊕ SCHOOL
 - ⊕ POST OFFICE
 - + † CEMETERY
 - ⊕ CITY HALL
 - ★ POLICE
 - ⊕ FIRE ENGINE HOUSE
 - ⊕ ATHLETIC FIELD
 - ⊕ LIBRARY

MAP OF
CARAWAY
 CRAIGHEAD COUNTY, ARKANSAS
 ARKANSAS DEPARTMENT
 OF TRANSPORTATION
 TRANSPORTATION PLANNING AND POLICY DIVISION
 IN COOPERATION WITH
 U. S. DEPARTMENT OF TRANSPORTATION
 FEDERAL HIGHWAY ADMINISTRATION

1000 0 1000 2000
 SCALE IN FEET
 NOVEMBER 2017
 POPULATION 1,279 - 2010 CENSUS