

INDEX

- BEASLEY B-5
- BOWERS A-5
- BROCKET B-5
- CARWELL CR B-5
- CLEMENTS C-5
- DEXTER C-5
- DYE C-5
- E. SIFFORD AVE C-5
- FLENTJE DR C-4
- HALK AVE C-4
- LACE B-5
- MAPLE DR B-5
- MARTIN DR B-5
- N RAILROAD B-5
- NANCY CR B-5
- NEWSOME AVE B-5
- PITTS C-4
- S COOPER C-5
- S RAILROAD B-5
- STARK B-5
- STUBBS C-5
- THUNDERBIRD LN C-5
- TOOD C-5
- W SIFFORD AVE C-5
- WALLS C-5
- WALNUT AVE C-5
- WALNUT EXT C-4
- WHITE DR B-5
- WOODHAM DR B-5

- LEGEND**
- U. S. TOWNSHIP LINE
 - LAND SECTION LINE
 - PARK, MANAGEMENT, RESERVATION BOUNDARY
 - STATE OR U. S. HIGHWAY
 - CITY STREET - PAVED
 - CITY STREET - UNPAVED
 - MISCELLANEOUS ROAD
 - GRAVEL ROAD
 - GRADED & DRAINED ROAD
 - UNIMPROVED ROAD
 - RAILROAD AND RAILROAD STATION
 - DRAINAGE DITCH
 - CORPORATE LIMITS
 - AIRSTRIIP
 - CHURCH
 - SCHOOL
 - POST OFFICE
 - CEMETERY
 - INDUSTRY OR FACTORY
 - CITY HALL
 - POLICE
 - FIRE ENGINE HOUSE
 - ATHLETIC FIELD, SEWER
 - LIBRARY

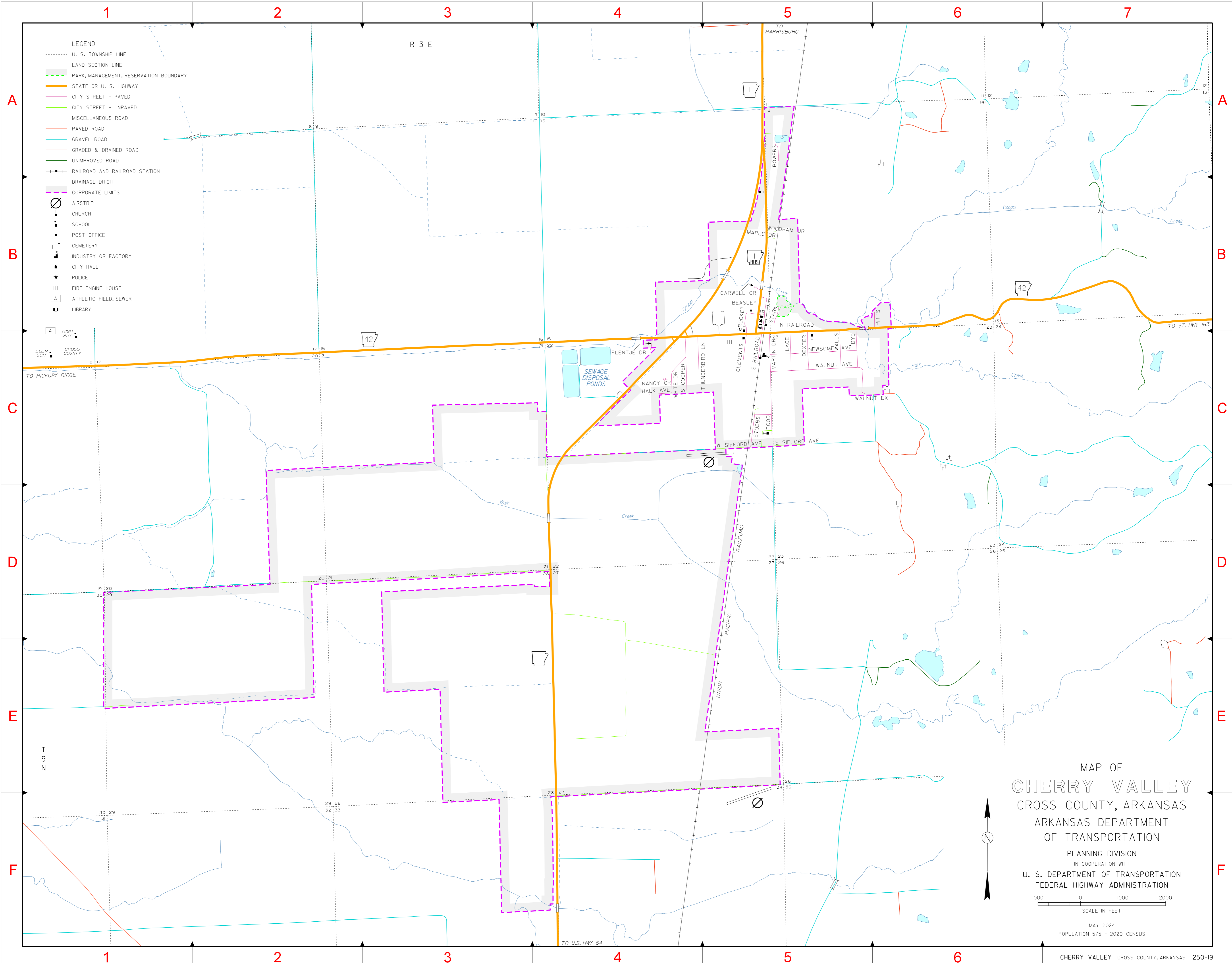

MAP OF
CHERRY VALLEY
 CROSS COUNTY, ARKANSAS
 ARKANSAS DEPARTMENT
 OF TRANSPORTATION
 PLANNING DIVISION
 IN COOPERATION WITH
 U. S. DEPARTMENT OF TRANSPORTATION
 FEDERAL HIGHWAY ADMINISTRATION



MAY 2024
 POPULATION 575 - 2020 CENSUS