

# INDEX

2 ND	B-2
2 ND	B-3
3 RD	B-2
4 TH	A-2
4 TH	A-3
5 TH	A-2
ASH	B-2
BEECH	B-2
CEDAR	A-2
CHURCH	A-2
ELM	B-3
FIRST	B-2
FIRST	B-3
GUM	B-3
OAK	B-3
SOUTH	B-2

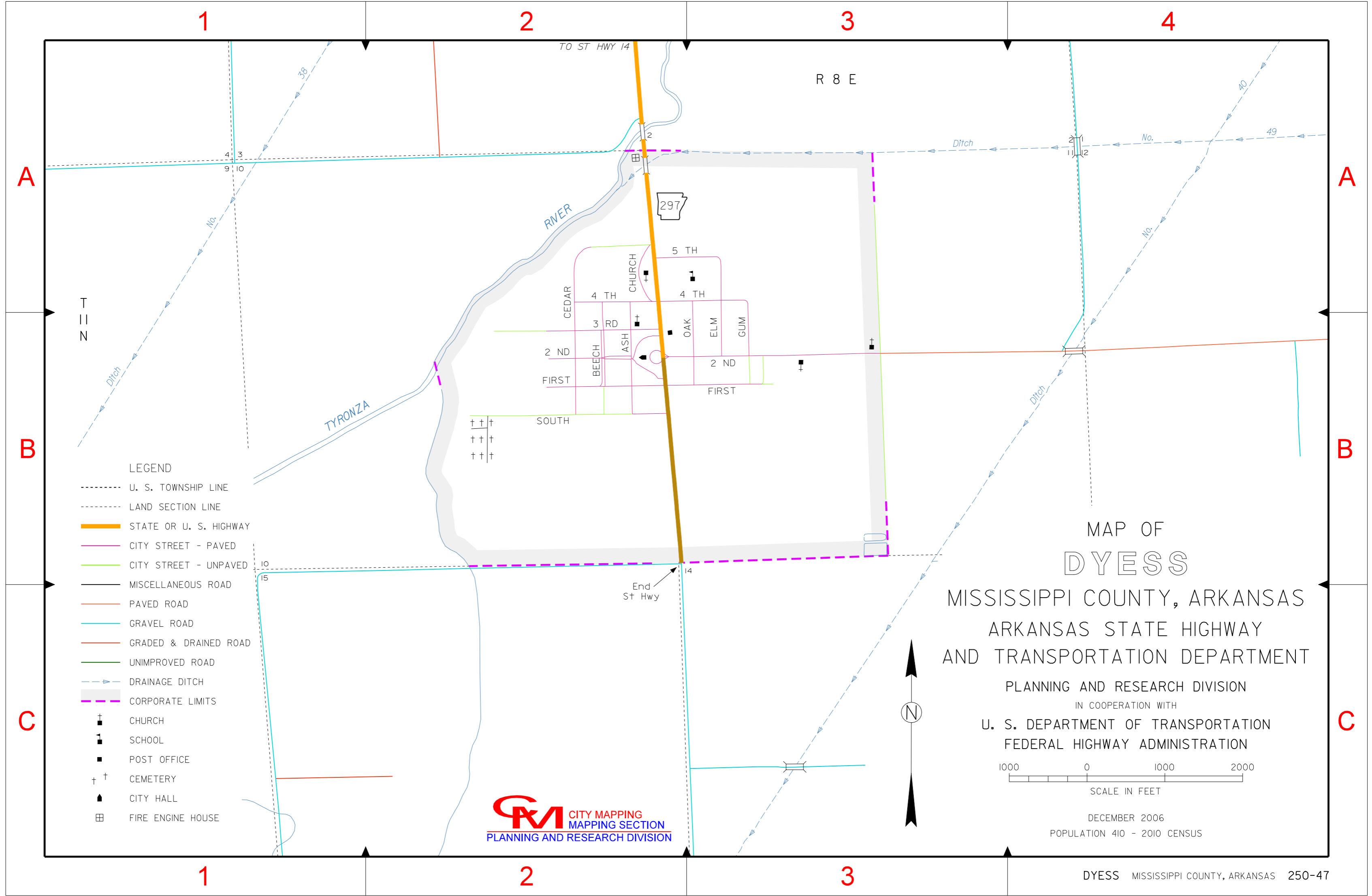

- LEGEND**
- U. S. TOWNSHIP LINE
  - LAND SECTION LINE
  - STATE OR U. S. HIGHWAY
  - CITY STREET - PAVED
  - CITY STREET - UNPAVED
  - MISCELLANEOUS ROAD
  - PAVED ROAD
  - GRAVEL ROAD
  - GRADED & DRAINED ROAD
  - UNIMPROVED ROAD
  - > DRAINAGE DITCH
  - CORPORATE LIMITS
  - † CHURCH
  - ⌚ SCHOOL
  - POST OFFICE
  - †† CEMETERY
  - ▲ CITY HALL
  - ⊞ FIRE ENGINE HOUSE

MAP OF  
**DYESS**  
MISSISSIPPI COUNTY, ARKANSAS  
ARKANSAS STATE HIGHWAY  
AND TRANSPORTATION DEPARTMENT

PLANNING AND RESEARCH DIVISION  
IN COOPERATION WITH  
U. S. DEPARTMENT OF TRANSPORTATION  
FEDERAL HIGHWAY ADMINISTRATION



DECEMBER 2006  
POPULATION 410 - 2010 CENSUS

