

INDEX

- CANEY RD B-3
- CEMETERY LP B-3
- CHERRY B-3
- CHURCH B-3
- CROSS B-3
- FISHER DR B-3
- FOWLER DR B-3
- GARRETT B-3
- HARPER SHEEHY RD B-4
- HORSESHOE LN B-3
- JACKSON DR B-4
- LEWELLEN B-3
- MALVERN RD B-4
- OAK B-3
- PARK B-3
- RIVER B-3
- SCHOOL B-3
- SEALY B-3
- WOOD B-4

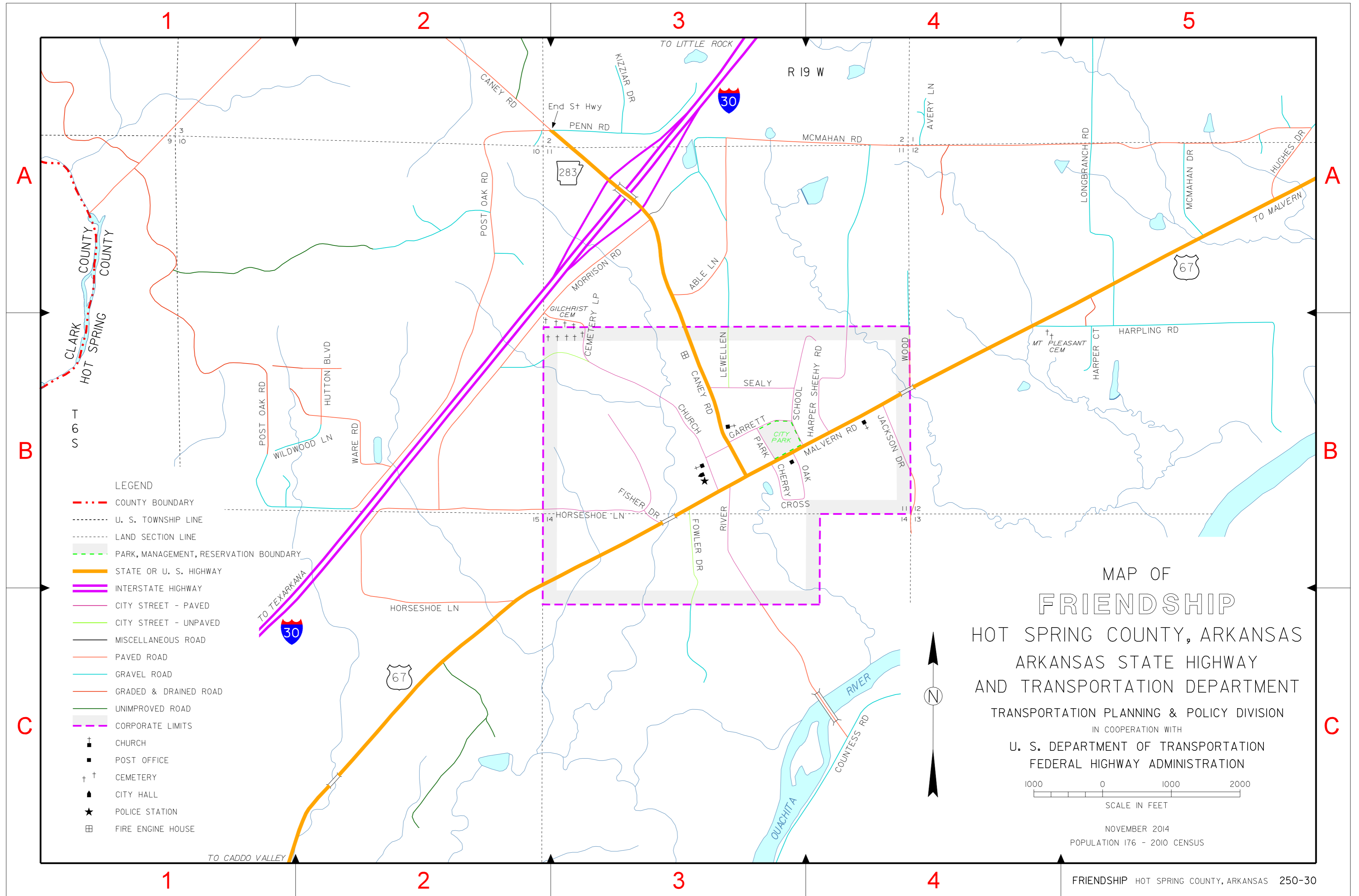

- LEGEND
- COUNTY BOUNDARY
 - U. S. TOWNSHIP LINE
 - LAND SECTION LINE
 - PARK, MANAGEMENT, RESERVATION BOUNDARY
 - STATE OR U. S. HIGHWAY
 - INTERSTATE HIGHWAY
 - CITY STREET - PAVED
 - CITY STREET - UNPAVED
 - MISCELLANEOUS ROAD
 - PAVED ROAD
 - GRAVEL ROAD
 - GRADED & DRAINED ROAD
 - UNIMPROVED ROAD
 - CORPORATE LIMITS
 - † CHURCH
 - POST OFFICE
 - †† CEMETERY
 - ▲ CITY HALL
 - ★ POLICE STATION
 - ⊠ FIRE ENGINE HOUSE

MAP OF
FRIENDSHIP
 HOT SPRING COUNTY, ARKANSAS
 ARKANSAS STATE HIGHWAY
 AND TRANSPORTATION DEPARTMENT
 TRANSPORTATION PLANNING & POLICY DIVISION
 IN COOPERATION WITH
 U. S. DEPARTMENT OF TRANSPORTATION
 FEDERAL HIGHWAY ADMINISTRATION

1000 0 1000 2000
 SCALE IN FEET

NOVEMBER 2014
 POPULATION 176 - 2010 CENSUS