

INDEX

- | | |
|----------------------------|-----|
| 2 ND | A-2 |
| 3 RD | A-2 |
| 4 TH | B-2 |
| 5 TH | B-2 |
| 6 TH | B-2 |
| AIRPORT DR | B-2 |
| CYPRESS | A-2 |
| HALF | B-2 |
| LOWE | B-2 |
| MADISON AVE | A-2 |
| MAIN | A-2 |
| MARTIN LUTHER KING JR BLVD | A-2 |
| McKAY | A-2 |
| McKAY | B-2 |
| PECAN | B-2 |
| POWELL | A-2 |
| PRICE DR | A-2 |
| SCHOOL | A-2 |
| WALL | A-2 |
| WASHINGTON AVE | A-2 |
| WILSON AVE | B-2 |

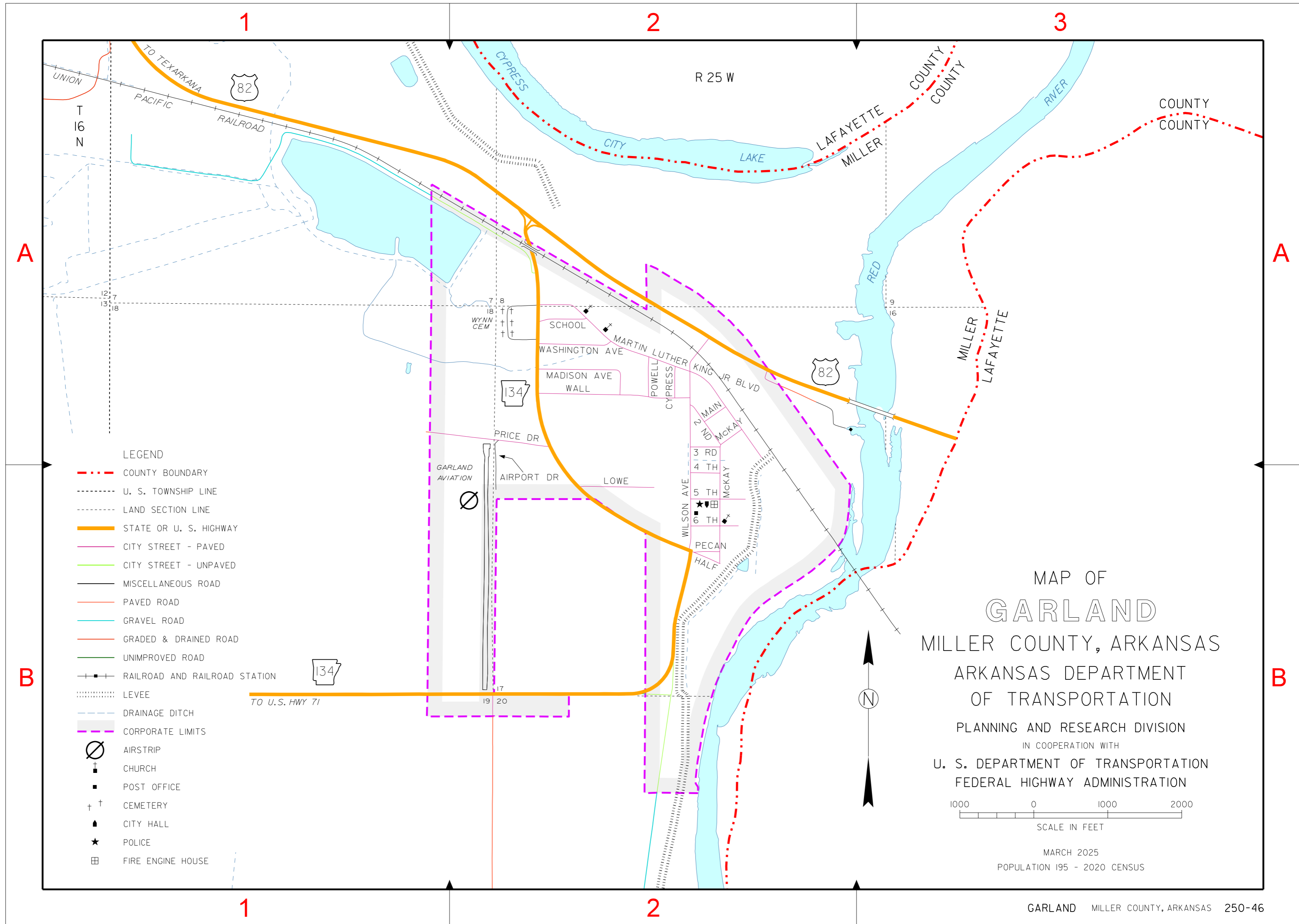

- LEGEND**
- - - - - COUNTY BOUNDARY
 - - - - - U. S. TOWNSHIP LINE
 - - - - - LAND SECTION LINE
 - STATE OR U. S. HIGHWAY
 - CITY STREET - PAVED
 - CITY STREET - UNPAVED
 - MISCELLANEOUS ROAD
 - PAVED ROAD
 - GRAVEL ROAD
 - GRADED & DRAINED ROAD
 - UNIMPROVED ROAD
 - + + + + + RAILROAD AND RAILROAD STATION
 - - - - - LEVEE
 - - - - - DRAINAGE DITCH
 - - - - - CORPORATE LIMITS
 - ⊘ AIRSTRIP
 - CHURCH
 - POST OFFICE
 - + + CEMETERY
 - ▲ CITY HALL
 - ★ POLICE
 - ▣ FIRE ENGINE HOUSE

MAP OF
GARLAND
 MILLER COUNTY, ARKANSAS
 ARKANSAS DEPARTMENT
 OF TRANSPORTATION
 PLANNING AND RESEARCH DIVISION
 IN COOPERATION WITH
 U. S. DEPARTMENT OF TRANSPORTATION
 FEDERAL HIGHWAY ADMINISTRATION

1000 0 1000 2000
 SCALE IN FEET

MARCH 2025
 POPULATION 195 - 2020 CENSUS