

INDEX

3 RD
BAKER RD
GRALEY AVE
EATON
FRACHISEUR RD
HERRING DR
JEFFERSON AVE
LINE RD
PAYNE
PORT ARTHUR AVE
RED OAK
THURMOND AVE
TRIMBLE AVE
WRIGHT AVE
YOUNGBLOOD RD

B
C
D
E

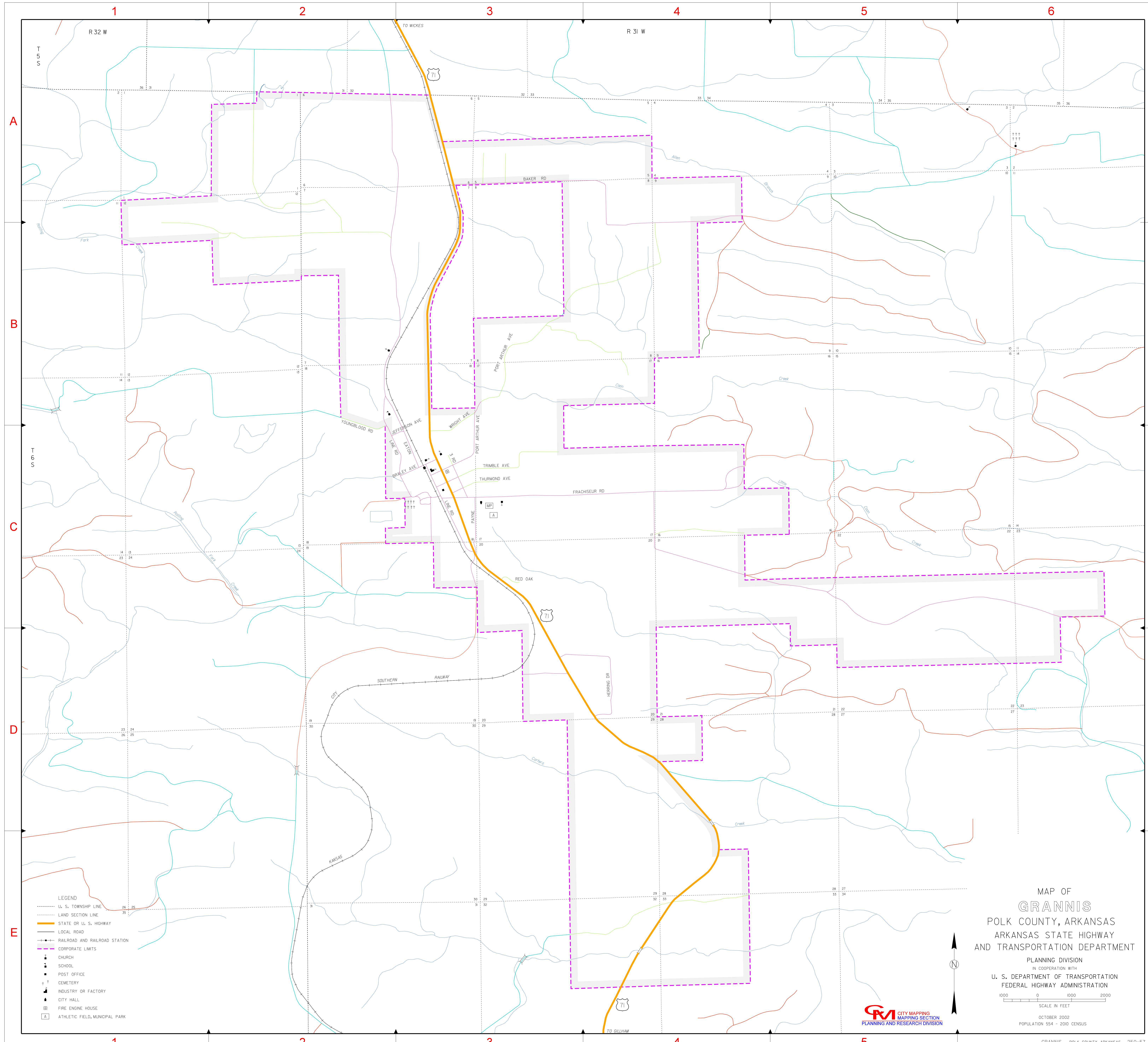

A A

B B

C C

D D

E E

- LEGEND
- U. S. TOWNSHIP LINE
 - LAND SECTION LINE
 - STATE OR U. S. HIGHWAY
 - LOCAL ROAD
 - RAILROAD AND RAILROAD STATION
 - CORPORATE LIMITS
 - CHURCH
 - SCHOOL
 - POST OFFICE
 - CEMETERY
 - INDUSTRY OR FACTORY
 - CITY HALL
 - FIRE ENGINE HOUSE
 - ATHLETIC FIELD, MUNICIPAL PARK

MAP OF
GRANNIS
POLK COUNTY, ARKANSAS
ARKANSAS STATE HIGHWAY
AND TRANSPORTATION DEPARTMENT

PLANNING DIVISION
IN COOPERATION WITH
U. S. DEPARTMENT OF TRANSPORTATION
FEDERAL HIGHWAY ADMINISTRATION

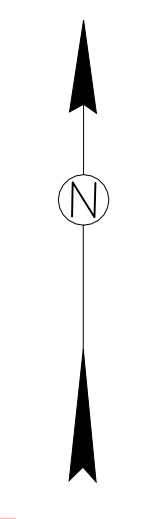

CM CITY MAPPING
MAPPING SECTION
PLANNING AND RESEARCH DIVISION

OCTOBER 2002
POPULATION 554 - 2010 CENSUS