

# INDEX

BUTLER	B-3
CLAY	B-2
CLAY	B-3
COLLEGE	A-2
DAVIS	B-2
DAVIS	B-3
FAIRVIEW	A-2
FRIST	B-2
FRONT	B-3
GARDNER	B-2
JACK	B-3
MAIN	B-2
MAIN	B-3
SECOND	A-2
STAVE	B-2
THIRD	B-2

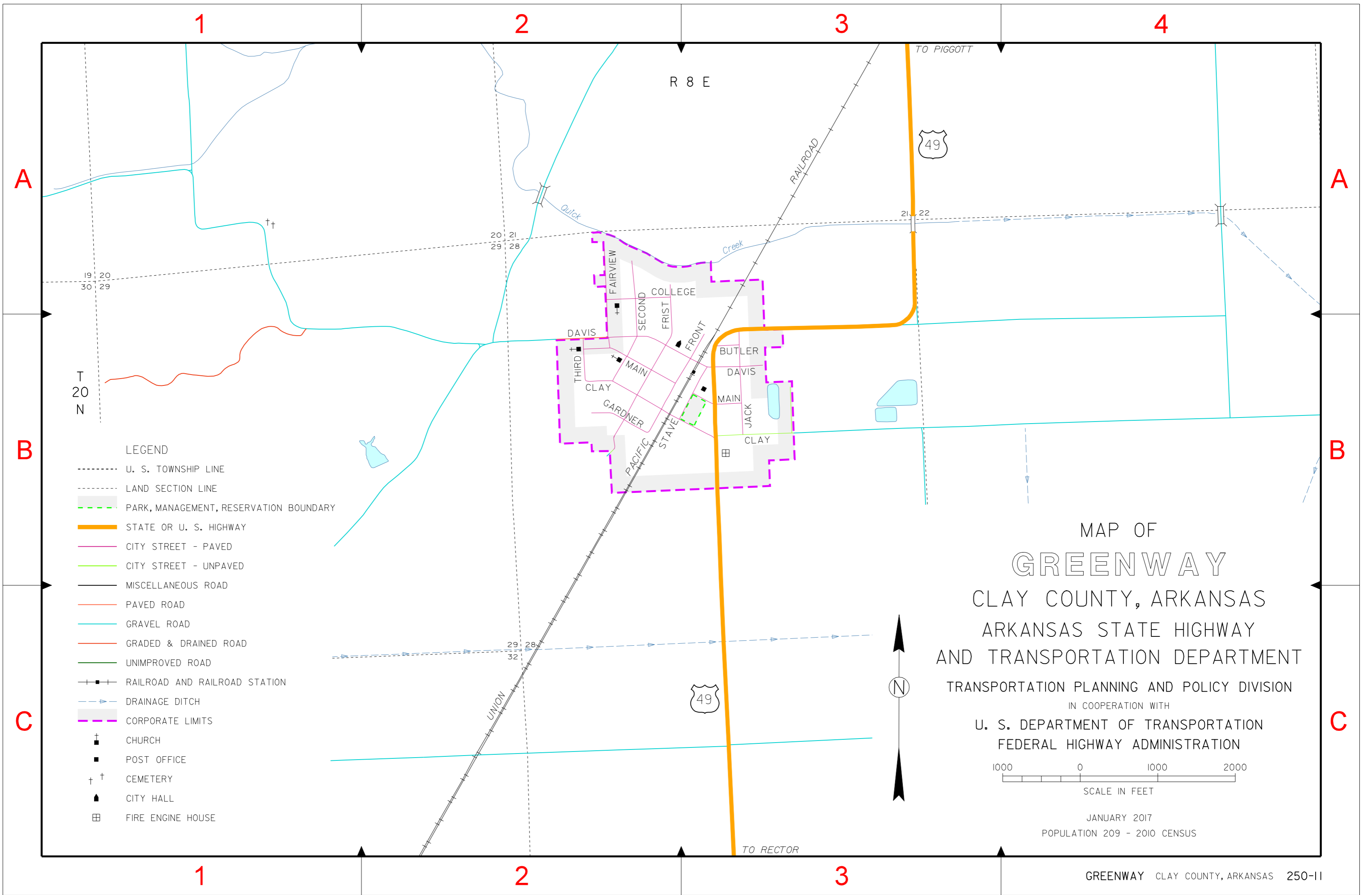

- LEGEND**
- U. S. TOWNSHIP LINE
  - LAND SECTION LINE
  - PARK, MANAGEMENT, RESERVATION BOUNDARY
  - STATE OR U. S. HIGHWAY
  - CITY STREET - PAVED
  - CITY STREET - UNPAVED
  - MISCELLANEOUS ROAD
  - PAVED ROAD
  - GRAVEL ROAD
  - GRADED & DRAINED ROAD
  - UNIMPROVED ROAD
  - RAILROAD AND RAILROAD STATION
  - DRAINAGE DITCH
  - CORPORATE LIMITS
  - † CHURCH
  - POST OFFICE
  - †† CEMETERY
  - ▲ CITY HALL
  - ▣ FIRE ENGINE HOUSE

MAP OF  
**GREENWAY**  
 CLAY COUNTY, ARKANSAS  
 ARKANSAS STATE HIGHWAY  
 AND TRANSPORTATION DEPARTMENT

TRANSPORTATION PLANNING AND POLICY DIVISION  
 IN COOPERATION WITH  
 U. S. DEPARTMENT OF TRANSPORTATION  
 FEDERAL HIGHWAY ADMINISTRATION



JANUARY 2017  
 POPULATION 209 - 2010 CENSUS