

INDEX

"A"	B-1
5 TH AVE	B-1
6 TH AVE	B-1
ADDIE RD	B-2
ATLANTA	C-2
BEECH	B-1
BRANCH RD	B-2
BUNN	B-2
BURNER LN	A-2
CATLETT DR	B-2
CENTRAL AVE	C-2
COLEMAN DR	B-2
DEARING RD	B-2
DOGWOOD	B-2
E 2 ND AVE	B-2
E 3 RD AVE	B-2
E 4 TH AVE	B-2
E DIAL	C-2
E HERD STONE	B-2
E RALPH ABRAMSON	B-2
GABLE END	C-2
HOLLY	B-2
HONEYCUTT WAY	C-2
JOHNSON RD	B-2
KERR	A-2
LOUISE DR	C-2
LYNLEE DR	B-2
MARSHALL	B-2
MARTIN LUTHER KING DR	A-2
MIMOSA	B-2
MIMOSA	B-2
MOCKINGBIRD LN	B-2
N PINE	B-2
N SMITH	B-2
OAK	B-2
PATTERSON	A-3
S PINE	B-2
S SMITH	B-2
SPRUCE	B-2
TRICE	A-2
TYLER	B-2
W 2 ND AVE	B-2
W 3 RD AVE	B-2
W 4 TH AVE	B-1
W 4 TH AVE	B-2
W HERD STONE	B-2
W RALPH ABRAMSON	B-2
WASHINGTON	C-2
WATERPLANT RD	B-2
WILSON	B-2

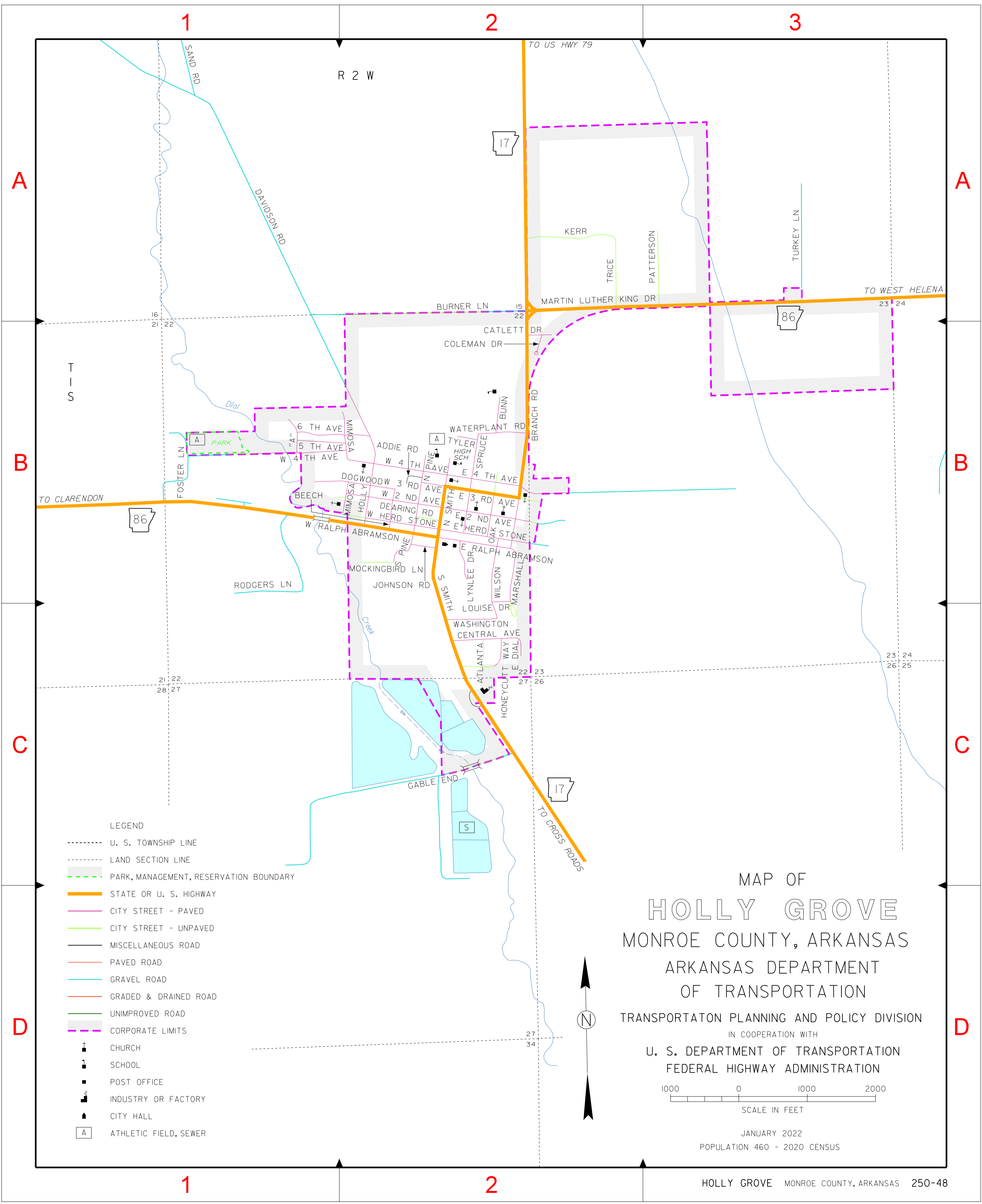

- LEGEND
- U. S. TOWNSHIP LINE
 - LAND SECTION LINE
 - PARK, MANAGEMENT, RESERVATION BOUNDARY
 - STATE OR U. S. HIGHWAY
 - CITY STREET - PAVED
 - CITY STREET - UNPAVED
 - MISCELLANEOUS ROAD
 - PAVED ROAD
 - GRAVEL ROAD
 - GRADED & DRAINED ROAD
 - UNIMPROVED ROAD
 - CORPORATE LIMITS
 - † CHURCH
 - 1 SCHOOL
 - POST OFFICE
 - INDUSTRY OR FACTORY
 - ▲ CITY HALL
 - A ATHLETIC FIELD, SEWER

MAP OF
HOLLY GROVE
 MONROE COUNTY, ARKANSAS
 ARKANSAS DEPARTMENT
 OF TRANSPORTATION
 TRANSPORTATION PLANNING AND POLICY DIVISION
 IN COOPERATION WITH
 U. S. DEPARTMENT OF TRANSPORTATION
 FEDERAL HIGHWAY ADMINISTRATION

1000 0 1000 2000
 SCALE IN FEET

JANUARY 2022
 POPULATION 460 - 2020 CENSUS