

INDEX

- | | |
|----------------|-----|
| 1 ST | C-5 |
| 2 ND | C-5 |
| 3 RD | C-5 |
| 4 TH | C-4 |
| 4 TH | C-5 |
| 5 TH | D-4 |
| 6 TH | D-4 |
| ALICE | D-4 |
| BUFFALO | D-5 |
| BUSH | D-5 |
| CARTER | C-5 |
| CARTER CV | D-5 |
| CATFISH DR | D-5 |
| CEDAR | C-4 |
| CHERRY | C-3 |
| COBEAN BLVD | C-4 |
| COTTONWOOD | C-5 |
| COURT | C-5 |
| CROSS | C-3 |
| DANITA CV | D-5 |
| DEALYN | C-4 |
| DEANNA DR | D-5 |
| DENNIS | C-4 |
| DOGWOOD | C-4 |
| EBONY | D-5 |
| ELM | D-5 |
| ESTELLE | C-4 |
| FAYE AVE | D-5 |
| FAYE CV | D-5 |
| FRANKLIN | C-4 |
| GRIMES | D-5 |
| GROVE | C-5 |
| GROVE | D-9 |
| HICKORY RD | C-4 |
| JACKSON RD | D-6 |
| JAMES | C-3 |
| JOHNSON AVE | C-5 |
| JORDAN | D-4 |
| KAITLYN | D-4 |
| LADD | D-5 |
| LAKE | C-5 |
| LYNN | D-4 |
| MAIN | C-4 |
| MAIN | C-5 |
| MARCELLA DR | D-4 |
| MAUMELLE | C-5 |
| MEAD | D-4 |
| MILLER | D-4 |
| MILLIGAN RD | C-2 |
| MILO | C-4 |
| NASH | D-5 |
| NASH CV | D-5 |
| OAK | C-3 |
| OLATHE | D-5 |
| OPAL CR | C-5 |
| PARK | C-5 |
| PECAN | C-4 |
| PRAIRIE | C-5 |
| PYLAND | C-4 |
| ROSS LEIGH ANN | C-4 |
| SKYLARK | D-6 |
| STONE | C-4 |
| SUSIE | C-4 |
| TUPELO | D-5 |
| VIOLETTA | D-5 |
| WALKER | C-5 |
| WALNUT | C-5 |
| WILLOW RUN | C-4 |

MAP OF
LAKE CITY
CRAIGHEAD COUNTY, ARKANSAS
ARKANSAS DEPARTMENT
OF TRANSPORTATION

TRANSPORTATION PLANNING AND POLICY DIVISION
IN COOPERATION WITH
U. S. DEPARTMENT OF TRANSPORTATION
FEDERAL HIGHWAY ADMINISTRATION



DECEMBER 2020
POPULATION 2,082 - 2010 CENSUS

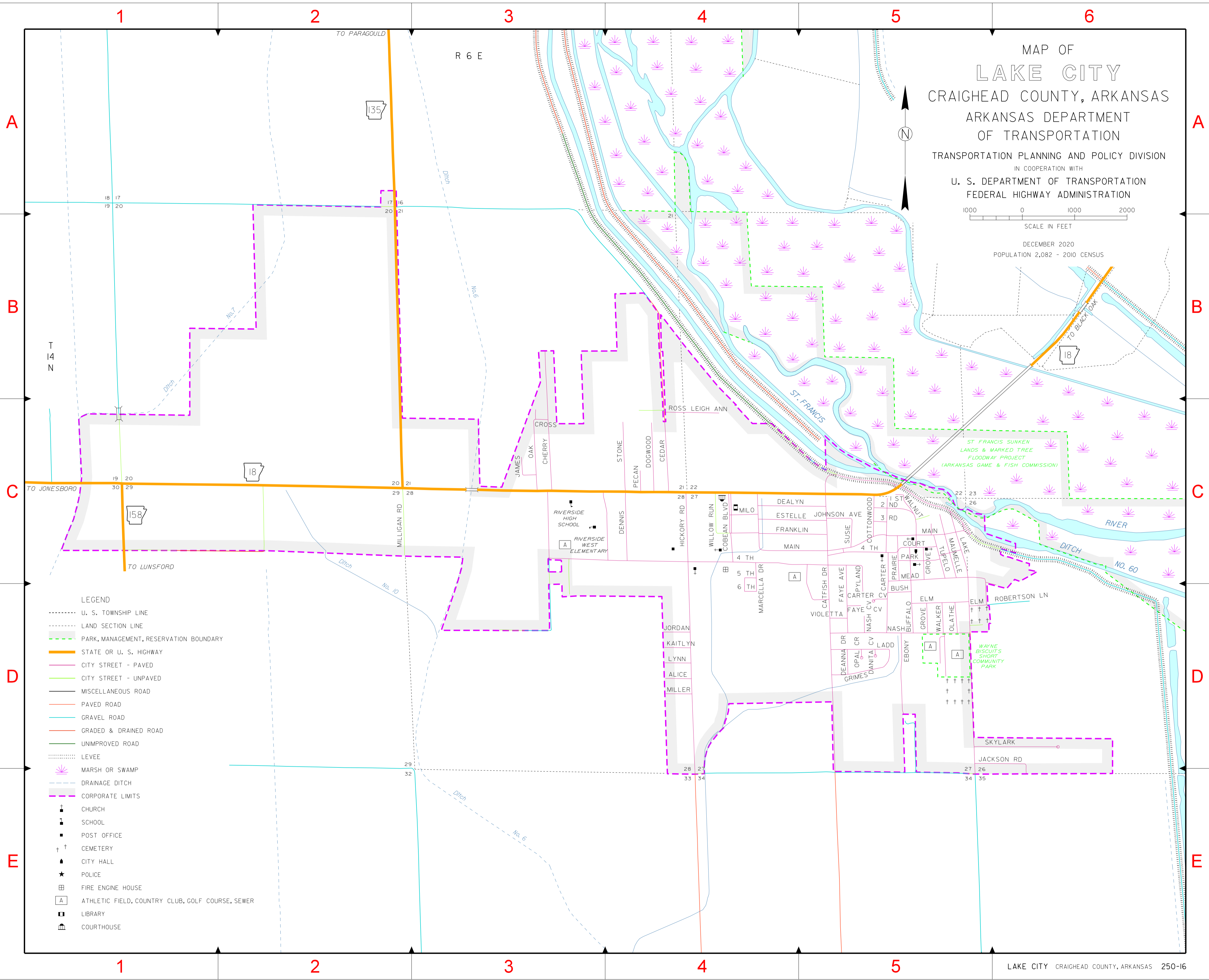

- LEGEND**
- U. S. TOWNSHIP LINE
 - LAND SECTION LINE
 - PARK, MANAGEMENT, RESERVATION BOUNDARY
 - STATE OR U. S. HIGHWAY
 - CITY STREET - PAVED
 - CITY STREET - UNPAVED
 - MISCELLANEOUS ROAD
 - PAVED ROAD
 - GRAVEL ROAD
 - GRADED & DRAINED ROAD
 - UNIMPROVED ROAD
 - LEVEE
 - ☄ MARSH OR SWAMP
 - DRAINAGE DITCH
 - CORPORATE LIMITS
 - ⊕ CHURCH
 - ⊖ SCHOOL
 - ⊖ POST OFFICE
 - + † CEMETERY
 - ▲ CITY HALL
 - ★ POLICE
 - ⊞ FIRE ENGINE HOUSE
 - ⊞ ATHLETIC FIELD, COUNTRY CLUB, GOLF COURSE, SEWER
 - ⊞ LIBRARY
 - ⊞ COURTHOUSE