

INDEX

- 9 TH C-3
- AIRPORT RD D-4
- ASTORIA C-3
- BATTLE D-3
- BEE TREE C-3
- BOURBON C-2
- BURTON D-4
- CALHOUN C-3
- CEMETERY RD A-3
- CHESTNUT D-3
- CHESTNUT C-3
- CLAY D-3
- CUNNINGHAM E-3
- E 1 ST D-4
- E 2 ND D-3
- E 3 RD D-3
- E 4 TH D-4
- E 5 TH D-3
- E 6 TH D-3
- E 7 TH D-3
- E 8 TH D-3
- E 17 TH C-3
- E 24 TH B-3
- E 30 TH A-4
- E 31 ST A-3
- MCCLENDON RD E-4
- MULDROW A-4
- FORT D-3
- GARRETT E-3
- HARRELL E-3
- INDUSTRIAL PARK DR D-4
- LYNN D-4
- MOORE D-2
- N KING D-2
- N MAPLE D-3
- N MAPLE D-3
- N MURPHY D-3
- PATTON DR C-3
- PIN OAK D-4
- POST OAK D-4
- RED OAK D-4
- RED OAK E-4
- ROSE E-3
- S KING D-2
- S MAPLE D-3
- S MURPHY D-3
- SPRUCE B-3
- SPRUCE D-3
- STEELE D-3
- W 1 ST D-3
- W 2 ND D-3
- W 3 RD D-3
- W 4 TH D-3
- W 5 TH D-2
- W 5 TH D-3
- W 6 TH D-3
- W 7 TH D-2
- W 7 TH D-3
- W 8 TH C-2
- W 8 TH C-3
- W 11 TH C-3
- W 12 TH C-3
- W 13 TH C-3
- W 30 TH A-3
- W 31 ST A-3
- W MCCLENDON RD E-3
- W MULDRON A-3
- W POWELL D-3
- WALNUT D-3
- WARREN D-3
- WHITE OAK E-4
- WILSON D-2

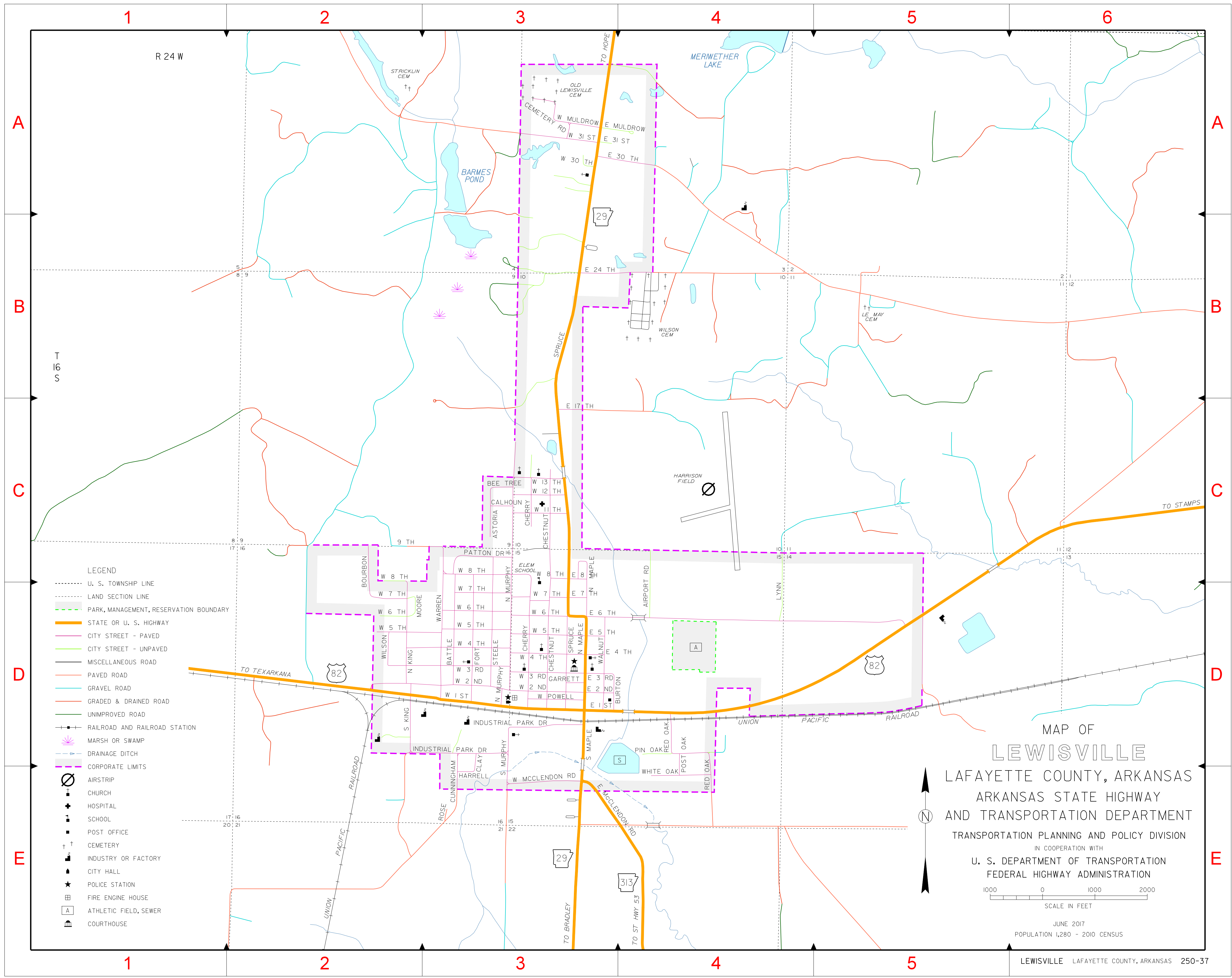

- LEGEND**
- U. S. TOWNSHIP LINE
 - LAND SECTION LINE
 - PARK, MANAGEMENT, RESERVATION BOUNDARY
 - STATE OR U. S. HIGHWAY
 - CITY STREET - PAVED
 - CITY STREET - UNPAVED
 - MISCELLANEOUS ROAD
 - PAVED ROAD
 - GRAVEL ROAD
 - GRADED & DRAINED ROAD
 - UNIMPROVED ROAD
 - RAILROAD AND RAILROAD STATION
 - MARSH OR SWAMP
 - DRAINAGE DITCH
 - CORPORATE LIMITS
 - AIRSTRIP
 - CHURCH
 - HOSPITAL
 - SCHOOL
 - POST OFFICE
 - CEMETERY
 - INDUSTRY OR FACTORY
 - CITY HALL
 - POLICE STATION
 - FIRE ENGINE HOUSE
 - ATHLETIC FIELD, SEWER
 - COURTHOUSE

MAP OF
LEWISVILLE
 LAFAYETTE COUNTY, ARKANSAS
 ARKANSAS STATE HIGHWAY
 AND TRANSPORTATION DEPARTMENT
 TRANSPORTATION PLANNING AND POLICY DIVISION
 IN COOPERATION WITH
 U. S. DEPARTMENT OF TRANSPORTATION
 FEDERAL HIGHWAY ADMINISTRATION

1000 0 1000 2000
 SCALE IN FEET

JUNE 2017
 POPULATION 1,280 - 2010 CENSUS