

INDEX

BEVERLY DR	C-2
BOWMAN AVE	B-2
BROADWAY	C-2
CAGLE LN	B-1
CALDWELL AVE	B-2
CARLTON LN	C-1
CHESTNUT AVE	C-2
COLE	B-2
DARLENE DR	C-2
DAYTON RD	A-4
E CENTER	B-2
E DUNBAR	C-2
E HIGH	C-2
E WILLIS	B-2
E WOOD	C-2
EVANS LN	B-3
FAIRFAX	C-2
FARREL AVE	B-2
FRANKLIN	C-2
GROVE	B-2
HARP RD	A-4
HUNTINGTON AVE	B-2
HWY 71 N	B-1
KEVIN DR	C-2
MARIT AVE	B-3
MARSHALL AVE	B-1
MARSHALL LN	B-1
MARTIN LN	B-2
N DIVISION AVE	B-1
N GREGG AVE	B-1
N MAIN AVE	B-1
N SEBASCOTT AVE	B-2
OLIVE AVE	B-2
PACKARD	C-1
PARK AVE	C-2
PYLES LN	C-2
RODGERS	B-2
S 2 ND AVE	B-2
S 3 RD AVE	C-2
S 4 TH AVE	C-2
S 5 TH AVE	C-2
S 6 TH AVE	C-2
S 7 TH AVE	C-2
S DIVISION AVE	C-1
S GREGG AVE	B-1
S GREGG AVE	C-1
S MAIN AVE	C-1
S SEBASCOTT AVE	C-2
SLATE RD	B-3
STONE	B-2
TIGER TR	B-2
W CENTER	B-1
W DUNBAR	C-1
W HARPER	B-1
W HIGH	B-1
W HOWARD	B-1
W WOOD	C-1
WALNUT AVE	B-2

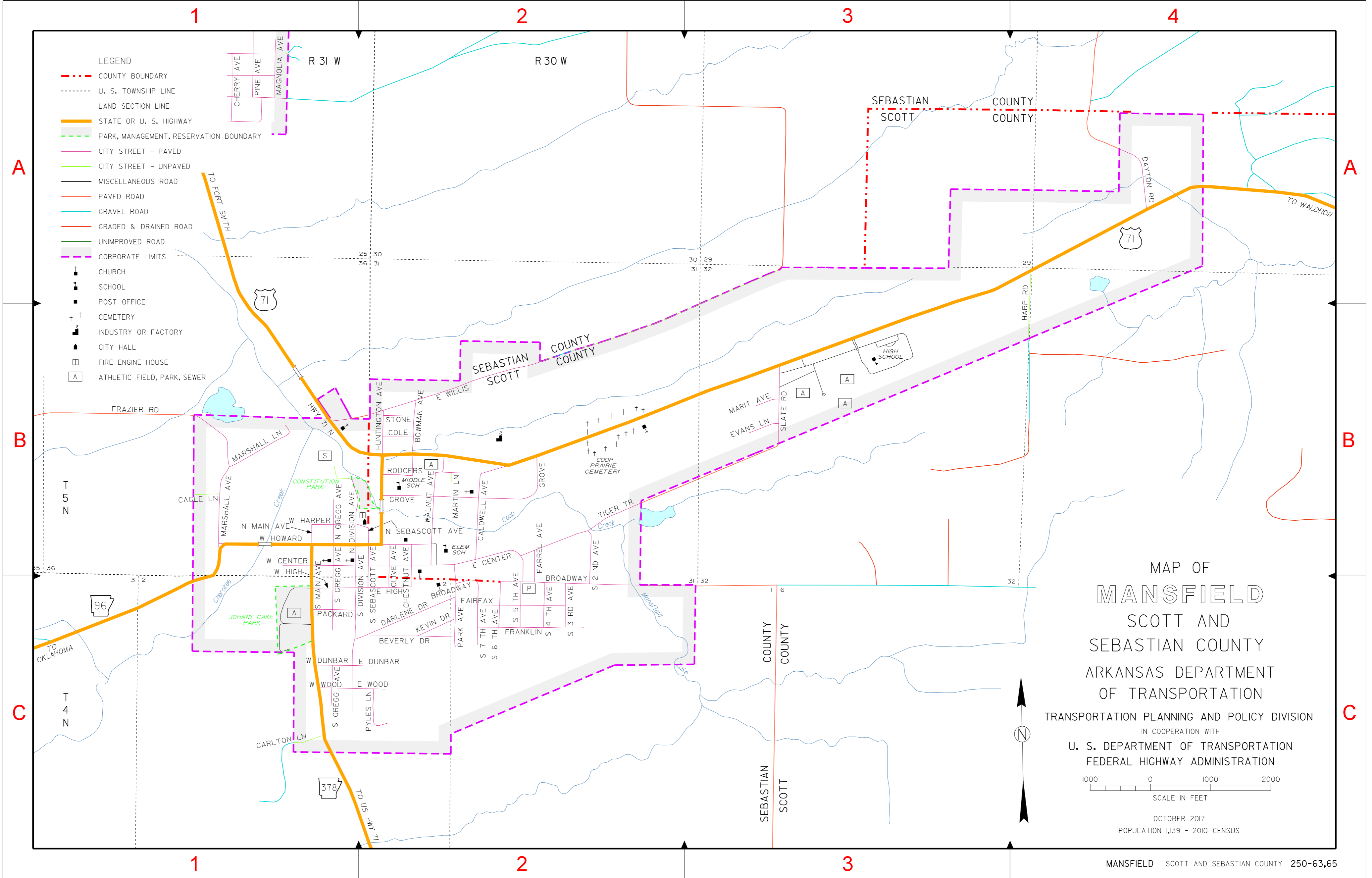

- LEGEND**
- COUNTY BOUNDARY
 - U. S. TOWNSHIP LINE
 - LAND SECTION LINE
 - STATE OR U. S. HIGHWAY
 - PARK, MANAGEMENT, RESERVATION BOUNDARY
 - CITY STREET - PAVED
 - CITY STREET - UNPAVED
 - MISCELLANEOUS ROAD
 - PAVED ROAD
 - GRAVEL ROAD
 - GRADED & DRAINED ROAD
 - UNIMPROVED ROAD
 - CORPORATE LIMITS
 - CHURCH
 - SCHOOL
 - POST OFFICE
 - CEMETERY
 - INDUSTRY OR FACTORY
 - CITY HALL
 - FIRE ENGINE HOUSE
 - ATHLETIC FIELD, PARK, SEWER

MAP OF
MANSFIELD
 SCOTT AND
 SEBASTIAN COUNTY
 ARKANSAS DEPARTMENT
 OF TRANSPORTATION
 TRANSPORTATION PLANNING AND POLICY DIVISION
 IN COOPERATION WITH
 U. S. DEPARTMENT OF TRANSPORTATION
 FEDERAL HIGHWAY ADMINISTRATION

1000 0 1000 2000
 SCALE IN FEET

OCTOBER 2017
 POPULATION 1,139 - 2010 CENSUS