

INDEX

- 1 ST
- 2 ND
- 3 TH
- 4 TH
- 5 TH
- 6 TH
- ASH TR
- ASH TR
- BARREN FORK RD
- CIRCLE DR
- CRAIG LN
- E 7 TH
- E STELLA RD
- E STELLA RD
- MAIN
- N STELLA RD
- PEARL DR
- REEVES
- RUDOLPH RD
- SCHOOL
- WEST

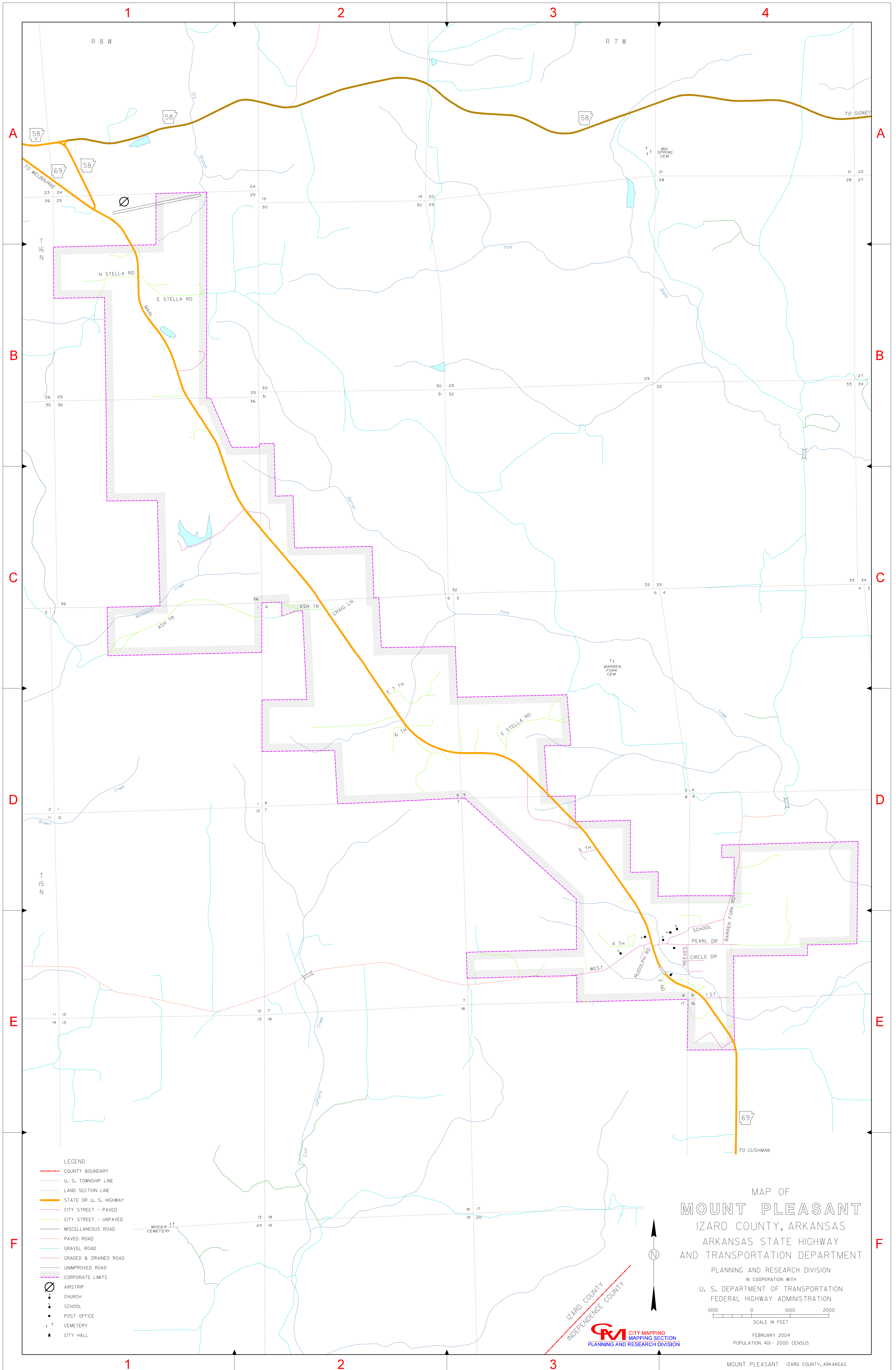

MAP OF
MOUNT PLEASANT
 IZARD COUNTY, ARKANSAS
 ARKANSAS STATE HIGHWAY
 AND TRANSPORTATION DEPARTMENT
 PLANNING AND RESEARCH DIVISION
 IN COOPERATION WITH
 U. S. DEPARTMENT OF TRANSPORTATION
 FEDERAL HIGHWAY ADMINISTRATION



FEBRUARY 2004
 POPULATION 401 - 2000 CENSUS

