

**INDEX**

- |                |     |
|----------------|-----|
| BLACK CHERRY   | C-2 |
| BRUSHY RD      | B-3 |
| E BROADWAY AVE | C-3 |
| FOUNTAIN LN    | B-3 |
| HILLTOP LN     | B-3 |
| LYNDA LN       | B-2 |
| MINNIE LN      | B-3 |
| OUACHITA AVE   | C-3 |
| RIVER DR       | C-3 |
| RODNEY LN      | B-2 |
| SCHOOL DR      | B-3 |
| SOUTH          | B-3 |
| TAYLOR DR      | B-3 |
| TAYLOR LP      | B-3 |
| W BROADWAY AVE | B-2 |
| WHITE TR       | B-2 |

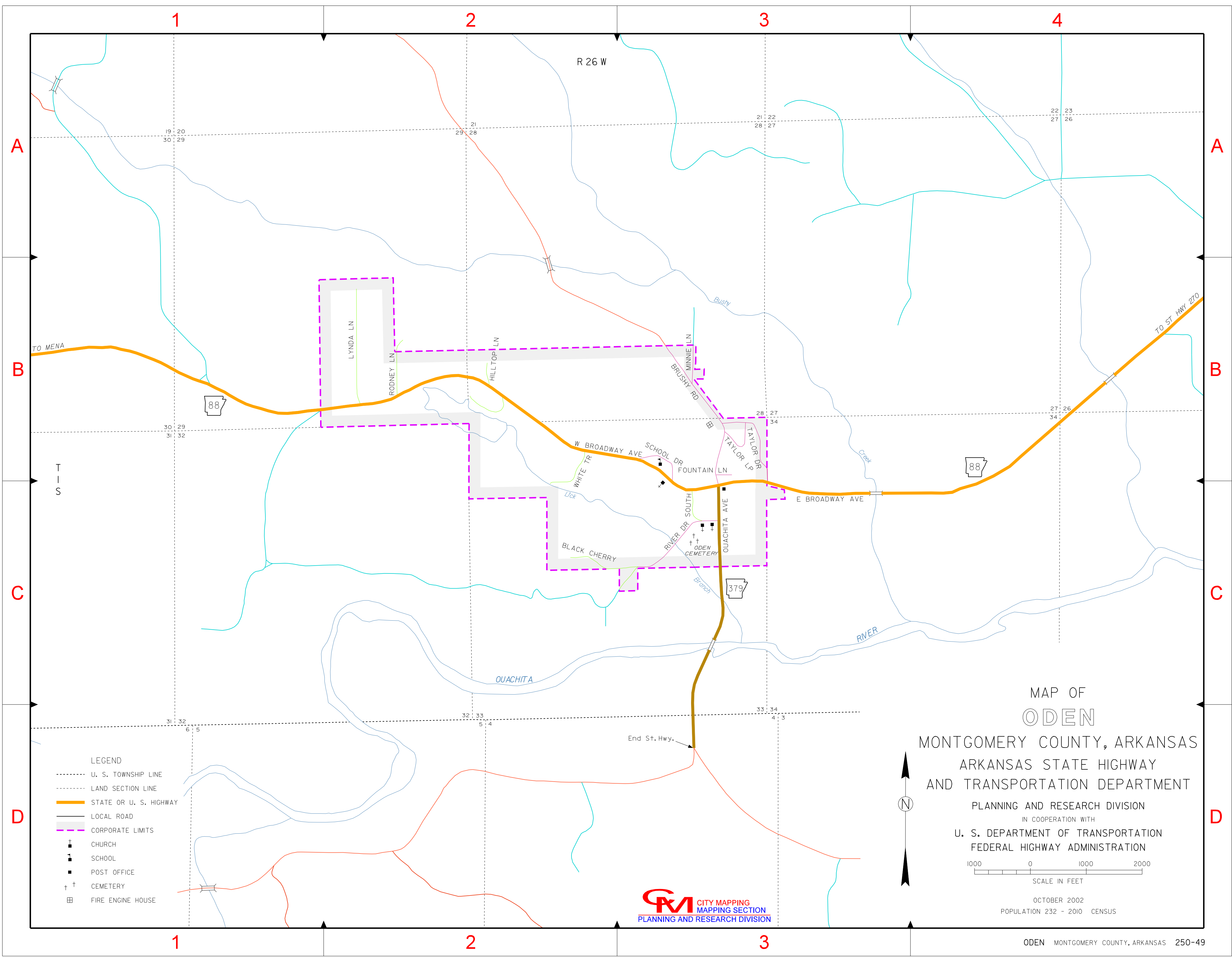

- LEGEND**
- U. S. TOWNSHIP LINE
  - LAND SECTION LINE
  - STATE OR U. S. HIGHWAY
  - LOCAL ROAD
  - CORPORATE LIMITS
  - † CHURCH
  - † SCHOOL
  - POST OFFICE
  - †† CEMETERY
  - ⊞ FIRE ENGINE HOUSE

MAP OF  
**ODEN**  
MONTGOMERY COUNTY, ARKANSAS  
ARKANSAS STATE HIGHWAY  
AND TRANSPORTATION DEPARTMENT  
PLANNING AND RESEARCH DIVISION  
IN COOPERATION WITH  
U. S. DEPARTMENT OF TRANSPORTATION  
FEDERAL HIGHWAY ADMINISTRATION

1000 0 1000 2000  
SCALE IN FEET

OCTOBER 2002  
POPULATION 232 - 2010 CENSUS

