

INDEX

BALL	B-3
CEDAR CV	B-3
E SECOND	B-3
E THIRD	B-3
ELM	B-3
HAZEL	B-3
HWY 34 N	B-2
HWY 90 E	B-2
LAUREL	B-3
MAIN	B-3
OAK	B-3
OKEAN LP	B-3
PINE DR	B-3
POPLAR	B-3
W SECOND	B-3
W THIRD	B-3
WALNUT	B-3

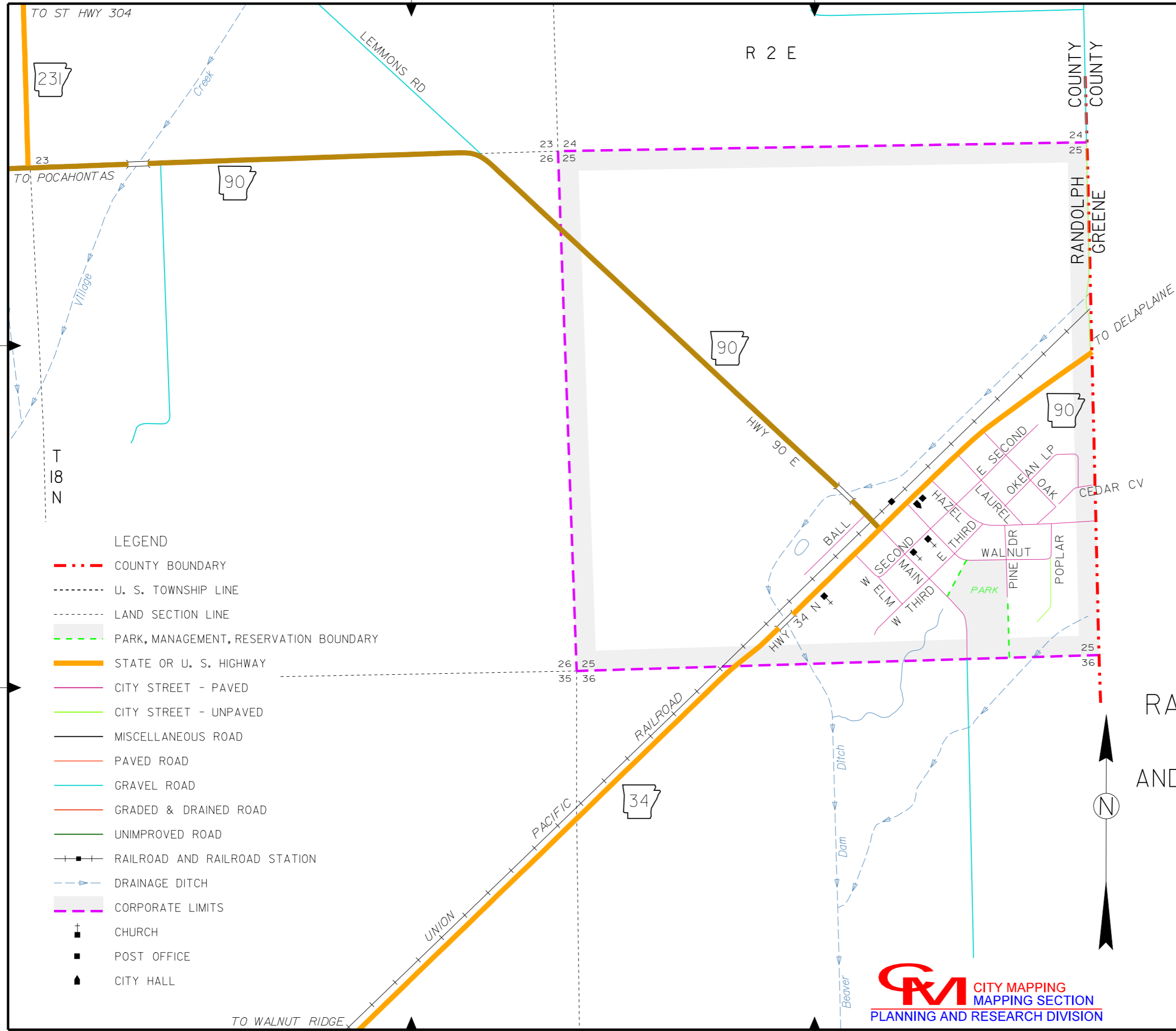

A

B

C

A

B

C

LEGEND

- - - COUNTY BOUNDARY
- - - U. S. TOWNSHIP LINE
- - - LAND SECTION LINE
- - - PARK, MANAGEMENT, RESERVATION BOUNDARY
- STATE OR U. S. HIGHWAY
- CITY STREET - PAVED
- CITY STREET - UNPAVED
- MISCELLANEOUS ROAD
- PAVED ROAD
- GRAVEL ROAD
- GRADED & DRAINED ROAD
- UNIMPROVED ROAD
- + + + RAILROAD AND RAILROAD STATION
- - - DRAINAGE DITCH
- - - CORPORATE LIMITS
- † CHURCH
- POST OFFICE
- ▲ CITY HALL

MAP OF O'KEAN RANDOLPH COUNTY, ARKANSAS ARKANSAS STATE HIGHWAY AND TRANSPORTATION DEPARTMENT

PLANNING AND RESEARCH DIVISION
IN COOPERATION WITH
U. S. DEPARTMENT OF TRANSPORTATION
FEDERAL HIGHWAY ADMINISTRATION



JUNE 2008
POPULATION 194 - 2010 CENSUS

CMI CITY MAPPING
MAPPING SECTION
PLANNING AND RESEARCH DIVISION