

INDEX

- AFFIRMED LN D-2
- ANGUS DR D-2
- ARKANSAS LN D-2
- ARMSTRONG D-2
- ASPEN PL D-2
- BATTERY DR D-2
- BATTLEFIELD PARK D-2
- BAYONET D-2
- BECA D-2
- BENTON D-2
- BILL CAMPBELL D-2
- BITWORKS WAY D-2
- BLACK NURSERY D-2
- BLUENIST D-2
- BLUNT AVE D-2
- BOBB KIDD LAKE D-2
- BONNIE SCOTLAND DR D-2
- BOSTON D-2
- BRADY D-2
- BRIGADE BLVD D-2
- BRUNK D-2
- BUDDY ELKINS D-2
- BUNKER LN D-2
- CACTUS JACK D-2
- CANNON D-2
- CAPTAIN HOPKINS D-2
- CAPTAIN MARSHALL D-2
- CAPTAIN REID D-2
- CAPTAIN STOCKTON D-2
- CARROLL DR D-2
- CATLETT D-2
- CAVALRY LN D-2
- CEDAR LN D-2
- CENTERPOINT CHURCH D-2
- CHAMBERLAN RD D-2
- CHARLES LN D-2
- CHIP SHOT DR D-2
- CITATION LN D-2
- CLYDE CARNES D-2
- COBBLESTONE CT D-2
- COLE DR D-2
- COLLINS DR D-2
- COLONEL BARTOW DR D-2
- COLONEL BASS LN D-2
- COLONEL HAWTHORN DR D-2
- COLONEL MCNEIL DR D-2
- COLONEL SALOMON DR D-2
- COMMERCIAL D-2
- COOK D-2
- CRAWFORD LN D-2
- CUSTER D-2
- CYPRESS AVE D-2
- DANNY BRYAN RD D-2
- DITMARS RD D-2
- DITMARS RD D-2
- DIVISION D-2
- DOGWOOD LN D-2
- APPLE HILL D-2
- BUCHANAN D-2
- BUS D-2
- BUTLER D-2
- CENTER D-2
- CENTER D-2
- CLEVELAND D-2
- DOUGLAS D-2
- DOUGLAS D-2
- GRAHAM D-2
- GRAHAM D-2
- MCCORMICK D-2
- MOCK DR D-2
- PARKS D-2
- PARKS D-2
- STILLS RD D-2
- THURMAN D-2
- EASTWOOD DR D-2
- ED STAGGS DR D-2
- ELM D-2
- ESCUE DR D-2
- FIDLER LN D-2
- FOREST VIEW DR D-2
- GALLANT FOX LN D-2
- GENERAL FAGAN DR D-2
- GENERAL MARMADUKE DR D-2
- GENERAL MCCRAE DR D-2
- GENERAL PARSON DR D-2
- GILES D-2
- GILES D-2
- GRANDVIEW DR D-2
- GRANT AVE D-2
- GREEN EARTH D-2
- HALL RD D-2
- HANCOCK D-2
- HEARTHSTONE CR D-2
- HERRON D-2
- HICKORY D-2
- HINDMAN DR D-2
- HINDMAN DR D-2
- HOLMES D-2
- INDUSTRIAL PARK RD D-2
- INFANTRY LN D-2
- IROQUOIS LN D-2
- IROQUOIS DR D-2
- JENKINS RD D-2
- KATE SMITH D-2
- KENNAN D-2
- LEE ANN WAY D-2
- LEWIS D-2
- LINDA D-2
- LITTLE ELM D-2
- LORENZ D-2
- MADISON DR D-2
- MAJOR PINDALL CR D-2
- MAJOR STONE CR D-2
- MARLE D-2
- MARNA LYNN DR D-2
- MUSKET D-2
- N BATTLE D-2
- N BLACK NURSERY D-2
- N BORDER D-2
- N HIGHWAY I70 D-2
- N INDUSTRIAL PARK RD D-2
- N MOCK D-2
- N NEAL D-2
- N OZARK D-2
- N PITTMAN D-2
- N SUMMIT D-2
- OAKLAND CT D-2
- OLD APPLE HILL D-2
- OMAHA DR D-2
- ORPHA D-2
- PALM D-2
- PARKER D-2
- PARKER BEND D-2
- PICKETT RIDGE D-2
- PIN OAK LN D-2
- PRAIRIE OAKS DR D-2
- RAVENWOOD D-2
- RAZORBACK WAY D-2
- RICHARDSON D-2
- ROGERS D-2
- S BAGGETT D-2
- BORDER D-2
- ERVAN BEEKS D-2
- INDUSTRIAL PARK RD D-2
- MOCK D-2
- NEAL D-2
- OZARK D-2
- PITTMAN D-2
- SUMMIT D-2
- SADDLE D-2
- SCHOOL D-2
- SEABISCUIT DR D-2
- SEBASTIAN LN D-2
- SECRETARIAT LN D-2
- SEDGWICK DR D-2
- SHADY ACRES LN D-2
- SPRUCE D-2
- SPUR CR D-2
- STAPLETON DR D-2
- STONECREST CT D-2
- SUNDOWNER D-2
- SUNDOWNER RANCH AVE D-2
- SUNDOWNER RANCH AVE D-2
- TERPENING D-2
- TRISHA LN D-2
- TRISTON LN D-2
- VINEY GROVE RD D-2
- VINEY GROVE RD D-2
- W BUCHANAN D-2
- W BUSH D-2
- W BUSH D-2
- W BUTLER D-2
- W CLEVELAND D-2
- W DOUGLAS D-2
- W GRAHAM D-2
- W MCCORMICK D-2
- W MOCK DR D-2
- W PARKS D-2
- W THURMAN D-2
- WALLACE D-2
- WALNUT D-2
- WASHINGTON RD D-2
- WAYNE VILLINES RD D-2
- WESTWOOD AVE D-2
- WHIRLWAY LN D-2

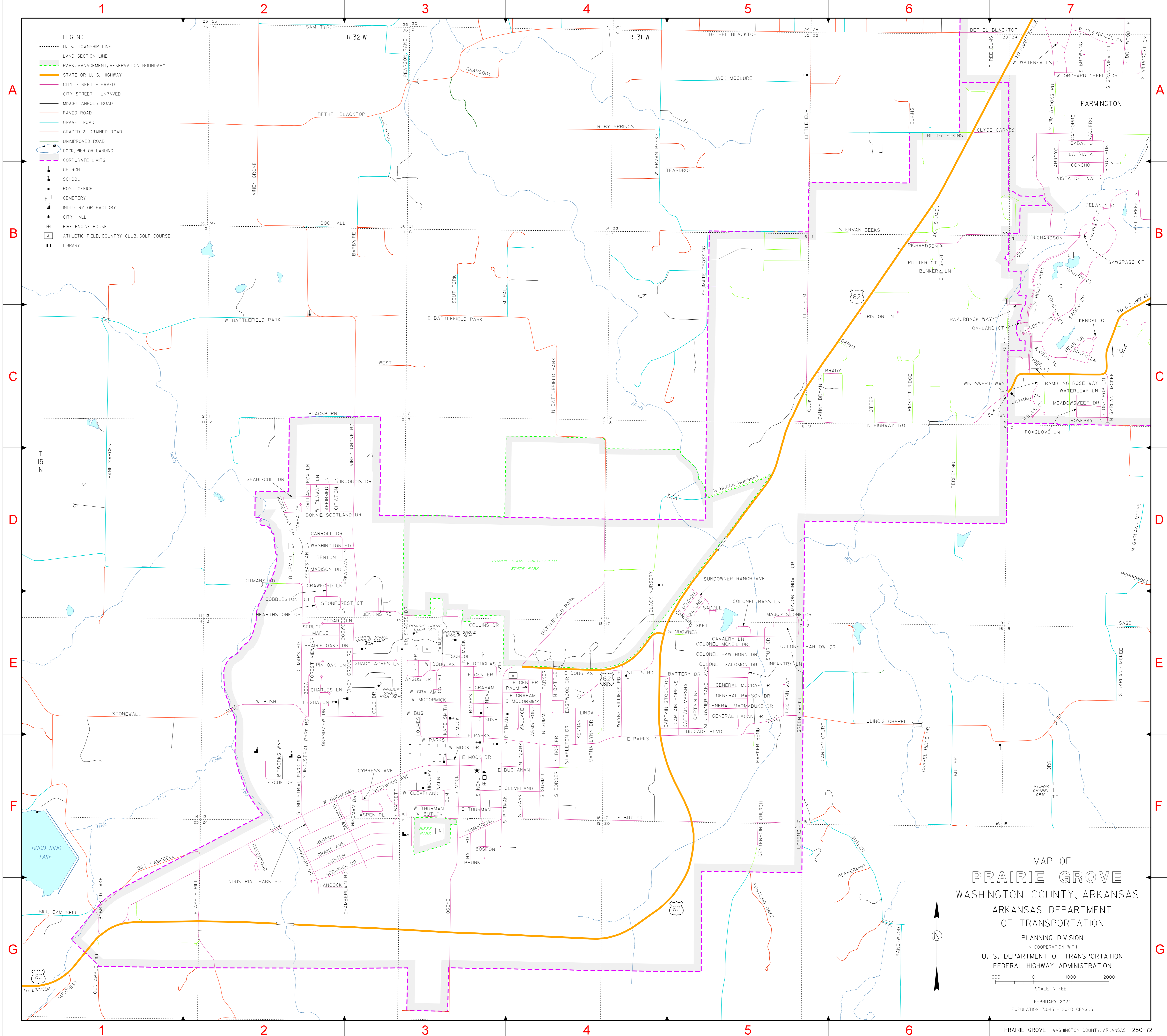

LEGEND

- U. S. TOWNSHIP LINE
- LAND SECTION LINE
- PARK, MANAGEMENT, RESERVATION BOUNDARY
- STATE OR U. S. HIGHWAY
- CITY STREET - PAVED
- CITY STREET - UNPAVED
- MISCELLANEOUS ROAD
- PAVED ROAD
- GRAVEL ROAD
- GRADED & DRAINED ROAD
- UNIMPROVED ROAD
- DOCK, PIER OR LANDING
- CORPORATE LIMITS
- CHURCH
- SCHOOL
- POST OFFICE
- CEMETERY
- INDUSTRY OR FACTORY
- CITY HALL
- FIRE ENGINE HOUSE
- ATHLETIC FIELD, COUNTRY CLUB, GOLF COURSE

MAP OF
PRAIRIE GROVE
WASHINGTON COUNTY, ARKANSAS

ARKANSAS DEPARTMENT
OF TRANSPORTATION
PLANNING DIVISION

IN COOPERATION WITH
U. S. DEPARTMENT OF TRANSPORTATION
FEDERAL HIGHWAY ADMINISTRATION

SCALE IN FEET
1000 0 1000 2000

FEBRUARY 2024
POPULATION 1,045 - 2020 CENSUS