

INDEX

- 3 RD AVE
- "A"
- AIRPORT RD
- ARNOLD
- ASH
- "B"
- BAILEY
- BEMIS
- BRYANT
- "C"
- CALE RD
- CALE RD
- CALE RD
- CEDAR
- CORNELIUS
- DALTON AVE
- DE ANN
- 2 ND N
- 3 ND S
- 3 RD N
- 3 RD S
- 4 TH N
- 4 TH S
- 5 TH N
- 5 TH S
- 6 TH N
- 6 TH S
- 7 TH N
- 7 TH S
- 8 TH S
- CHESTNUT
- F.M.
- FIRST N
- FIRST S
- HAZEL
- LAUREL
- MAIN
- OLIVE
- PINE
- ROSS
- VINE
- WALNUT
- ELIZABETH
- FAIR GROUNDS RD
- FLEMING AVE
- FRIAR TUCK
- GARLAND
- GEE
- GREENLAWN
- GULLEY
- HALE AVE
- HALE DR
- HALE LN
- HALL
- HATLEY AVE
- HAYS
- HIGHMEADOW
- HINDS BLVD
- HOLLY
- JAMES
- JONES
- JYCE
- KATHRYN
- MANOR RD
- MARR
- MARION RD
- MARTIN
- MILL
- MOCKINGBIRD LN
- MONRIEF
- MONSON
- MOORE HWY
- MOORE HWY
- MYRTLE
- NOTTINGHAM
- OAK
- OAK GROVE
- OZAN AVE
- PEARL AVE
- PECAN
- POWELL
- RIDGEWOOD RD
- ROLLING HILL
- ROSTON RD
- SCHOOL
- SCOTT
- SECTION LINE AVE
- SHERWOOD DR
- STEWART RD
- VICKS AVE
- W 2 ND
- W 2 ND N
- W 2 ND S
- W 3 RD N
- W 3 RD S
- W CHESTNUT
- W ELM
- W FIRST
- W FIRST S
- W HAZEL
- W LAUREL
- W MAIN
- W MAIN
- W OLIVE
- W PINE
- W VINE
- W WALNUT
- WARREN
- WASHINGTON RD
- WEBB
- WHITESIDE
- WILDCAT RD
- WILSON

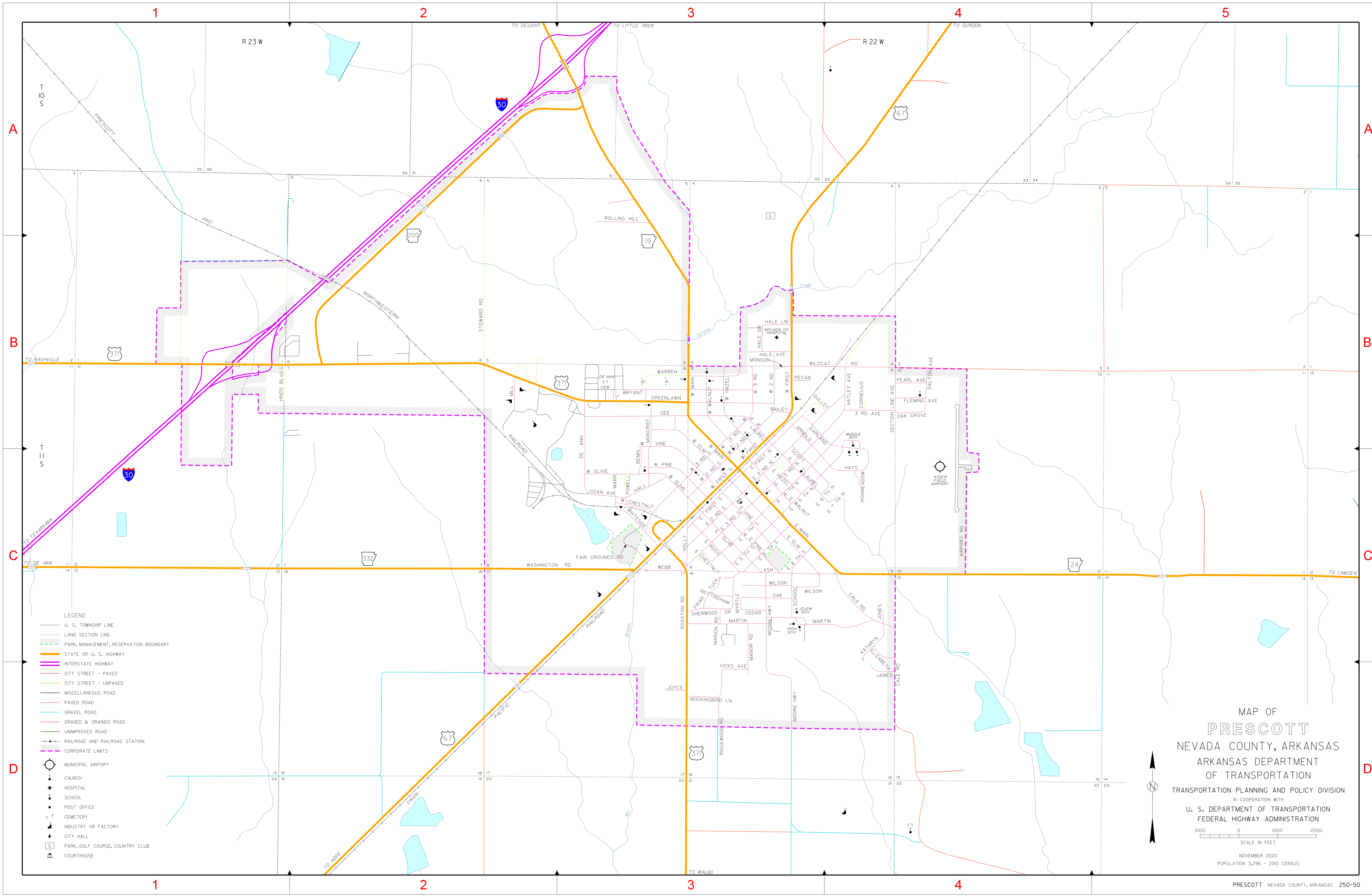

**LEGEND**

- U. S. TOWNSHIP LINE
- LAND SECTION LINE
- PARK, MANAGEMENT, RESERVATION BOUNDARY
- STATE OR U. S. HIGHWAY
- INTERSTATE HIGHWAY
- CITY STREET - PAVED
- CITY STREET - UNPAVED
- MISCELLANEOUS ROAD
- PAVED ROAD
- GRAVEL ROAD
- GRADED & DRAINED ROAD
- UNIMPROVED ROAD
- RAILROAD AND RAILROAD STATION
- CORPORATE LIMITS
- MUNICIPAL AIRPORT
- ⊕ CHURCH
- ⊕ HOSPITAL
- ⊕ SCHOOL
- ⊕ POST OFFICE
- ⊕ CEMETERY
- ⊕ INDUSTRY OR FACTORY
- ⊕ CITY HALL
- ⊕ PARK, GOLF COURSE, COUNTRY CLUB
- ⊕ COURTHOUSE

MAP OF  
**PRESCOTT**  
NEVADA COUNTY, ARKANSAS  
ARKANSAS DEPARTMENT  
OF TRANSPORTATION  
TRANSPORTATION PLANNING AND POLICY DIVISION  
IN COOPERATION WITH  
U. S. DEPARTMENT OF TRANSPORTATION  
FEDERAL HIGHWAY ADMINISTRATION

SCALE IN FEET  
1000 0 1000 2000

NOVEMBER 2020  
POPULATION 3,296 - 2010 CENSUS