

INDEX

- BIRD CREEK C-2
- BRANCH C-3
- BREWER RD B-3
- CEMETERY RD B-3
- COLE LN B-4
- E MAIN B-3
- GRIFFIN CR B-3
- MAIN B-3
- MT CARMAL RD B-3
- NURSING HOME CR B-3
- PARK B-3
- RICHARDSON CR B-3
- SHAW CEMERTERY RD C-1
- SIDNEY RD B-3
- ST PAUL B-2
- W MAIN C-2

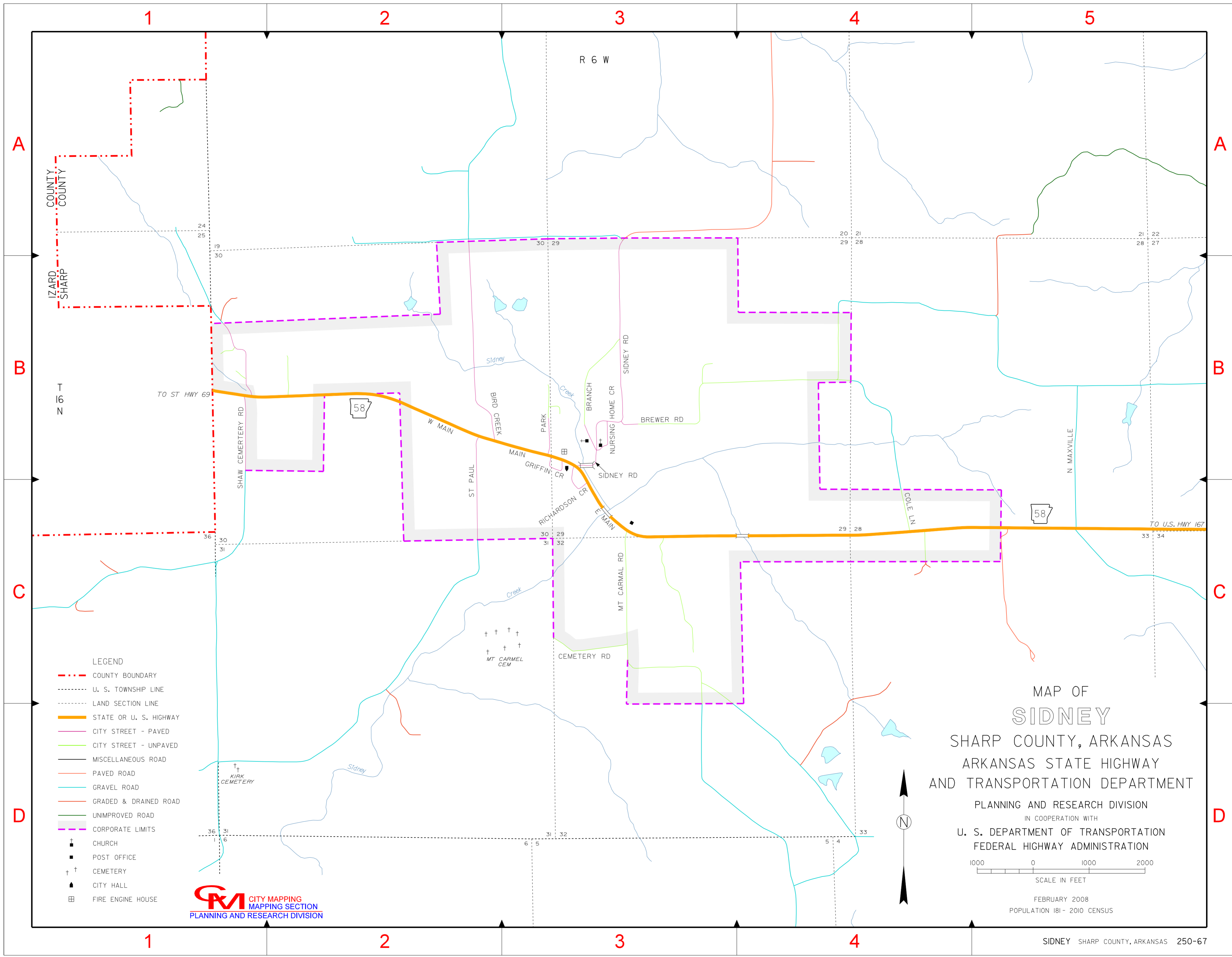

- LEGEND**
- - - COUNTY BOUNDARY
 - - - U. S. TOWNSHIP LINE
 - - - LAND SECTION LINE
 - STATE OR U. S. HIGHWAY
 - CITY STREET - PAVED
 - CITY STREET - UNPAVED
 - MISCELLANEOUS ROAD
 - PAVED ROAD
 - GRAVEL ROAD
 - GRADED & DRAINED ROAD
 - UNIMPROVED ROAD
 - - - CORPORATE LIMITS
 - † CHURCH
 - POST OFFICE
 - †† CEMETERY
 - ▲ CITY HALL
 - ⊞ FIRE ENGINE HOUSE

CM CITY MAPPING
MAPPING SECTION
PLANNING AND RESEARCH DIVISION

MAP OF
SIDNEY
SHARP COUNTY, ARKANSAS
ARKANSAS STATE HIGHWAY
AND TRANSPORTATION DEPARTMENT
PLANNING AND RESEARCH DIVISION
IN COOPERATION WITH
U. S. DEPARTMENT OF TRANSPORTATION
FEDERAL HIGHWAY ADMINISTRATION



FEBRUARY 2008
POPULATION 181 - 2010 CENSUS