

**INDEX**

1 ST AVE	B-4	NORMA JEAN DR	D-6
2 ND	B-4	OAK	C-4
3 RD	B-4	OAKDALE	C-4
ADA DR	B-4	OAKLAND AVE	C-4
ALLYCE	C-5	OAKWOOD LN	D-5
AMBREA	D-5	OLIVE	D-5
ANNE	B-5	PALM	C-5
ARROWHEAD RD	C-6	PARK AVE	C-5
ASH	B-4	PASCHAL AVE	C-5
ASHLEY DR	B-4	PATSY AVE	C-5
AUTUM PASS	C-4	PATTERSON	C-4
BALCOM LN	B-3	PAULA AVE	B-3
BALLARD CR	D-5	PAULINE	D-5
BELL	D-5	PECAN GROVE LN	C-5
BERMUDA WAY DR	C-5	PERSIMMON	C-5
BETTY	C-5	PLAZA AVE	C-5
BIBB RD	D-3	POINSETT AVE	C-5
BIRCH AVE	C-5	POPLAR AVE	C-5
BLANTON	C-5	PRIMROSE LN	C-5
BLOSSOM	D-4	RAVEN CR	C-5
BOXWOOD DR	C-6	REDWOOD AVE	C-5
BRIAN	C-6	REED AVE	C-5
BRIAN RD	C-6	RELLA DR	C-5
BROWN LN	D-3	RICHARDSON	B-3
BUTTERFIELD	C-5	ROSEWOOD DR	D-3
BUXTON AVE	C-5	S CREST AVE	D-3
BYRN LN	C-5	S CROSS AVE	D-3
CAMPBELL AVE	C-6	S MAGNOLIA DR	D-3
CASH AVE	C-5	S MELTON AVE	D-3
CASH EXTENDED AVE	C-6	S OZARK AVE	D-3
CHAFFIN RD	D-3	S PARKVIEW DR	D-3
CHARLES	B-3	S WILLow AVE	D-3
CHARLOTTE AVE	C-6	SAINT AUGUSTINE BLVD	C-4
CHERRY DR	C-4	SAVANNAH WAY DR	C-4
CHRISTY AVE	B-4	SAWYER LN	C-4
CHRISTY AVE	C-5	SEATON	C-5
CHURCH	C-6	SHORT	C-6
CIRCLE DR	C-6	SIDNEY AVE	B-5
CLIFTON DR	D-6	SMITH AVE	D-6
CLOVER	B-5	SMITH AVE	B-5
COLLINS LOOP A RD	D-3	SPRUCE DR	D-3
COLLINS LOOP B RD	D-3	STEVENS LANDING RD	D-3
CONASTER RD	D-3	SUMAC	D-3
COUNTRY CLUB BLVD	D-7	SUMMER BLVD	D-7
COUNTRY CLUB TER	D-6	SUNSET DR	D-6
CRIS LN	C-4	SWANEY AVE	C-4
CYPRESS DR	D-4	SYCAMORE	D-4
DAVIS	D-5	TEMPLE	D-5
DAVIS	D-5	THELMA	D-5
DELTA	D-5	THOMAS	D-5
DEPOD CR	D-5	THORN RD	D-5
DIAMOND AVE	C-5	TOM LN	C-5
DIANE DR	C-4	TUPELO	C-4
DOGWOOD DR	C-4	TWIN HICKORY LN	C-4
DOUGLAS	D-5	VINE	D-5
DWIGHT	B-4	VIRGINIA AVE	B-4
E CARLSON	C-5	VIVA DR	C-5
E MAIN	C-5	W CARLSON	C-5
E SPEEDWAY	C-6	W MAIN	C-6
EAGLE CREST DR	C-5	W SPEEDWAY	C-5
EASTSIDE GARDENS DR	C-5	WAYNE	C-5
EASY	C-5	WESTWOOD DR	C-5
EDGERTON AVE	B-5	WHITLATCH AVE	B-5
ELLIS AVE	B-5	WHITNEY CV	B-5
ELM AVE	B-5	WILDFLOWER	B-5
ELSTER CR	B-4	WILLOW LN	B-4
FIRE STATION RD	B-4	WILLOW RD	B-4
FLOSSIE	C-5	WINDFIELD CR	C-5
FORREST AVE	C-6	WOODFIELD CV	C-6
FOX RUN	C-5	WOODLAND CR	C-5
GLASGOW LN	C-5		
GUM AVE	C-5		
GUYS PASS RD	C-4		
HARLAN	C-4		
HARMONY CV	C-4		
HARRISON	C-4		
HATTIE	C-4		
HOBART AVE	C-4		
HOLLY AVE	C-4		
HONEYSUCKLE LN	B-5		
HURD AVE	B-5		
INDUSTRIAL PARK RD	C-4		
JADE LN	C-4		
JAMES LN	C-4		
JAMES PAUL LN	C-3		
JENNIFER	C-5		
KATHRYN	C-5		
L M PLACE RD	C-4		
LARKSPUR LN	C-4		
LAVETTE	C-4		
LESTER RD	C-4		
LEWIS AVE	C-4		
LOCUST AVE	C-4		
LOUISE	C-4		
LUNSFORD	C-4		
MALLARD CV	C-5		
MAPLE	C-5		
MAPLE GROVE LN	C-5		
MARCUS DR	C-4		
MARSHALL LN	C-4		
MELODY DR	C-4		
MELROSE DR	C-4		
MILDRED AVE	C-4		
MILDRED EXTENDED AVE	C-5		
MONROE AVE	C-5		
MULBERRY DR	C-4		
N CREST AVE	C-4		
N CROSS AVE	C-4		
N MAGNOLIA DR	C-4		
N MELTON AVE	C-4		
N OZARK AVE	C-4		
N PARKVIEW DR	C-4		
N PINE AVE	C-4		
N WILLOW AVE	C-4		
NANCY	C-4		

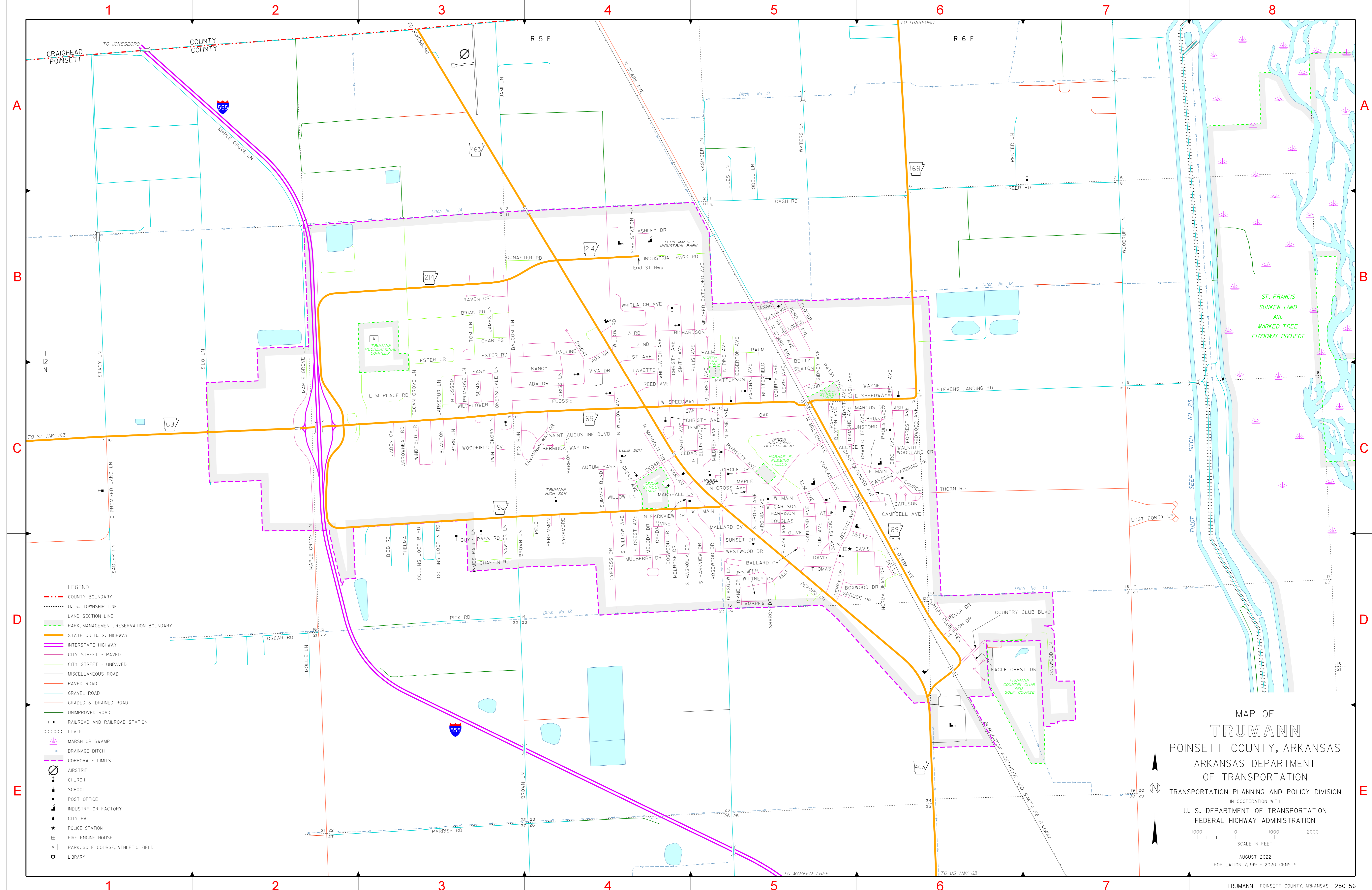

**LEGEND**

- COUNTY BOUNDARY
- U. S. TOWNSHIP LINE
- LAND SECTION LINE
- PARK, MANAGEMENT, RESERVATION BOUNDARY
- STATE OR U. S. HIGHWAY
- INTERSTATE HIGHWAY
- CITY STREET - PAVED
- CITY STREET - UNPAVED
- MISCELLANEOUS ROAD
- PAVED ROAD
- GRAVEL ROAD
- GRADED & DRAINED ROAD
- UNIMPROVED ROAD
- RAILROAD AND RAILROAD STATION
- LEVEE
- MARSH OR SWAMP
- DRAINAGE DITCH
- CORPORATE LIMITS
- AIRSTRIP
- CHURCH
- SCHOOL
- POST OFFICE
- INDUSTRY OR FACTORY
- CITY HALL
- POLICE STATION
- FIRE ENGINE HOUSE
- PARK, GOLF COURSE, ATHLETIC FIELD
- LIBRARY

**MAP OF TRUMANN**  
**POINSETT COUNTY, ARKANSAS**  
 ARKANSAS DEPARTMENT OF TRANSPORTATION  
 OF TRANSPORTATION  
 TRANSPORTATION PLANNING AND POLICY DIVISION  
 IN COOPERATION WITH  
 U. S. DEPARTMENT OF TRANSPORTATION  
 FEDERAL HIGHWAY ADMINISTRATION

SCALE IN FEET  
 0 1000 2000

AUGUST 2022  
 POPULATION 7,399 - 2020 CENSUS