

DESIGN SPEED V	Y	NOSE OFFSET C	LENGTH NOSE TAPER Z	RETURN RADIUS R	ADD'L. SURFACING
km/hr	m	m	m	m	sq. m
60	90.0	2.40	28.8	174.0	506.04
80	96.0	3.00	36.0	217.5	577.32
100	102.0	3.60	50.4	354.6	664.06
110	108.0	4.20	63.0	474.6	757.91

NOTE: ON GRADES IN EXCESS OF 4%, THE LENGTHS "Y" & "Z" MAY BE VARIED TO FIT THE CASE IN THE RATION OF  $\frac{1.3}{2 \text{ GRADE}}$  (LENGTH AS SHOWN).

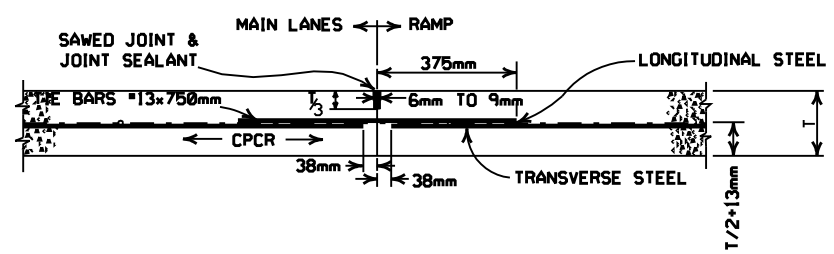

LONGITUDINAL CONSTRUCTION JOINT SECTION A - A

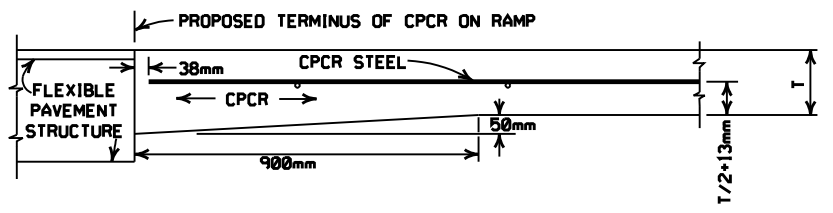

DETAIL FOR JUNCTION WITH FLEXIBLE TYPE PAVEMENT STRUCTURE

GENERAL NOTES

THE SEQUENCE OF OPERATION IN PLACING THE RAMP SHALL BE AS DIRECTED BY THE ENGINEER. THE LONGITUDINAL STEEL SHALL BE PLACED IN A DIRECTION APPROXIMATELY PARALLEL TO THE DIRECTION OF THE RAMP.

SAWED JOINT AND JOINT SEALANT FOR LONGITUDINAL CONSTRUCTION JOINT SHALL CONFORM TO THE DETAILS SHOWN FOR SAWED LONGITUDINAL JOINT ON STANDARD DRAWING CPTJ-6A(M).

ARKANSAS STATE HIGHWAY COMMISSION

DETAILS OF ENTRANCE & EXIT RAMP FOR CONCRETE PAVEMENT CONTINUOUSLY REINFORCED

STANDARD DRAWING CPCR-4(M) METRIC

4-3-87	REVISED STEEL BARS TO SOFT METRIC
7-20-95	CONVERTED TO METRIC
DATE	REVISION